



THE CITY OF SAN DIEGO

REPORT TO THE PLANNING COMMISSION

DATE ISSUED: September 4, 2009 **REPORT NO.** PC-09-073

ATTENTION: Planning Commission, Agenda of September 10, 2009

SUBJECT: **OLD ROSE CANYON SEWER RELOCATION**
PROJECT NO. 182124. PROCESS 4

**OWNER/
APPLICANT:** City of San Diego, Engineering and Capital Projects Department

SUMMARY

Issues: Should the Planning Commission approve a Site Development Permit to abandon approximately 3,000 linear feet of sewer line and seven manholes; construct two new manholes and a permanent access road to one of the manholes; and a new 24-inch sewer line within Lower Rose Canyon to Santa Fe Street? The project is located within the Clairemont Mesa Community Plan area.

Staff Recommendation: **APPROVE** Site Development Permit No. 678733.

Community Planning Group Recommendation: The Clairemont Mesa Community Planning Group did not take an action on the project.

Environmental Review: The project activity is exempt from the California Environmental Quality Act (CEQA) pursuant to State CEQA Guidelines Section 15282(k). This project is not pending an appeal of the environmental determination (Attachment 6). The environmental exemption determination for this project was made on July 24, 2009, and the opportunity to appeal that determination ended August 7, 2009.

Fiscal Impact Statement: The project is being funded by the Metropolitan Wastewater Department's (MWWD) Annual Allocation MWWD Trunk Sewer Fund 41506.

Code Enforcement Impact: None.

Housing Impact Statement: None.

BACKGROUND

The proposed project is located in Lower Rose Canyon, northeast of Mission Bay and more specifically south of the Santa Fe Street bridge crossing and north of Damon Street (Attachments 1 and 3). The site contains environmentally sensitive lands (ESL) in the form of sensitive biological resources and wetlands. No portions of the project are within the Multi-Habitat Planning Area (MHPA). The project site is approximately 2.5 miles east of the Pacific Ocean and 3.5 miles north of the San Diego River. The site is designated in the Clairemont Mesa Community Plan as Industrial Park (Attachment 2). The site is zoned IP-2-1 (Industrial Park).

DISCUSSION

Project Description:

The Old Rose Canyon Sewer Relocation project includes dismantling, debris removal, and capping of seven existing manholes south of the Santa Fe Street bridge crossing, the construction of two new manholes, a new 24-inch sewer line leading from the two new manholes to Santa Fe Street, and a new permanent access road to one of the two new manholes (Attachment 7). Relocation of the sewer line will result in the abandonment of approximately 3,000 linear feet of sewer line and seven manholes within Lower Rose Canyon, and this will eliminate the need for maintenance and associated disturbances to environmentally sensitive lands (ESL).

Discretionary Action:

Although the project contains ESL and would impact less than 0.01 acre of wetland area, staff has determined it can be exempt from CEQA (Attachment 6). However, according to San Diego Municipal Code Section 143.0141(b), any impacts to wetlands must be avoided. Since impacts to wetlands would occur, a Site Development Permit (SDP) for a deviation to ESL is required.

General and Community Plan Conformance:

The Public Facilities, Services and Safety Element of the General Plan includes policy language which supports maintenance of the City's water and sewer systems. The project would also implement the City Council Policies for the Management of Sewer Facilities Located in Canyons and other Environmentally Sensitive Lands (400-13 and 400-14). Additionally, the project is consistent with the Community Plan. The Clairemont Mesa Community Plan states that water and sewer facilities should be maintained to adequately serve the community.

Environmentally Sensitive Land Analysis:

Construction of two new manholes and a 24-inch sewer line within Lower Rose Canyon will result in temporary impacts to 525-square feet of southern willow scrub; 49-square feet of mule fat scrub; and 1,965-square feet of non-native grasslands. Installation of the two new manholes will result in permanent impacts to southern willow shrub and non-native grasses.

Temporary impacts will also result from access into Lower Rose Canyon for the abandonment of seven existing manholes, including impacts to 95-square feet of coastal and valley freshwater marsh; 1,202-square feet of southern willow scrub; 250-square feet of mule fat scrub; and 1,945-square feet of non-native grasslands. Habitats within the temporary access road areas will be restored to their original condition or better, and a trash removal and weed control program will be implemented within the impacted areas for a period of 25 months following construction. Native hydro-seeding, willow stakes, and or container plantings may be used to control soil erosion potential. After construction is completed the abandoned access road will be decomposed to facilitate the reestablishment of native vegetation. Mitigation for project impacts to coastal and valley freshwater marsh, southern willow scrub, and mule fat scrub will be mitigated at a ratio of 2:1.

Conclusion:

Implementation of the proposed project would abandon approximately 3,000 linear feet of sewer line and seven manholes in Lower Rose Canyon replacing them with two new manholes and 24-inch sewer line which will eliminate the need for future maintenance and associated disturbances to environmentally sensitive lands within Lower Rose Canyon. Therefore, staff believes that the findings for Site Development Permit No. 678733 (Attachment 4) can be made and recommends that the Planning Commission approve the project.

ALTERNATIVES

1. **Approve** Site Development Permit No. 678733, with modifications.
2. **Deny** Site Development Permit No. 678733, if the findings required to approve the project cannot be affirmed.

Respectfully submitted,



Mike Westlake
Program Manager
Development Services Department



Patricia Grabski
Project Manager
Development Services Department

KGB/PXG

Attachments:

1. Aerial Photograph
2. Community Plan Land Use Map
3. Project Location Map
4. Draft Permit Resolution with Findings
5. Draft Permit with Conditions
6. Environmental Exemption
7. Project Site Plans

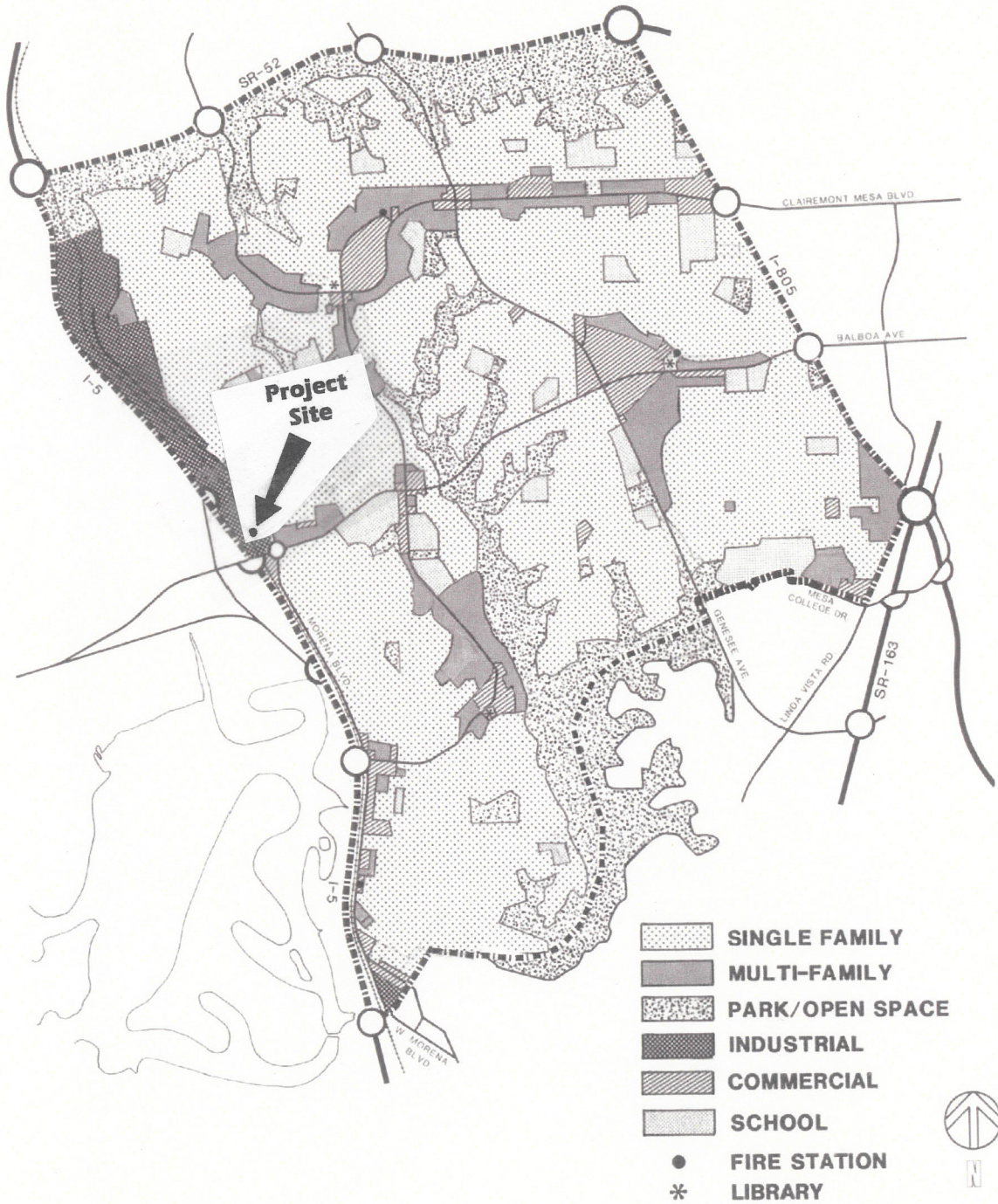

Image source: Copyright City of Phoenix. All Rights Reserved (Down January 2008)

- Old Rose Canyon Sewer Relocation Project
- Existing Sewer Manholes
- Photo Point Locations
- Photo Direction



Site Photos with Key Map



Community Plan Map
Clairemont Mesa Community Plan

Map Source: City of San Diego, Engineering and Development Department, City 800' Maps

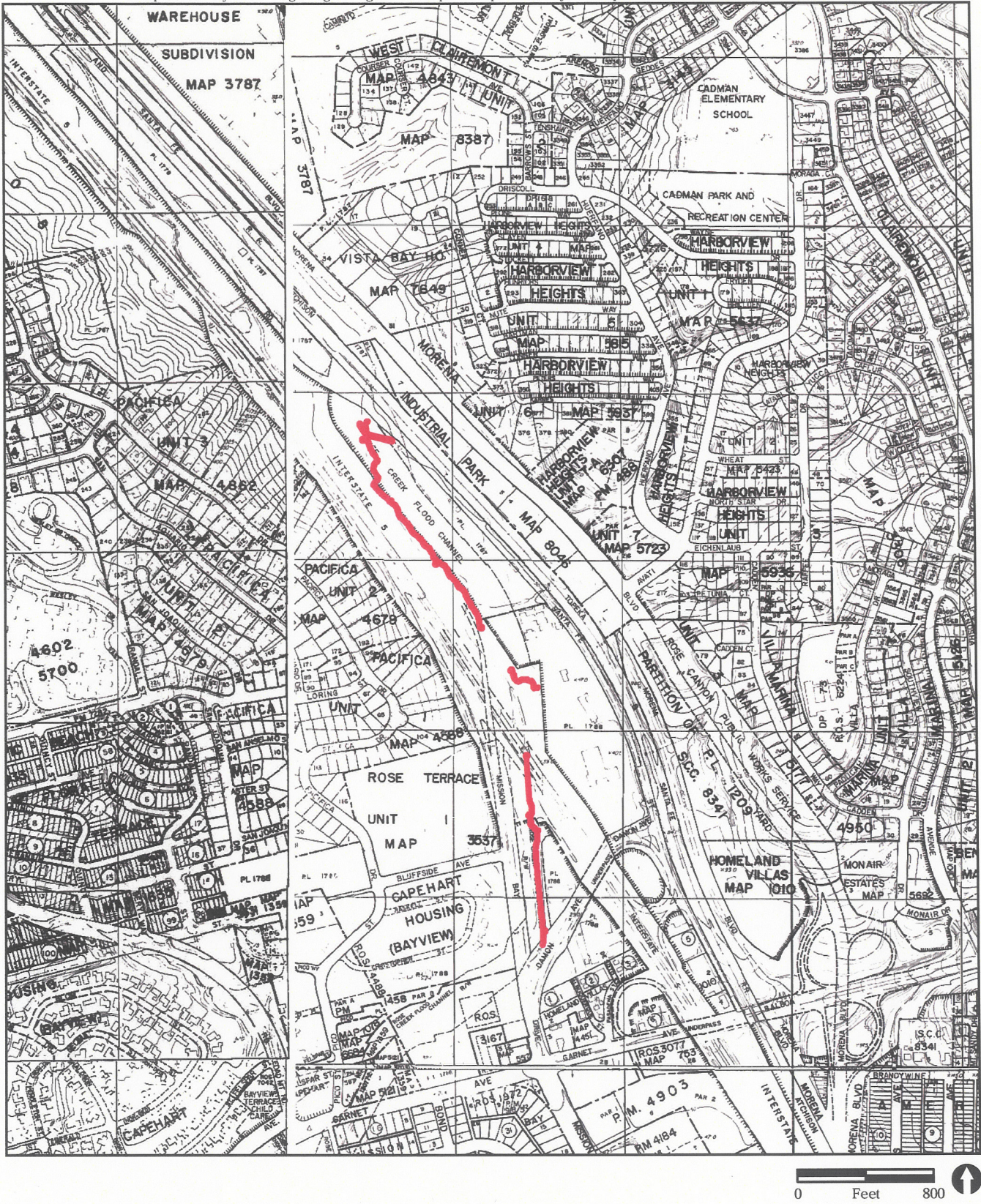

— Project Location

FIGURE 3
Old Rose Canyon Sewer Relocation
Project Location on City 800' Map

PLANNING COMMISSION RESOLUTION NO.
SITE DEVELOPMENT PERMIT APPROVAL NO. 678733
**OLD ROSE CANYON SEWER RELOCATION
PROJECT NO. 182124**

WHEREAS, THE CITY OF SAN DIEGO ENGINEERING AND CAPITAL PROECTS DEPARTMENT, Owner/Permittee, filed an application with the City of San Diego for a permit to abandon approximately 3,000 linear feet of sewer line and seven manholes within Lower Rose Canyon; construction of two new manholes and a new 24-inch sewer line leading from the new two new manholes to Santa Fe Street and a new permanent access road to one of the two new manholes in Lower Rose Canyon (as described in and by reference to the approved Exhibits "A" and corresponding conditions of approval for the associated Permit No. 678733);

WHEREAS, the project site is located at portion of Lower Rose Canyon, northeast of Mission Bay and south of the Santa Fe Street bridge crossing and north of Damon Street to the Santa Fe Street Right-of-Way in the IP-2-1 zone (Industrial Park) in the Clairemont Mesa Community Plan area;

WHEREAS, on September 10, 2009, the Planning Commission of the City of San Diego considered Site Development Permit No. 678733 pursuant to the Land Development Code of the City of San Diego;

WHEREAS, on July 24, 2009, the City of San Diego, as Lead Agency, through the Development Services Department, made and issued an Environmental Determination that the project is exempt from the California Environmental Quality Act (CEQA) (Public Resources Code section 21000 et. seq.) under CEQA Guideline Section 15282(k); and there was no appeal of the Environmental Determination filed within the time period provided by San Diego Municipal Code Section 112.0520.

BE IT RESOLVED by the Planning Commission of the City of San Diego as follows:

That the Planning Commission adopts the following written Findings, dated September 10, 2009.

FINDINGS:

Site Development Permit - Section 126.0504

A. Findings for all Site Development Permits

1. The proposed development will not adversely affect the applicable land use plan;

The proposed project is located in Lower Rose Canyon, northeast of Mission Bay, south of the Santa Fe Street bridge crossing and north of Damon Street. The proposed project is for the construction of two new manholes, a new 24-inch sewer line leading from the two new manholes to Santa Fe Street, and a new permanent access road to one of the two new manholes. Relocation of sewer line will result in the abandonment of approximately 3,000 linear feet of sewer line and seven manholes with Lower Rose Canyon this will eliminate the need for maintenance and associated disturbances to environmentally sensitive lands. The subject site is designated as Industrial Park in the Clairemont Mesa Community Plan. The plan recommends that existing

sewer facilities be removed from canyons whenever feasible in accordance with Council Policy 400-14. Therefore, the proposed development will not adversely affect the applicable land use plan.

2. The proposed development will not be detrimental to the public health, safety, and welfare; and

The proposed development will not be detrimental to the public health, safety, and welfare because the project proposes to abandon and relocate an aging sewer line to prevent future sewage spills and impacts on water quality. Traffic control plans will be provided by the contractor to ensure the safety of the residents and pedestrians during each phase of construction.

3. The proposed development will comply with the applicable regulations of the Land Development Code.

The project as proposed will comply with all applicable regulations of the Land Development Code except for deviations to the regulations for a Site Development Permit to impact sensitive resources. While the project has minimized impacts to sensitive resources, to the greatest extent possible, minor impacts to non- native grass areas along the access entrance from Santa Fe Road and wetland vegetation for the construction of one of the two new manholes will occur.

B. Supplemental Findings--Environmentally Sensitive Lands

1. The site is physically suitable for the design and siting of the proposed development and the development will result in minimum disturbance to environmentally sensitive lands;

All construction and staging activities will occur, to the greatest extend possible, within existing access paths and disturbed areas. The contractor will use canyon proficient vehicles (CPV) with rubberized tires to minimize impacts. Existing native vegetation will be trimmed where root structures can be left in place. The Least Bell's Vireo nesting season will be avoided to minimize potential impacts. All areas of disturbance will be revegetated and re-contoured to their original condition, and any excess spoil will be removed off-site and disposed of in accordance with applicable regulations. Therefore, the development would result in minimum disturbance to environmentally sensitive lands.

2. The proposed development will minimize the alteration of natural land forms and will not result in undue risk from geologic and erosional forces, flood hazards, or fire hazards;

Grading will be limited to two pits for the construction of two new manholes and trenching for the pipeline redirection. All areas of disturbance will be revegetated and re-contoured to their original condition, and any excess spoil will be removed off-site and disposed of in accordance with applicable regulations. Therefore, no land form alterations are anticipated with this development. Additionally, due to the minimal excavations and remediation of the site, the project would not increase or result in undue risk from geologic and erosional forces, flood hazards, or fire hazards.

3. The proposed development will be sited and designed to prevent adverse impacts on any adjacent environmentally sensitive lands;

The nature of this project is to remove an existing pipeline out of the canyon and relocate it within the Santa Fe Road right-of-way to protect the sensitive resources within the canyon. This project will eliminate the need for future impacts to Rose Canyon for maintenance or repair activities.

4. The proposed development will be consistent with the City of San Diego's Multiple Species Conservation Program (MSCP) Subarea Plan;

By removing the sewer facility from the canyon, the project will improve the quality of the habitat within this portion of Rose Canyon providing a greater linkage to the MHPA areas nearby. Therefore, the proposed development will be consistent with the City of San Diego's Multiple Species Conservation Program (MSCP) Sub-Area Plan.

5. The proposed development will not contribute to the erosion of public beaches or adversely impact local shoreline sand supply; and

The project site is approximately 2.5 miles east of the Pacific Ocean and not near any public beaches or local shoreline. However, Best Management Practices (BPM's) will be implemented to minimize erosion and runoff, therefore, the project would not contribute to the erosion of public beaches nor have any adverse impact on the local shoreline sand supply.

6. The nature and extent of mitigation required as a condition of the permit is reasonably related to, and calculated to alleviate, negative impacts created by the proposed development.

Mitigation will be provided to alleviate any negative impacts created by the project. All impacts have been included in the Biological Technical Letter Report dated June 22, 2009, and addressed in the recommendations of the report. The project will implement the recommendations of the report to avoid and limit impacts to environmentally sensitive lands.

C. Supplemental Findings--Environmentally Sensitive Lands Deviations

1. There are no feasible measures that can further minimize the potential adverse effects on environmentally sensitive lands; and

Currently, Old Rose Canyon Trunk Sewer runs through Lower Rose Canyon west of Santa Fe Road. The project would relocate the trunk sewer from the canyon to the street in accordance with Council Policy (CP) 400-14. CP 400-14 recommends that existing sewer facilities be removed from canyons and other Environmentally Sensitive Lands (ESL) whenever feasible to eliminate the disturbance to the sensitive ecosystems contained within these resources. A majority of the new sewer line will be located within the Santa Fe Road public right-of-way between the Santa Fe Road Bridge and Damon Street to the south, however, a small portion of will need to occur within the canyon, south of the Santa Fe Road Bridge, to tie into the existing sewer and provide a redirection point. Manholes are required at all bends in the sewer line. In order to redirect the

sewer line to Santa Fe Road, two manholes will be required; one at the tie in point and one to turn the pipeline towards Santa Fe Road. The alignment of these two manholes was designed to be located within the least sensitive portion of the site possible. Due to the design constraints of the proposed sewer line there are no other feasible measures that can further minimize the potential adverse effects on environmentally sensitive lands.

2. The proposed deviation is the minimum necessary to afford relief from special circumstances or conditions of the land, not of the applicant's making.

Currently, Old Rose Canyon Trunk Sewer runs through Lower Rose Canyon west of Santa Fe Road. The project would relocate the trunk sewer from the canyon to the street in accordance with Council Policy (CP) 400-14. CP 400-14 recommends that existing sewer facilities be removed from canyons and other Environmentally Sensitive Lands (ESL) whenever feasible to eliminate the disturbance to the sensitive ecosystems contained within these resources. While, the majority of the new sewer line will be located within the Santa Fe Road public right-of-way between the Santa Fe Road Bridge and Damon Street to the south, a small portion of will need to occur within the canyon south of the Santa Fe Road Bridge to tie into the existing sewer and provide a redirection point. Manholes are required at all bends in the sewer line. In order to redirect the sewer line to Santa Fe Road, two manholes will be required; one at the tie in point and one to turn the pipeline towards Santa Fe Road. The alignment of these two manholes was designed to be located within the least sensitive portion of the site possible. Therefore, the proposed deviations are the minimum necessary to afford relief from special circumstances or conditions of the land, not of the applicant's making.

BE IT FURTHER RESOLVED that, based on the findings hereinbefore adopted by the Planning Commission Site Development Permit No. 678733 is hereby GRANTED by the Planning Commission to the referenced Owner/Permittee, in the form, exhibits, terms and conditions as set forth in Permit No. 678733, a copy of which is attached hereto and made a part hereof.

Patricia Grabski
Development Project Manager
Development Services

Adopted on: September 10, 2009

Job Order No. 141261

RECORDING REQUESTED BY
CITY OF SAN DIEGO
DEVELOPMENT SERVICES
PERMIT INTAKE, MAIL STATION 501

WHEN RECORDED MAIL TO
PROJECT MANAGEMENT
PERMIT CLERK
MAIL STATION 501

SPACE ABOVE THIS LINE FOR RECORDER'S USE

JOB ORDER NUMBER: 141261

SITE DEVELOPMENT PERMIT NO. 678733
OLD ROSE CANYON SEWER RELOCATION
PROJECT NO. 182124
PLANNING COMMISSION

This Site Development Permit (SDP) No. 678733 is granted by the Planning Commission of the City of San Diego to the CITY OF SAN DIEGO ENGINEERING AND CAPITAL PROJECTS DEPARTMENT, Owner/Permittee pursuant to San Diego Municipal Code [SDMC] section 126.0504. The site is located within a portion of Lower Rose Canyon, northeast of Mission Bay and south of the Santa Fe Street bridge crossing and north of Damon Street to the Santa Fe Road Right-of-Way (ROW). The site is zoned IP-2-1 (Industrial Park) and is within the Clairemont Mesa Community Plan area.

Subject to the terms and conditions set forth in this Permit, permission is granted to Owner/Permittee to abandon approximately 3,000 linear feet of sewer line and seven manholes within Lower Rose Canyon; construction of two new manholes and a new 24-inch sewer line leading from the two new manholes to Santa Fe Street and a new permanent access road to one of the two new manholes in Lower Rose Canyon, described and identified by size, dimension, quantity, type, and location on the approved exhibits [Exhibit "A"] dated September 10, 2009, on file in the Development Services Department.

The project shall include:

- a. Abandonment of approximately 3,000 linear feet of sewer line and seven manholes within Lower Rose Canyon;
- b. Deviations to impact wetlands and environmentally sensitive lands to construct two new manholes and a new 24-inch sewer line within Lower Rose Canyon;

- c. Construction of a permanent access road to one of the two new manholes in Lower Rose Canyon.
- d. Restoration shall be performed in accordance with Exhibit "A" and the Biological Technical Letter Report dated June 22, 2009.
- e. After construction is completed the abandoned access road will be decomposed to facilitate the reestablishment of native vegetation;
- f. Accessory improvements determined by the Development Services Department to be consistent with the land use and development standards in effect for this site per the adopted community plan, California Environmental Quality Act Guidelines, public and private improvement requirements of the City Engineer, the underlying zone(s), conditions of this Permit, and any other applicable regulations of the SDMC in effect for this site.

STANDARD REQUIREMENTS:

1. This permit must be utilized within thirty-six (36) months after the date on which all rights of appeal have expired. Failure to utilize and maintain utilization of this permit as described in the SDMC will automatically void the permit unless an Extension of Time has been granted. Any such Extension of Time must meet all SDMC requirements and applicable guidelines in affect at the time the extension is considered by the appropriate decision maker.
2. No permit for the construction, occupancy or operation of any facility or improvement described herein shall be granted, nor shall any activity authorized by this Permit be conducted on the premises until:
 - a. The Owner/Permittee signs and returns the Permit to the Development Services Department; and
 - b. The Permit is recorded in the Office of the San Diego County Recorder.
3. Unless this Permit has been revoked by the City of San Diego the property included by reference within this Permit shall be used only for the purposes and under the terms and conditions set forth in this Permit unless otherwise authorized by the Development Services Department.
4. This Permit is a covenant running with the subject property and shall be binding upon the Owner/Permittee and any successor or successors, and the interests of any successor shall be subject to each and every condition set out in this Permit and all referenced documents.
5. The continued use of this Permit shall be subject to the regulations of this and any other applicable governmental agency.
6. Issuance of this Permit by the City of San Diego does not authorize the Owner/Permittee for this permit to violate any Federal, State or City laws, ordinances, regulations or policies

including, but not limited to, the Endangered Species Act of 1973 [ESA] and any amendments thereto (16 U.S.C. § 1531 et seq.).

7. Construction plans shall be in substantial conformity to Exhibit "A." No changes, modifications or alterations shall be made unless appropriate application(s) or amendment(s) to this Permit have been granted.

8. All of the conditions contained in this Permit have been considered and have been determined to be necessary in order to make the findings required for this Permit. It is the intent of the City that the holder of this Permit be required to comply with each and every condition in order to be afforded the special rights which the holder of the Permit is entitled as a result of obtaining this Permit.

In the event that any condition of this Permit, on a legal challenge by the Owner/Permittee of this Permit, is found or held by a court of competent jurisdiction to be invalid, unenforceable, or unreasonable, this Permit shall be void. However, in such an event, the Owner/Permittee shall have the right, by paying applicable processing fees, to bring a request for a new permit without the "invalid" condition(s) back to the discretionary body which approved the Permit for a determination by that body as to whether all of the findings necessary for the issuance of the proposed permit can still be made in the absence of the "invalid" condition(s). Such hearing shall be a hearing de novo and the discretionary body shall have the absolute right to approve, disapprove, or modify the proposed permit and the condition(s) contained therein.

9. The Owner/Permittee shall defend, indemnify, and hold harmless the City, its agents, officers, and employees from any and all claims, actions, proceedings, damages, judgments, or costs, including attorney's fees, against the City or its agents, officers, or employees, relating to the issuance of this permit including, but not limited to, any action to attack, set aside, void, challenge, or annul this development approval and any environmental document or decision. The City will promptly notify Owner/Permittee of any claim, action, or proceeding and, if the City should fail to cooperate fully in the defense, the Owner/Permittee shall not thereafter be responsible to defend, indemnify, and hold harmless the City or its agents, officers, and employees. The City may elect to conduct its own defense, participate in its own defense, or obtain independent legal counsel in defense of any claim related to this indemnification. In the event of such election, Owner/Permittee shall pay all of the costs related thereto, including without limitation reasonable attorney's fees and costs. In the event of a disagreement between the City and Owner/Permittee regarding litigation issues, the City shall have the authority to control the litigation and make litigation related decisions, including, but not limited to, settlement or other disposition of the matter. However, the Owner/Permittee shall not be required to pay or perform any settlement unless such settlement is approved by Owner/Permittee.

INFORMATION ONLY:

- Any party on whom fees, dedications, reservations, or other exactions have been imposed as conditions of approval of this development permit, may protest the imposition within ninety days of the approval of this development permit by filing a written protest with the City Clerk pursuant to California Government Code §66020.

- This development may be subject to impact fees at the time of construction permit issuance.

APPROVED by the Planning Commission of the City of San Diego on September 10, 2009
[date and resolution number] .

DETERMINATION OF
ENVIRONMENTAL EXEMPTION

Pursuant to the California Environmental Quality Act (CEQA) and State CEQA Guidelines

Agency: CITY OF SAN DIEGO

Project No.: 182124

Date: 7/24/09

Action/Permit(s): Approval of a Site Development Permit for deviations to the Environmentally Sensitive Lands regulations

Description of Activity: This project proposes to relocate 3000 LF of Old Rose Canyon Trunk Sewer from Lower Rose Canyon to the Santa Fe Road Right-of-Way. The redirection includes two new manholes and a new pipeline segment within the ROW. The existing line will be abandoned eliminating future access need within Rose Creek for maintenance and emergency repairs. The project would not result in impacts to buried archaeological resources and impacts to sensitive vegetation will be avoided and/or minimized by using canyon proficient vehicles with rubberized tires or by trimming woody riparian shrubs (*Salix lasiolepis* and *Baccharis salicifolia*) and not affecting the roots. Hydroseed will be applied where deemed necessary for erosion control. Resource Agency permits and mitigation for trimming riparian vegetation will be obtained/provided by the applicant department. No future access to the abandoned area will be required once the new construction is complete.

Location of Activity: Lower Rose Canyon south of the Santa Fe Road bridge crossing and North of Damon Street within the Clairemont Mesa Community Planning Area, City and County of San Diego.

(CHECK BOXES BELOW)

1. This activity is **EXEMPT FROM CEQA** pursuant to:
- Section 15060 (c)(3) of the State CEQA Guidelines (the activity is not a project as defined in Section 15378)
- Section 15061 (b)(3) of the State CEQA Guidelines (General Rule)
2. This project is **EXEMPT FROM CEQA** pursuant to State CEQA Guidelines Section checked below:

**ARTICLE 19 of GUIDELINES
CATEGORICAL EXEMPTIONS**
(Incomplete list)

Section	Short Name
<input type="checkbox"/> 15301	Existing Facilities
<input type="checkbox"/> 15302	Replacement or Reconstruction
<input type="checkbox"/> 15303	New Construction or Conversion of Small Structures
<input type="checkbox"/> 15304	Minor Alterations to Land
<input type="checkbox"/> 15305	Minor Alteration in Land Use
<input type="checkbox"/> 15306	Information Collection
<input type="checkbox"/> 15311	Accessory Structures
<input type="checkbox"/> 15312	Surplus Government Property Sales
<input type="checkbox"/> 15315	Minor Land Divisions
<input type="checkbox"/> 15317	Open Space Contracts or Easements
<input type="checkbox"/> 15319	Annexation of Existing Facilities and Lots for Exempt Facilities
<input type="checkbox"/> 15325	Transfer of Ownership of Interest in Land to Preserve Open Space
<input type="checkbox"/> Other	_____

**ARTICLE 18 of GUIDELINES
STATUTORY EXEMPTIONS**
(Incomplete list)

Section	Short Name
<input type="checkbox"/> 15261	Ongoing Project
<input type="checkbox"/> 15262	Feasibility and Planning Studies
<input type="checkbox"/> 15265	Adoption of Coastal Plans and Programs
<input type="checkbox"/> 15268	Ministerial Projects
<input type="checkbox"/> 15269	Emergency Projects
<input checked="" type="checkbox"/> Other	<u>15282(k) install/maintenance/repair, etc of pipelines less than 1 mile in length.</u>

It is hereby certified that the City of San Diego has determined the above activity to be exempt:

Distribution:

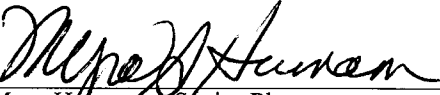
Myra Herrmann, Senior Planner
Environmental Analysis Section

Exemption or Project file
 Patricia Grabski, DPM, DSD (MS 301)
 Darren Genova, Associate Planner, ECP (MS 908A)
 Jim Haghgouy, Associate Engineer – Civil, ECP (MS 908A)

NOTICE OF EXEMPTION

(Check one or both)

TO: X RECORDER/COUNTY CLERK
P.O. BOX 1750, MS A-33
1600 PACIFIC HWY, ROOM 260
SAN DIEGO, CA 92101-2422

FROM: CITY OF SAN DIEGO
DEVELOPMENT SERVICES DEPARTMENT
1222 FIRST AVENUE, MS 501
SAN DIEGO, CA 92101

OFFICE OF PLANNING AND RESEARCH
1400 TENTH STREET, ROOM 121
SACRAMENTO, CA 95814

PROJECT NO.: 182124

PROJECT TITLE: OLD ROSE CANYON TRUNK SEWER RELOCATION

PROJECT LOCATION-SPECIFIC: Lower Rose Canyon south of the Santa Fe Road bridge crossing and North of Damon Street, in the Clairemont Mesa Community Planning area.

PROJECT LOCATION-CITY/COUNTY: San Diego/San Diego

DESCRIPTION OF PROJECT: This project proposes to relocate 3000 LF of Old Rose Canyon Trunk Sewer from Lower Rose Canyon to the Santa Fe Road Right-of-Way. The redirection includes two new manholes and a new pipeline segment within the ROW. The existing line will be abandoned eliminating future access need within Rose Creek for maintenance and emergency repairs. The project would not result in impacts to buried archaeological resources and impacts to sensitive vegetation will be avoided and/or minimized by using canyon proficient vehicles with rubberized tires or by trimming woody riparian shrubs (Salix lasiolepis and Baccharis salicifolia) and not affecting the roots. Hydroseed will be applied where deemed necessary for erosion control. Resource Agency permits and mitigation for trimming riparian vegetation will be obtained/provided by the applicant department. No future access to the abandoned area will be required once the new construction is complete.

NAME OF PUBLIC AGENCY APPROVING PROJECT: City of San Diego

NAME OF PERSON OR AGENCY CARRYING OUT PROJECT: City of San Diego, Engineering & Capital Project Department
Jim Haghgouy, Associate Engineer - Civil
600 "B" Street, MS 908A, San Diego, CA 92101, (619) 533-4657

EXEMPT STATUS: (CHECK ONE)

- () MINISTERIAL (SEC. 15268)
() DECLARED EMERGENCY [SEC. 15269 (A)]
() EMERGENCY PROJECT [SEC. 15269 (B) AND (C)]
() CATEGORICAL EXEMPTION:
(X) OTHER: STATUTORILY EXEMPT, SECTION 15282(K) - INSTALL/MAINTENANCE/REPAIR, ETC., PIPELINES LESS THAN ONE MILE IN LENGTH.

REASONS WHY PROJECT IS EXEMPT: The above referenced project is exempt from the California Environmental Quality Act (CEQA) due to the determination that the project would not cause a significant effect to the environment and that the project meets the criteria for a Statutory Exemption as granted by the Legislature pursuant to Article 18 of CEQA.

CONTACT PERSON: Myra Herrmann, Senior Planner

TELEPHONE: (619) 446-5372

IF FILED BY APPLICANT:

- 1. ATTACH CERTIFIED DOCUMENT OF EXEMPTION FINDING.
2. HAS A NOTICE OF EXEMPTION BEEN FILED BY THE PUBLIC AGENCY APPROVING THE PROJECT?
() YES () NO

Myra Herrmann
SIGNATURE/TITLE

(PROJECT APPROVAL DATE)

CHECK ONE:

- (X) SIGNED BY LEAD AGENCY
() SIGNED BY APPLICANT

DATE RECEIVED FOR FILING:



THE CITY OF SAN DIEGO

Date of Notice: July 27, 2009

NOTICE OF RIGHT TO APPEAL ENVIRONMENTAL DETERMINATION

DEVELOPMENT SERVICES DEPARTMENT

Job Order No. 141261

PROJECT NAME/NUMBER: Old Rose Canyon Trunk Sewer Relocation/182124

COMMUNITY PLAN AREA: Clairemont Mesa Community Planning Area

COUNCIL DISTRICT: 6

LOCATION: Lower Rose Canyon south of the Santa Fe Road bridge crossing and North of Damon St.

PROJECT DESCRIPTION: This project proposes to relocate 3000 LF of Old Rose Canyon Trunk Sewer from Lower Rose Canyon to the Santa Fe Road Right-of-Way. The redirection includes two new manholes and a new pipeline segment within the ROW. The existing line will be abandoned eliminating future access need within Rose Creek for maintenance and emergency repairs. The project would not result in impacts to buried archaeological resources and impacts to sensitive vegetation will be avoided and/or minimized by using canyon proficient vehicles with rubberized tires or by trimming woody riparian shrubs (*Salix lasiolepis* and *Baccharis salicifolia*) and not affecting the roots. Hydroseed will be applied where deemed necessary for erosion control. Resource Agency permits and mitigation for trimming riparian vegetation will be obtained/provided by the applicant department. No future access to the abandoned area will be required once the new construction is complete.

ENTITY CONSIDERING PROJECT APPROVAL: City of San Diego, Hearing Officer

ENVIRONMENTAL DETERMINATION: Statutorily Exempt, Section 15282(k) – Install/maintenance/repair, etc., of pipelines less than one mile in length.

ENTITY MAKING ENVIRONMENTAL DETERMINATION: City of San Diego

STATEMENT SUPPORTING REASON FOR ENVIRONMENTAL DETERMINATION: The above referenced project is exempt from the California Environmental Quality Act (CEQA) due to the determination that the project would not cause a significant effect to the environment and that the project meets the criteria for a Statutory Exemption as granted by the Legislature pursuant to Article 18 of CEQA.

DEVELOPMENT PROJECT MANAGER:

Patricia Grabski

MAILING ADDRESS:

1222 1st Avenue, MS 301, San Diego, CA 92101

PHONE NUMBER:

619-446-5277

On July 24, 2007 the City of San Diego made the above-referenced environmental determination pursuant to the California Environmental Quality Act (CEQA). This determination is appealable to the City Council. If you have any questions about this determination, contact the City Development Project Manager listed above.

Applications to appeal CEQA determination made by staff (including the City Manager) to the City Council must be filed in the office of the City Clerk within 10 business days from the date of the posting of this Notice OR 15 business days from the date of the environmental determination, whichever occurs earlier. Applications to appeal CEQA determinations made by the Planning Commission from a Process Two or Three Appeal under SDMC section 112.0506 must be filed in the Office of the City Clerk within 10 business days from the date of the Planning Commission's decision. The appeal application can be obtained from the City Clerk, 202 'C' Street, Second Floor, San Diego, CA 92101.

This information will be made available in alternative formats upon request.



Old Rose Canyon Sewer Relocation Project

Existing Sewer Manholes

Photo Point Locations

Photo Direction

Manholes to be Abandoned

Proposed New Manholes

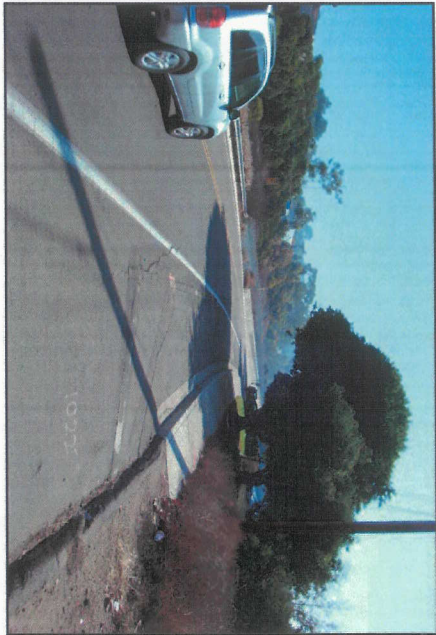

PHOTOGRAPH 1
Santa Fe Street, Facing Southeast

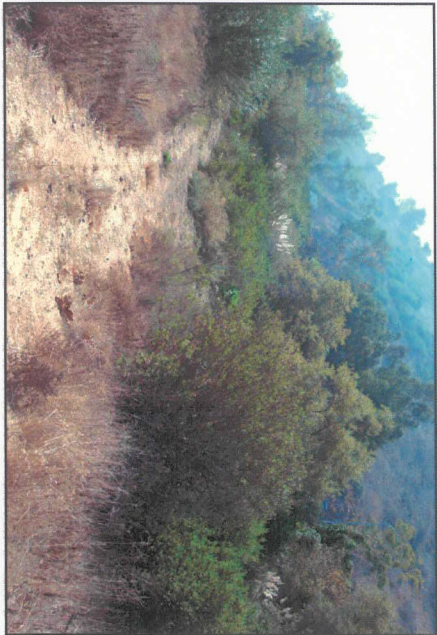

PHOTOGRAPH 2
Maintained Access Road to New Manhole, Facing South

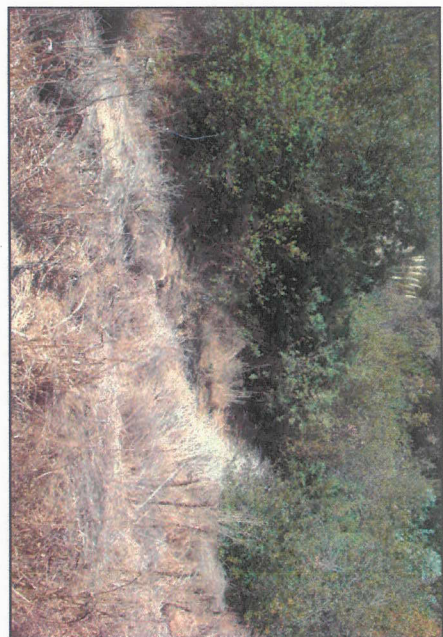

PHOTOGRAPH 3
Upslope from New Manhole, Facing West



PHOTOGRAPH 4
View from New Manhole, Facing Southeast

RECON

M:\JOBSS\4926bu\graphics\permit_packet\photos.indd

06/22/09

RECON

M:\JOBSS\4926bu\graphics\permit_packet\photos.indd

06/22/09

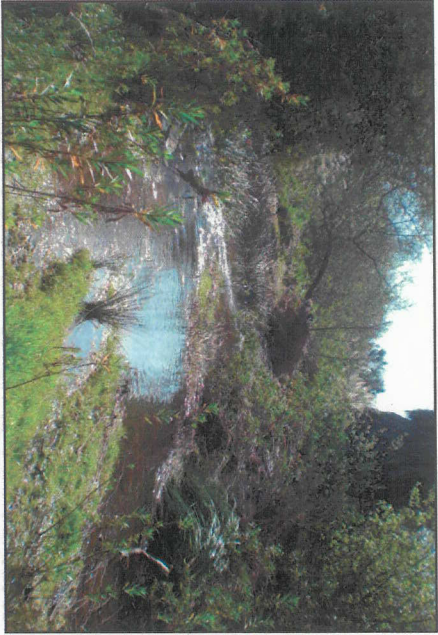

PHOTOGRAPH 5
Upslope from New Manhole, Facing West



PHOTOGRAPH 6
Existing Manhole, Facing East



PHOTOGRAPH 7
Existing Manhole, Facing Southwest



PHOTOGRAPH 8
Existing Manhole, Facing Northeast



PHOTOGRAPH 9
Existing Manhole, Facing East



PHOTOGRAPH 10
Existing Manhole, Facing Southeast



PHOTOGRAPH 11
Existing Manhole, Facing North

CONTRACT DRAWINGS FOR CAPITAL IMPROVEMENTS PROGRAM

City of San Diego

OLD ROSE CANYON 24" TRUNK SEWER RELOCATION

VOLUME 2 - DRAWINGS

AUGUST 2009

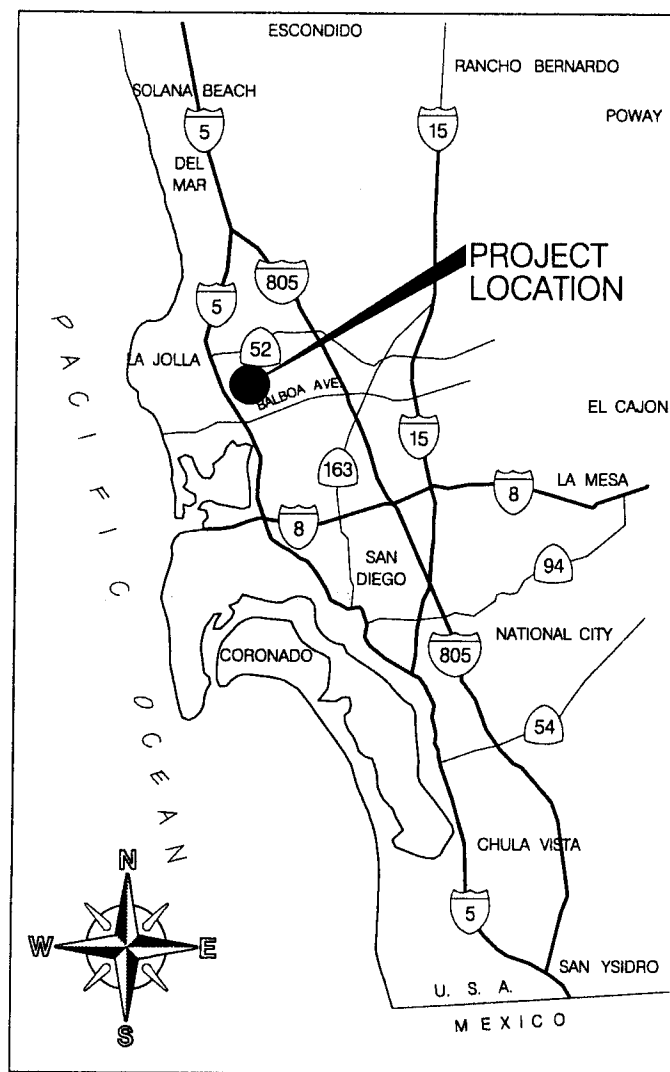

VICINITY MAP
NO SCALE

PROJECT
LOCATION

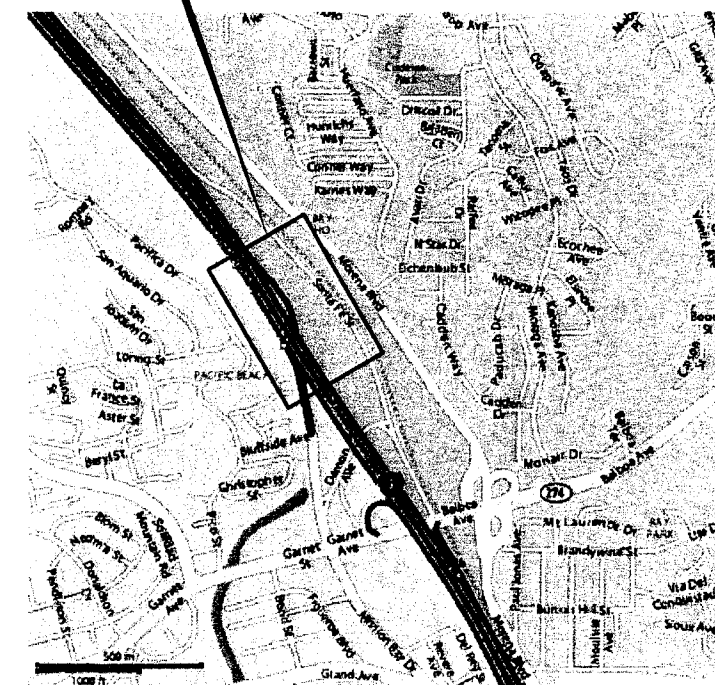

LOCATION MAP

I HEREBY DECLARE THAT I AM THE ENGINEER OF WORK FOR THIS PROJECT THAT I HAVE EXERCISED RESPONSIBLE CHARGE OVER THE DESIGN OF THE PROJECT AS DEFINED IN SECTION 6703 OF THE BUSINESS AND PROFESSIONS CODE AND THAT THE DESIGN IS CONSISTENT WITH CURRENT STANDARDS. I UNDERSTAND THAT THE CHECK OF PROJECT DRAWINGS AND SPECIFICATIONS BY THE CITY OF SAN DIEGO IS CONFINED TO A REVIEW ONLY AND DOES NOT RELIEVE ME, AS ENGINEER OF WORK, OF MY RESPONSIBILITIES FOR PROJECT DESIGN.

(ENGINEER'S NAME)

DATE

6/23/09

G-1

DRAWING NO.	OLD ROSE CANYON TRUNK SEWER RELOCATION
SHEET NO.	
CIP NO.	TITLE, LOCATION & VICINITY MAP
SPECIFICATION NO.	CITY OF SAN DIEGO, CALIFORNIA SHEET xx OF xx SHEETS
WATER W.O.	
SEWER W.O.	
DATE	
DEPUTY DIRECTOR	
DESCRIPTION	
BY	
APPROVED	
DATE	
FILED	
DESIGN ENGINEER	
CONTROL CERTIFICATION	
LAMBERT COORDINATES	
CONTRACTOR INSPECTOR	
DATE STARTED	
DATE COMPLETED	

WARNING
0 1/2 1
IF THIS BAR DOES NOT MEASURE 1" THEN DRAWING IS NOT TO SCALE.

Richard Brady & Associates
3710 Ruffin Road, San Diego, California 92123
tel: 858/496-0500 fax: 858/496-0505

SCALE	HORIZONTAL	NONE
	VERTICAL	NONE

METROPOLITAN WASTEWATER DEPARTMENT
City of San Diego



DRAWING STATUS									
NO.	DATE	REQ.	REVISION DESCRIPTION	DRAWN	CKD	APD	PE	EM	QA/QC

STANDARD DRAWINGS & SPECIFICATIONS

LIMITS OF WORK

WORK TO BE DONE

CONSTRUCTION CONSISTS OF THE INSTALLATION OF A TWENTY FOUR INCH (24") AND A TEN INCH (10") SEWER MAINS, CONCRETE MANHOLES, TRENCH SHORING, TRENCH RESURFACING AND SLURRY SEAL, TRAFFIC CONTROL AND ALL OTHER SEWER LATERALS WORK AND APPURTENANCES IN ACCORDANCE WITH THESE SPECIFICATIONS AND DRAWINGS NUMBERED XXXX-XX-D TO XXXX-XX-D.

STANDARD SPECIFICATIONS:

DOC. NO.	FILED	DESCRIPTION
1. 701041	07-01-04	STANDARD SPECIFICATIONS FOR PUBLIC WORKS CONSTRUCTION (2003 EDITION), INCLUDING THE REGIONAL AND CITY OF SAN DIEGO SUPPLEMENTAL AMENDMENTS.
2. 769843	01-24-00	CALIFORNIA DEPARTMENT OF TRANSPORTATION, "MANUAL OF TRAFFIC CONTROLS FOR CONSTRUCTION AND MAINTENANCE WORK ZONES," (1996 EDITION)
3. 769842	10-22-99	1999 STANDARD SPECIAL PROVISIONS FOR SIGNALS, LIGHTING & ELECTRICAL SYSTEMS OF THE CITY OF SAN DIEGO.
* 4. 769894	06-05-03	STATE OF CALIFORNIA, DEPARTMENT OF TRANSPORTATION, STANDARD SPECIFICATIONS (JULY 2002)

1. STANDARD SPECIFICATION Document No.	Filed	Description
PIT505040901	05-04-09	Standard Specifications for Public Works Construction (GREENBOOK), 2009 Edition
PIT505040902	05-04-09	City of San Diego Supplement, 2009 Update
AEC1231064	12-31-06	California Department of Transportation, Manual of Uniform Traffic Control Devices (MUTCD 2006)
N/A	N/A	The City of San Diego Sign Book, 2003 Edition

2. STANDARD DRAWINGS Document No.	Filed	Description
AEC 1230163	12-31-06	As listed on the detailed plans and specifications. City of San Diego Standard Drawings including Regional Standard Drawings

STANDARD DRAWINGS:

DOC. NO.	FILED	DESCRIPTION
1. 701042	07-01-04	CITY OF SAN DIEGO STANDARD DRAWINGS INCLUDING ALL REGIONAL STANDARD DRAWINGS.
* 2. 769894	06-05-03	STATE OF CALIFORNIA, DEPARTMENT OF TRANSPORTATION STANDARD PLANS (JULY 2002)

CONTRACTOR'S RESPONSIBILITIES

- THE CONTRACTOR SHALL DESIGN, CONSTRUCT AND MAINTAIN ALL SAFETY DEVICES, INCLUDING SHORING AND SHALL BE SOLELY RESPONSIBLE FOR CONFORMING TO ALL LOCAL, STATE, AND FEDERAL SAFETY AND HEALTH STANDARDS, LAWS AND REGULATIONS.
- CONTRACTOR SHALL ASSUME SOLE AND COMPLETE RESPONSIBILITY FOR JOB SITE CONDITIONS DURING THE COURSE OF CONSTRUCTION, INCLUDING SAFETY OF ALL PERSONS AND PROPERTY. THIS REQUIREMENT SHALL APPLY CONTINUOUSLY AND NOT BE LIMITED TO NORMAL WORKING HOURS.
- IT SHALL BE THE CONTRACTOR'S RESPONSIBILITY TO LOCATE AND RECONNECT ALL SEWER LATERALS. LOCATIONS AS SHOWN ON THE PLANS ARE APPROXIMATE ONLY. LATERAL RECORDS ARE AVAILABLE TO THE CONTRACTOR AT THE WATER DEPARTMENT, 2797 CAMINITO CHOLLAS. IT SHALL BE THE CONTRACTOR'S RESPONSIBILITY TO LOCATE THE IMPROVEMENTS THAT WILL BE AFFECTED BY LATERAL REPLACEMENTS. ALL IMPROVEMENTS DISTURBED BY CONTRACTOR SHALL BE REPLACED IN KIND TO ORIGINAL OR BETTER. NEW SEWER LATERALS SHALL NOT BE LOCATED WITHIN 5 FEET OF WATER METERS OR WITHIN 10 FEET OF TREES OR SHRUBS 3 FEET OR HIGHER AT MATURITY.
- CONTRACTOR SHALL MAINTAIN REDLINE AS-BUILT DRAWINGS. REDLINES SHALL INDICATE THE LIMITS OF THE STEEL CASING IN THE TUNNELED AREAS OF WORK.
- THE CONTRACTOR SHALL BE RESPONSIBLE FOR THE SURVEY MONUMENTS AND/OR VERTICAL CONTROL BENCHMARKS WHICH ARE DISTURBED OR DESTROYED BY CONSTRUCTION A LAND SURVEYOR MUST FIELD LOCATE, REFERENCE, AND /OR PRESERVE ALL HISTORICAL OR CONTROLLING MONUMENTS PRIOR TO ANY EARTHWORK. IF DESTROYED, SUCH MONUMENTS SHALL BE REPLACED WITH APPROPRIATE MONUMENTS BY A LAND SURVEYOR, A CORNER RECORD OR RECORD OF SURVEY, AS APPROPRIATE, SHALL BE FILED AS REQUIRED BY THE PROFESSIONAL LAND SURVEYOR'S ACT. IF ANY VERTICAL CONTROL IS TO BE DISTURBED, OR DESTROYED, THE CITY OF SAN DIEGO FIELD SURVEY SECTION MUST BE NOTIFIED, IN WRITING, AT LEAST 3 DAYS PRIOR TO THE CONSTRUCTION. THE CONTRACTOR WILL BE RESPONSIBLE FOR THE COST OF REPLACING ANY VERTICAL CONTROL BENCHMARKS DESTROYED BY THE CONSTRUCTION.
- EXISTING MAINS SHALL BE KEPT IN SERVICE IN LIEU OF HIGH-LINING, UNLESS OTHERWISE SHOWN ON PLANS.
- THE LOCATION OF EXISTING BUILDINGS AS SHOWN ON THE PLAN ARE APPROXIMATE.
- CONTRACTOR SHALL REPLACE IN KIND ANY TRAFFIC SENSORS OR EQUIPMENT DAMAGED DURING CONSTRUCTION.
- CONTRACTOR SHALL PREVENT DEBRIS FROM GOING TO THE STORM DRAIN DURING CONSTRUCTION.
- STORM DRAIN INLETS TO REMAIN FUNCTIONAL / OPERATIONAL AT ALL TIMES DURING CONSTRUCTION.
- UNLESS OTHERWISE NOTED AS PREVIOUSLY POTHOLED (PH), ALL ELEVATIONS SHOWN ON THE PROFILE FOR EXISTING UTILITIES ARE BASED ON A SEARCH OF THE AVAILABLE RECORD INFORMATION ONLY AND ARE SOLELY FOR THE CONTRACTOR'S CONVENIENCE. THE CITY IN NO WAY WARRANTS OR GUARANTEES THAT IT HAS REVIEWED ALL AVAILABLE DATA. IT IS THE CONTRACTOR'S RESPONSIBILITY TO POTHOLE ALL EXISTING UTILITIES (EITHER SHOWN ON THE PLANS OR MARKED IN THE FIELD) IN ACCORDANCE WITH THE SPECIFICATIONS (REFERENCE SPECIFICATIONS SECTION 5-1)
- EXCEPT FOR THOSE PORTIONS OF THE WORK COVERED BY ANY ATTACHED TRAFFIC PLANS, ALL TRAFFIC CONTROL SHALL BE DESIGNED BY THE CONTRACTOR AND SUBMITTED AS SHOP DRAWINGS IN ACCORDANCE WITH SECTION 7-10.1 OF THE SPECIFICATIONS.
- CONTRACTOR SHALL NOTIFY THE RESIDENT ENGINEER IMMEDIATELY IF A ONE FOOT VERTICAL SEPARATION (FROM OUTSIDE PIPE WALL TO OUTSIDE PIPE WALL) BETWEEN SEWER AND WATER CANNOT BE MAINTAINED.
- CONTRACTOR SHALL NOTIFY THE RESIDENT ENGINEER IMMEDIATELY IF A FOUR FOOT HORIZONTAL SEPARATION (FROM OUTSIDE PIPE WALL TO OUTSIDE PIPE WALL) BETWEEN SEWER AND WATER CANNOT BE MAINTAINED.
- CONTRACTOR SHALL NOTIFY THE RESIDENT ENGINEER IMMEDIATELY IF A 6 INCH VERTICAL SEPARATION (FROM OUTSIDE PIPE WALL TO OUTSIDE PIPE WALL) BETWEEN UTILITIES CANNOT BE MAINTAINED.

SHEET NO.	STREET	LIMITS	PIPE		LENGTH (FT)
			SIZE (IN)	TYPE	
1	SEWER	TITLE, LOCATION & VICINITY MAP			
2	TITLE PAGE 1	LIMITS OF WORK, WORK TO BE DONE, MAPS, ETC.			
3	TITLE PAGE 2	DRAWING INDEX & GENERAL NOTES			
4	SANTA FE STREET	PLAN & PROFILE - STA. 1+00 TO STA. 10+00	24	SEWER	900.00
5	SANTA FE STREET	PLAN & PROFILE - STA. 10+00 TO STA. 19+00	24	SEWER	900.00
6	SANTA FE STREET	PLAN & PROFILE - STA. 19+00 TO STA. 25+53.08	24	SEWER	653.08
7	ROSE CANYON WASH	SEWER ABANDONMENT - STA. 2+00 TO STA. 20+00	24	SEWER	1800.00
8	ROSE CANYON WASH	SEWER ABANDONMENT - STA. 20+00 TO STA. 30+00	24	SEWER	1000.00
		MISC DETAILS			
		TRAFFIC PLANS			

FIELD NOTES:

REFERENCES:
R.O.S. 8914, 11633, MS 778, LO 3585, 3586, 3587, 9597, 9598
DWG. 4686-D, 13433-B 16826-2-B

BASIS OF BEARINGS/COORDINATES:
The Basis of Bearings for this project was derived from a previous STATIC GPS Survey using GPS 136 and GPS 141 as shown on R. of S. 14492 (i.e. N 14° 19' 33" W, Zone 6 (epoch 9L35), utilizing RTK/GPS field procedures with the Base Station located at an autonomous position, constraining to GPS 136 & GPS 141.

BENCH:
SEBP JUTLAND & JUTLAND COURT Elev. 308.917 MSL.
Based on NGVD 29 FEET as shown in the City of San Diego Bench Book

MAJOR STREETS:
SANTA FE STREET
DAMON AVENUE

ABBREVIATIONS

ABAND	ABANDON	CONTR	CONTRACTOR	OVHD	OVER HEAD
ABAND'D	ABANDONED	DB	DIRECT BURIED	PVC	POLYVINYL CHLORIDE
AC	ASBESTOS CEMENT PIPE	EB	ENCASED BURIED	PROP	PROPOSED
AHD	AHEAD	EL, ELEV	ELEVATION	RED	REDUCER
ASSY	ASSEMBLY	ELEC	ELECTRIC	RT	RIGHT
BK	BACK	EX, EXIST	EXISTING	§	SURVEY LINE
BTWN	BETWEEN	F	FLANGE	SWR	SEWER
CATV	CABLE TV	GV	GATE VALVE	TEL	TELEPHONE
CI	CAST IRON PIPE	HP	HIGH PRESSURE	UNK	UNKNOWN
CL	CENTER LINE	IE	INVERT ELEVATION	VC	VITRIFIED CLAY PIPE
COND	CONDUIT	LT	LEFT	WM	WATER METER
CONT	CONTINUED	MJ	MECHANICAL JOINT	WTR	WATER
		MTD	MULTIPLE TELEPHONE DUCT		

UNDERGROUND UTILITIES

AT LEAST THREE (3) WORKING DAYS PRIOR TO EXCAVATION, THE CONTRACTOR SHALL REQUEST MARKOUT OF UNDERGROUND UTILITIES BY CALLING THE BELOW LISTED REGIONAL NOTIFICATION CENTER FOR AN INQUIRY IDENTIFICATION NUMBER:

UNDERGROUND SERVICE ALERT (U.S.A.) 1-800-422-4133

EXISTING UTILITIES

EX WATER MAIN & VALVES	— — — — —
EX WATER METER	— — — — —
EX FIRE HYDRANT	⊕ +
EX SEWER MAIN & MANHOLES	— — — — —
EX DRAINS	— — — — —
EX PAVEMENT (PROFILE)	///
EX GROUND LINE (PROFILE)	///
EX TRAFFIC SIGNAL	⊗ TS
EX STREET LIGHT	⊕ SL
GAS MAIN	— G — — — —
ELEC. COND., TEL. COND., CATV	— E — — T — — C —

LEGEND

IMPROVEMENTS	STANDARD DRAWINGS	SYMBOL
PAVING & TRENCH RESURFACING	SDG-107, SDG-108	— — — — —
SEWER MAIN	SP-01, SP-02, S-4C, S-19, SDS-100, SDS-101	— — — — —
SEWER MANHOLE	M-3, SDS-106, SDS-107	⊙
SEWER LATERAL WITH C.O.	SDRS SD-01, 02, 03, 04, 05, 07, 08	— — — — —
SEWER LATERAL CONNECTION	SEE PLANS & SPECS WP-03, SM-08	— — — — —
EX MANHOLES TO BE ABANDONED	SEE PLANS & SPEC.	⊙
SURVEY MONUMENT	M-10	⊕
HORIZONTAL ALIGNMENT COORDINATE POINT NUMBER		(TS)

FOR ADDITIONAL SYMBOLS SEE RESURFACING, CURB RAMP, AND TRAFFIC CONTROL SHEETS.

6/23/09

G-2

DRAWING NO.	OLD ROSE CANYON TRUNK SEWER RELOCATION								
SHEET NO.									
CIP NO.									
SPECIFICATION NO.									
DRAWING INDEX & GENERAL NOTES									
CITY OF SAN DIEGO, CALIFORNIA									
SHEET xx OF xx SHEETS									
WATER W.O.									
SEWER W.O.									
DRAWING STATUS									
NO.	DATE	REQ.	REVISION DESCRIPTION	DRAWN	CKD	APD	PE	EM	QA/QC
MWD DIRECTOR		DATE		DEPUTY DIRECTOR		DESIGN ENGINEER		CONTROL CERTIFICATION	
DESCRIPTION		BY		APPROVED DATE		FILMED		LAMBERT COORDINATES	
CONTRACTOR		DATE STARTED		INSPECTOR		DATE COMPLETED		- D	

WARNING
IF THIS BAR DOES NOT MEASURE 1" THEN DRAWING IS NOT TO SCALE.

Richard Brady & Associates
3710 Ruffin Road, San Diego, California 92123
tel: 858/496-0500 fax: 858/496-0505

SCALE
HORIZONTAL
VERTICAL

METROPOLITAN WASTEWATER DEPARTMENT
City of San Diego



P:\OR\1\nc-Orion Construction\ORIONC-003-RoseCanyon TS\07_Dgn\Gen\3838G102.dgn 24-JUN-2009 10:47 jreyes

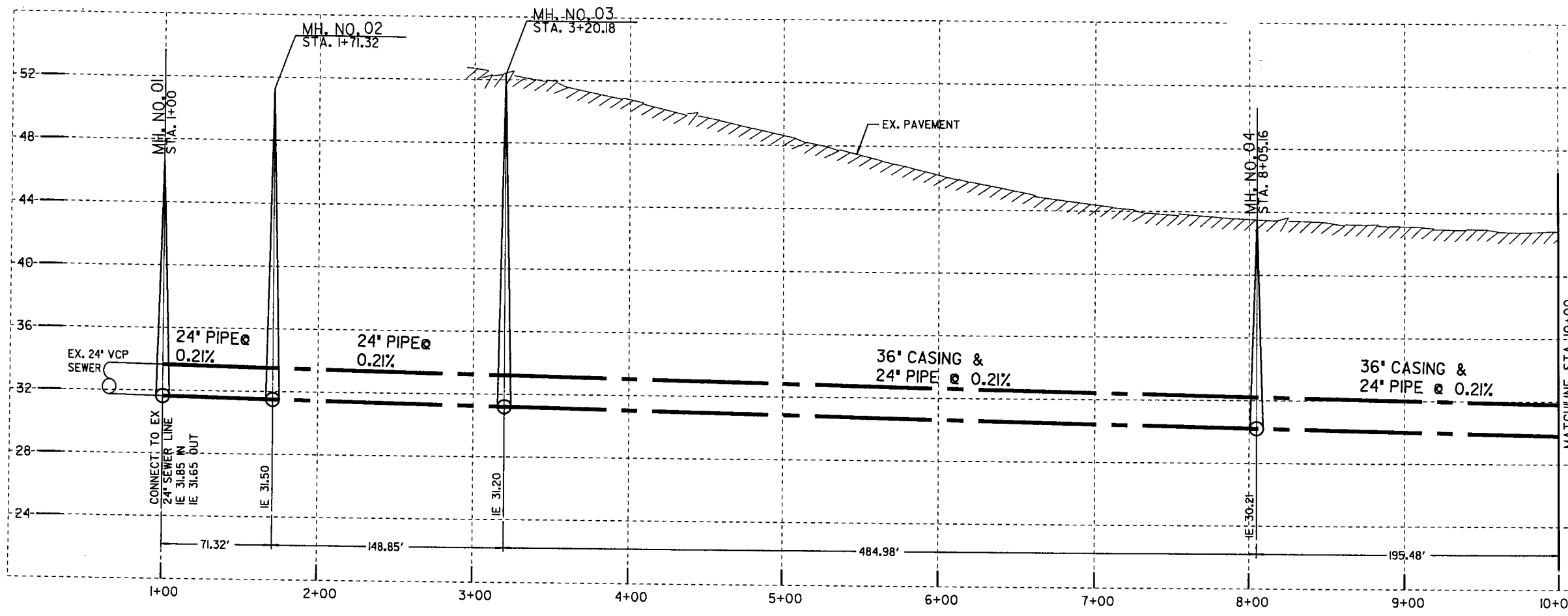

SCALE
1"=40' HORIZ.
1"=4' VERT.

PROPOSED PIPE DATA TABLE				
NO.	Δ/BEARING	RADIUS	LENGTH	REMARKS
1	S34° 05'15"E		71.32'	24" PIPE
2	S75° 57'31"E		148.85'	24" PIPE
3	S42° 13'32"E		484.98'	24" PIPE
4	S42° 13'32"E		195.48'	24" PIPE

COORDINATE TABLE			
NO.	NORTHING	EASTING	DESCRIPTION
001	1878299.74	6262880.31	MH NO. 1
002	1878240.67	6262920.28	MH NO. 2
003	1878204.55	6263064.69	MH NO. 3
004	1877845.42	6263390.62	MH NO. 4

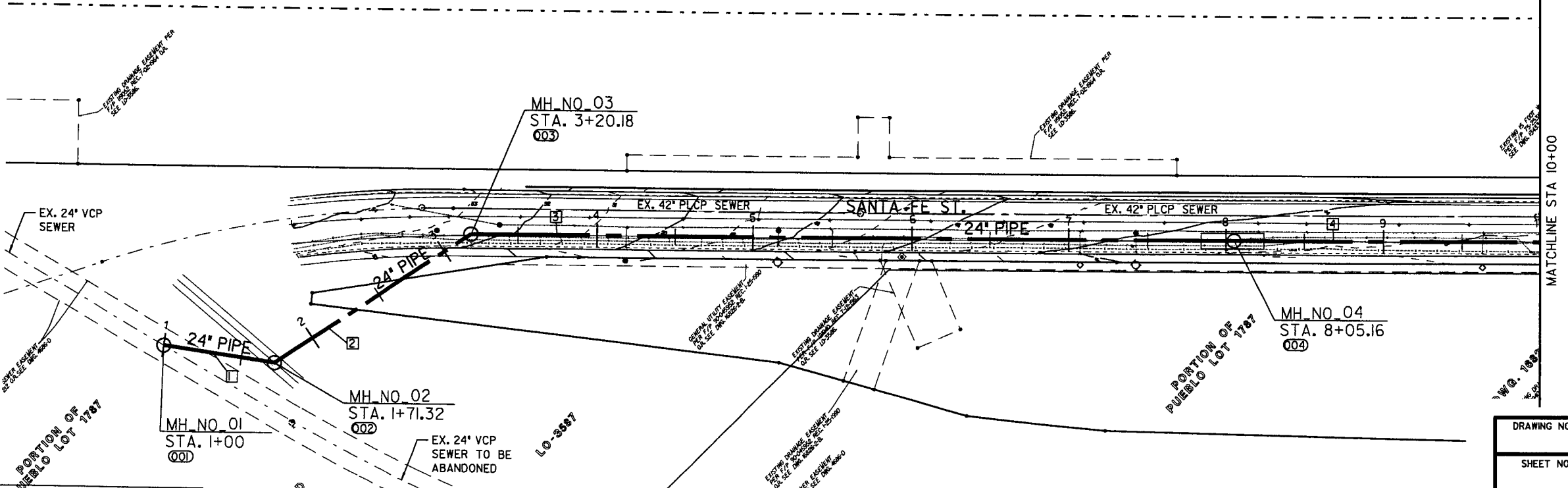

SCALE: 1"=40'

C-1

CONTRACTOR'S NOTE:
EXISTING UTILITY CROSSINGS MAY NOT BE REPRESENTATIVE OF ACTUAL LENGTH OF CONFLICT AREA (SEE PLAN VIEW).

WARNING
0 1/2"
IF THIS BAR DOES NOT MEASURE 1" THEN DRAWING IS NOT TO SCALE.

Richard Brady & Associates
3710 Ruffin Road, San Diego, California 92123
tel: 858/496-0500 fax: 858/496-0505

METROPOLITAN WASTEWATER DEPARTMENT
City of San Diego



DRAWING NO.
SHEET NO.
CIP NO.
SPECIFICATION NO.

OLD ROSE CANYON TRUNK SEWER RELOCATION
PLAN AND PROFILE
SANTA FE STREET
STA 1+00 TO STA 10+00

CITY OF SAN DIEGO, CALIFORNIA
SHEET xx OF xx SHEETS

6/23/09

DRAWING STATUS									
NO.	DATE	REQ.	REVISION DESCRIPTION	DRAWN	CKD	APD	PE	EM	QA/QC

MWD DIRECTOR		DATE	
DESCRIPTION	BY	APPROVED	DATE

WATER W.O.
SEWER W.O.
DESIGNED BY
DEPUTY DIRECTOR
DESIGN ENGINEER
CONTROL CERTIFICATION
LAMBERT COORDINATES
CONTRACTOR INSPECTOR
DATE STARTED
DATE COMPLETED

P:\ORION\Construction\ORION\003-RoseCanyon_TIS\07_Dgn\Civ\3638C101.dgn
24-JUN-2009 10:47

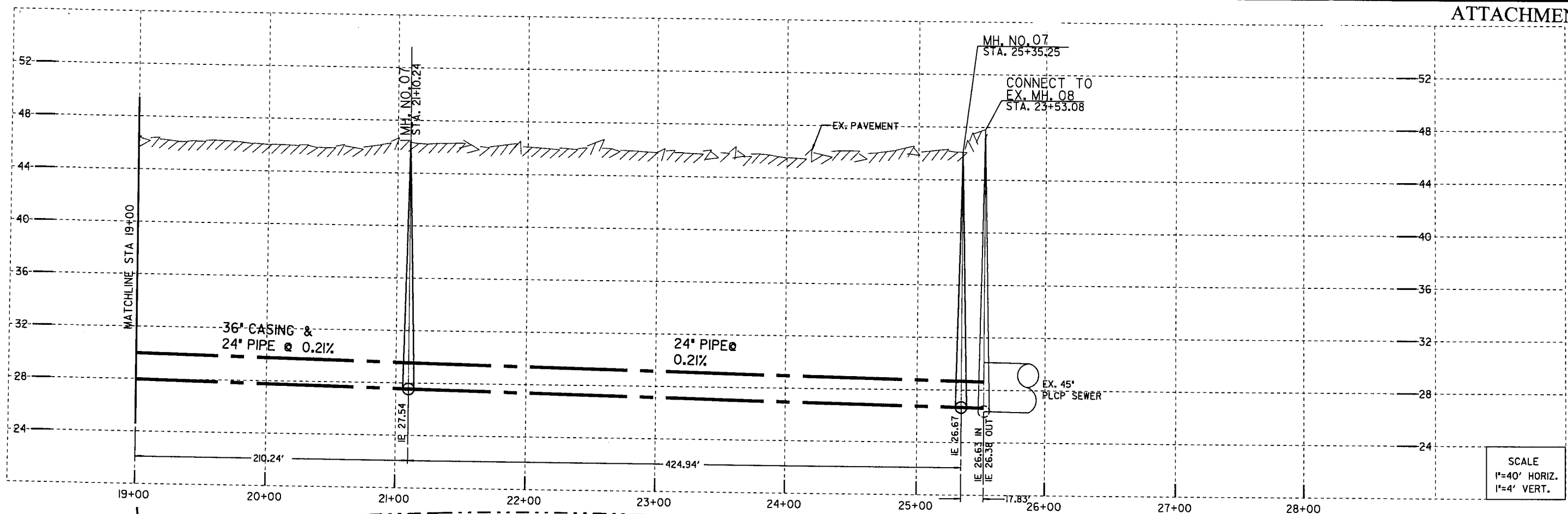

PROPOSED PIPE DATA TABLE				
NO.	Δ/BEARING	RADIUS	LENGTH	REMARKS
1	S30° 48' 47"E	2500.00'	210.24	24" PIPE
2	0° 08' 02"	2760.00'	425.01'	24" PIPE PI DEFLECT
3	S67° 29' 37"E		17.83'	24" PIPE

COORDINATE TABLE			
NO.	NORTHING	EASTING	DESCRIPTION
001	1876838.99	6264216.87	MH NO. 7
002	1876458.92	6264406.12	MH NO. 8
003	1876452.09	6264422.59	MH NO. 9

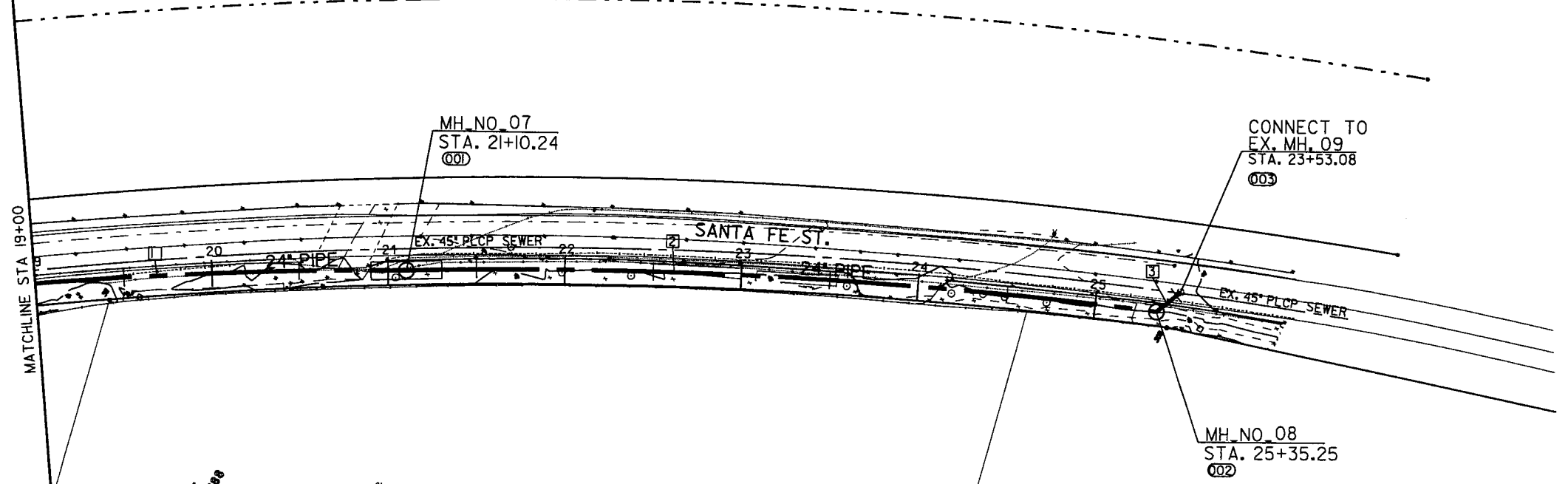

C-3

P:\ORIONC-Orion\Construction\ORIONC.003-RoseCanyon Ts\07_Dgn\Civ\3838C103.dgn 24-JUN-2009 10:47 jreyes

CONTRACTOR'S NOTE:
EXISTING UTILITY CROSSINGS MAY NOT BE REPRESENTATIVE OF ACTUAL LENGTH OF CONFLICT AREA (SEE PLAN VIEW).

WARNING
0 1/2 1
IF THIS BAR DOES NOT MEASURE 1" THEN DRAWING IS NOT TO SCALE.

Richard Brady & Associates
3710 Ruffin Road, San Diego, California 92123
tel: 858/496-0500 fax: 858/496-0505

SCALE: HORIZONTAL VERTICAL

METROPOLITAN WASTEWATER DEPARTMENT
City of San Diego



DRAWING STATUS										
NO.	DATE	REQ.	REVISION	DESCRIPTION	DRAWN	CKD	APD	PE	EM	QA/QC

DRAWING NO.
SHEET NO.
CIP NO.
SPECIFICATION NO.

OLD ROSE CANYON TRUNK SEWER RELOCATION
PLAN AND PROFILE
SANTA FE STREET
STA 19+00 TO STA 25+53.08
CITY OF SAN DIEGO, CALIFORNIA
SHEET xx OF xx SHEETS

MWW DIRECTOR		DATE		DEPUTY DIRECTOR	
DESCRIPTION	BY	APPROVED	DATE	FILMED	DATE

CONTRACTOR INSPECTOR: _____ DATE STARTED: _____ DATE COMPLETED: _____

-D

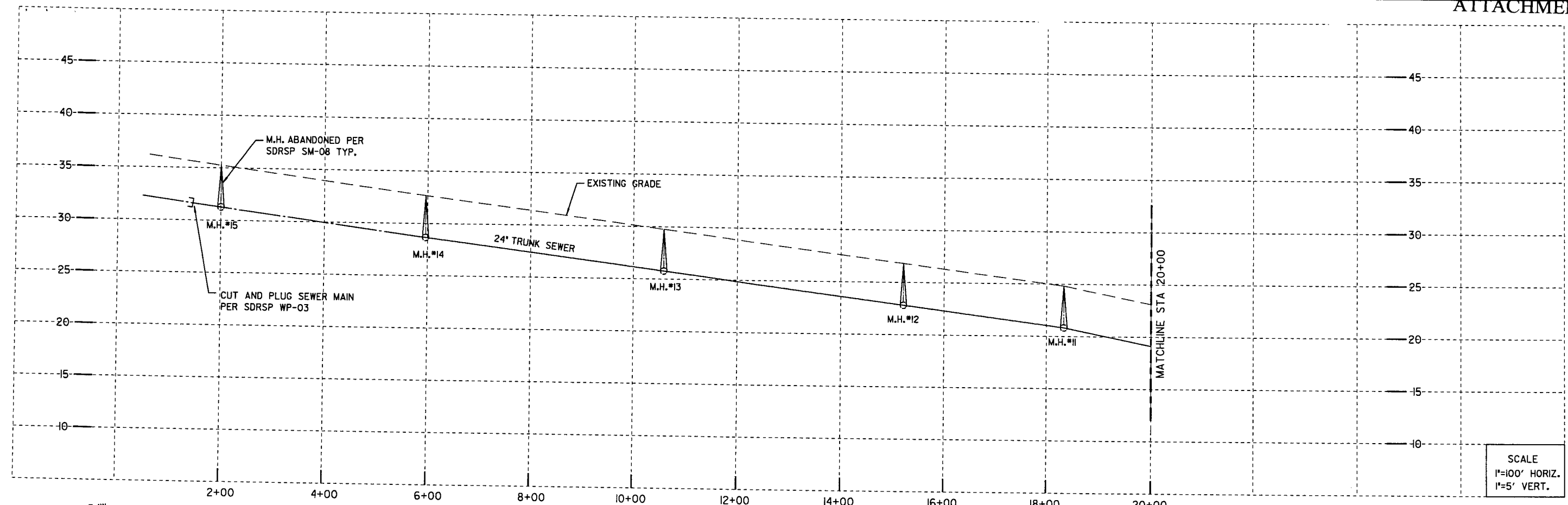

SCALE
1"=100' HORIZ.
1"=5' VERT.

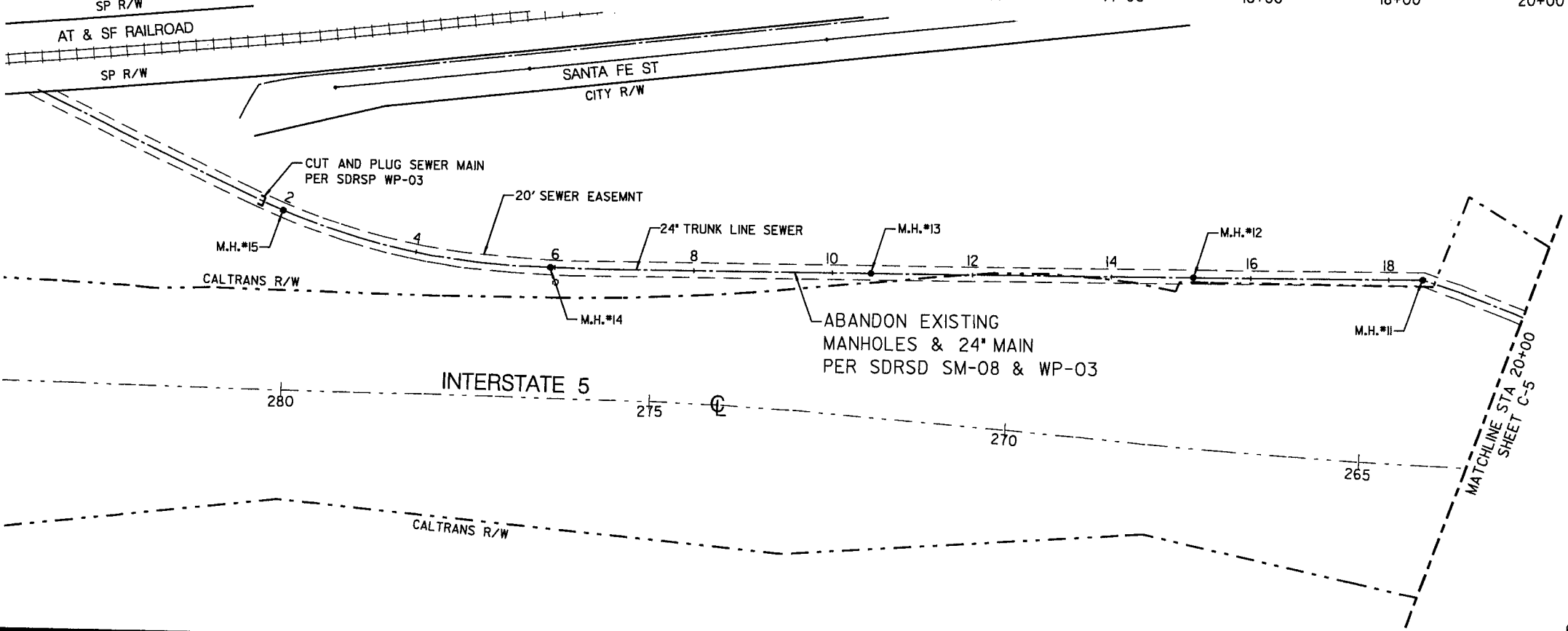

SEWER MAIN ABANDONMENT

SYMBOL	SIZE	TYPE	LENGTH	YEAR INSTALLED
—	24"	VCES	2800	1957
•			7 MH'S	1957

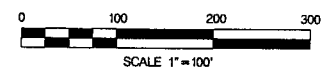

C-4

6/23/09

WARNING
IF THIS BAR DOES NOT MEASURE 1" THEN DRAWING IS NOT TO SCALE.

Richard Brady & Associates
3710 Ruffin Road, San Diego, California 92123
tel: 858/496-0500 fax: 858/496-0505

SCALE
HORIZONTAL
VERTICAL

METROPOLITAN WASTEWATER DEPARTMENT
City of San Diego



DRAWING STATUS

NO.	DATE	REQ.	REVISION DESCRIPTION	DRAWN	CKD	APD	PE	EM	QA/QC

**OLD ROSE CANYON TRUNK SEWER
24" SEWER ABANDONMENT
STA 2+00 TO STA 20+00**

CITY OF SAN DIEGO, CALIFORNIA
SHEET OF SHEETS

CONTRACTOR	DATE STARTED	DEPUTY DIRECTOR
INSPECTOR	DATE COMPLETED	DESIGN ENGINEER
		CONTROL CERTIFICATION
		LAMBERT COORDINATES

P:\ORION\CONSTRUCTION\ORIONC.003-ROSECANYON TS\07_DGN\CIV\CTEP-01.DGN
24-JUN-2009 10:47 JREYES

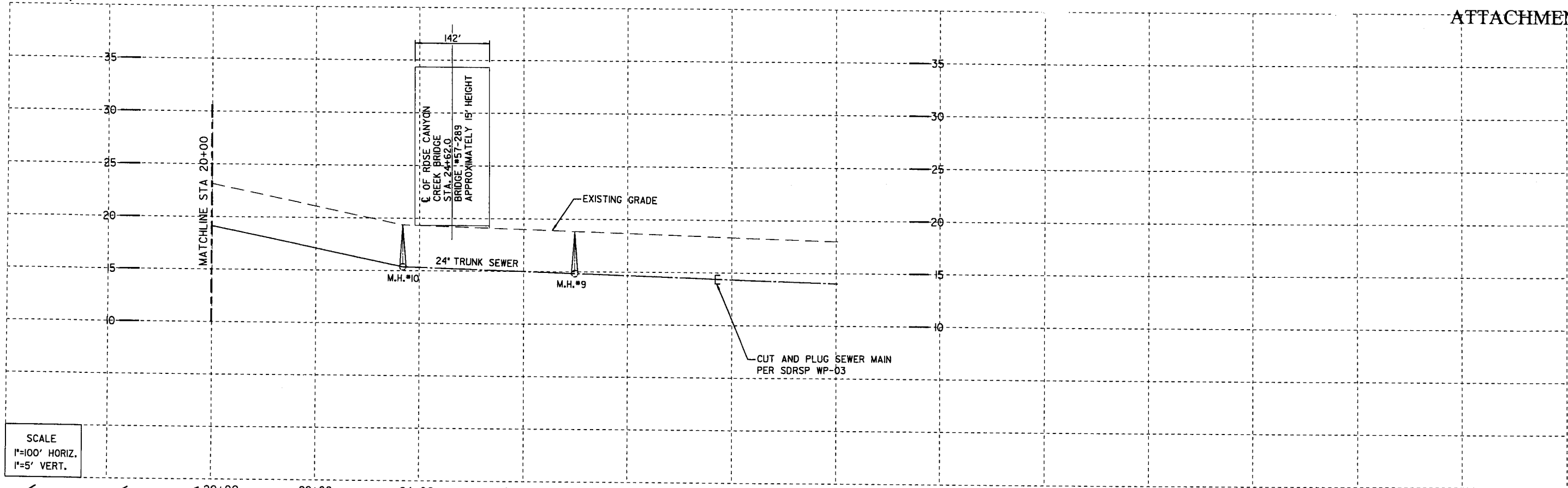

SCALE
1"=100' HORIZ.
1"=5' VERT.

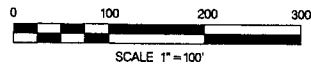
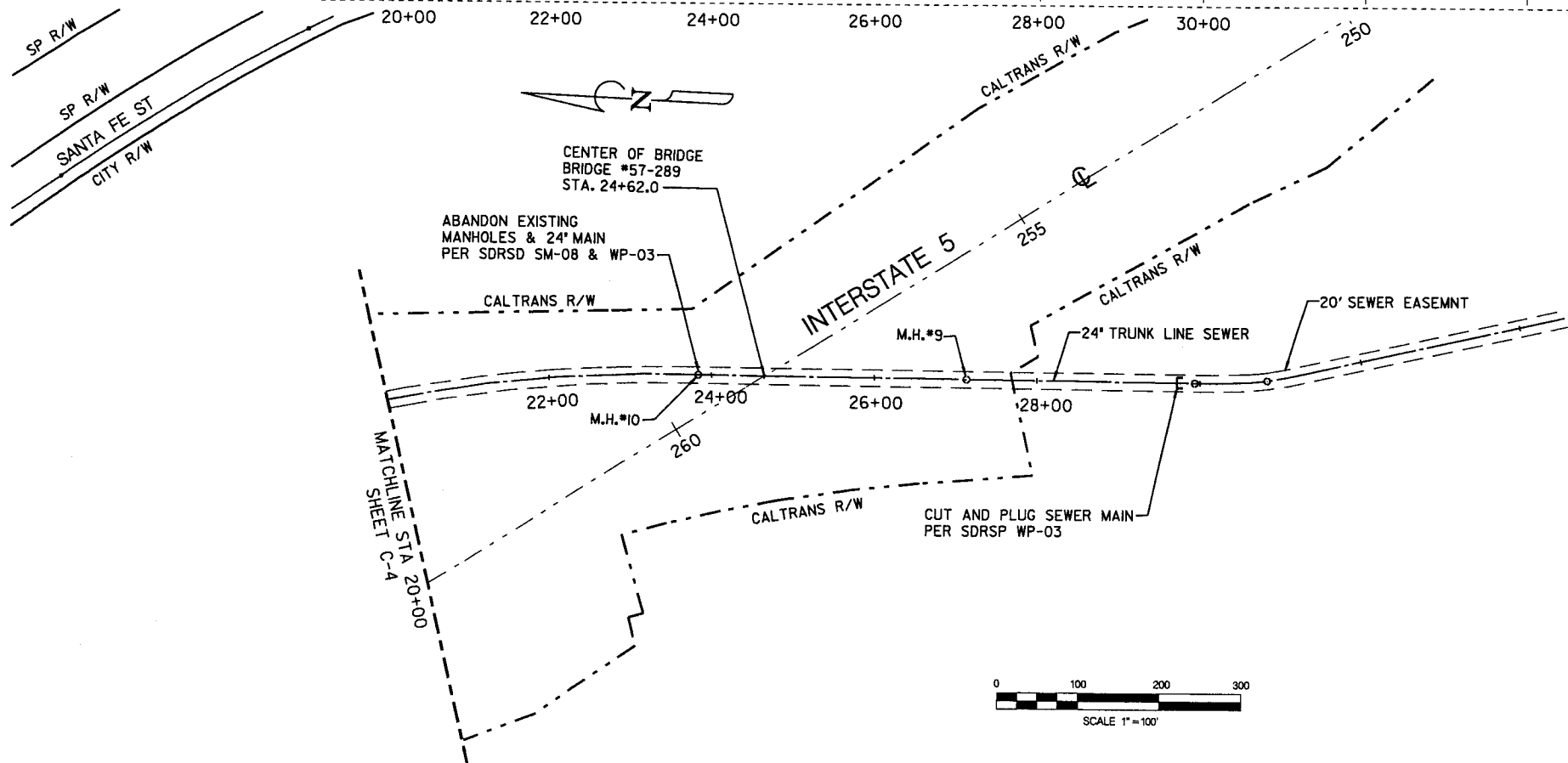

C-5

DRAWING NO.	OLD ROSE CANYON TRUNK SEWER 24" SEWER ABANDONMENT STA 20+00 TO STA 30+00 CITY OF SAN DIEGO, CALIFORNIA SHEET OF SHEETS	WATER
SHEET NO.		SEWER
CIP NO.		W.O.
SPECIFICATION NO.		W.O.

6/23/09

WARNING

 IF THIS BAR DOES NOT MEASURE 1" THEN DRAWING IS NOT TO SCALE.

Richard Brady & Associates
 3710 Ruffin Road, San Diego, California 92123
 tel: 858/496-0500 fax: 858/496-0505

METROPOLITAN WASTEWATER DEPARTMENT
 City of San Diego



DRAWING STATUS							
NO.	DATE	REQ.	REVISION	DESCRIPTION	DRAWN	CKD	APD

MWD DIRECTOR		DATE		DEPUTY DIRECTOR	
DESCRIPTION	BY	APPROVED	DATE	FILMED	DESIGN ENGINEER
CONTRACTOR	DATE STARTED	INSPECTOR	DATE COMPLETED		

P:\ORION\CONSTRUCTION\ORIONC.003-ROSECANYON TS\07_DGN\CIVACTEP-02.DGN
 24-JUN-2009 10:47 JREYES