

Location Map

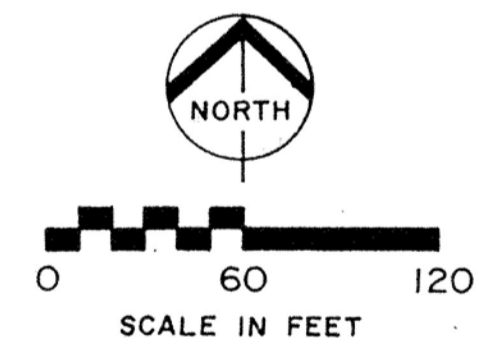

DATA LOG FOR:				
DATE	ACTION	REFERENCE	DOCUMENTS	
	SITE ACQUIRED	RESO NO	COST 1	ACRES 19.11
	SITE DEDICATED	ORD NO		ACRES
6-92	GDP CONSULTANT HIRED	RESO NO	NAME KTU&A	
9-95	P & R BOARD APPROVAL	PF & R APPROVAL		
	INITIAL DEVELOPMENT	CIP NO 29-625.0	JO NO 119671	DRWG NO
	PHASE II	CIP NO	JO NO	DRWG NO
1-13	GDP AMENDMENT APPROVAL	CIP NO	JO NO	DRWG NO
		CIP NO	JO NO	DRWG NO
		CIP NO	JO NO	DRWG NO

IMPROVEMENTS SUMMARY (DATA FROM AS-BUILT DRAWINGS)					
ITEM	QUANTITY	ITEM	QUANTITY	ITEM	QUANTITY
TOTAL SITE	19.11 AC	PLAY AREA	4,062 SF	PAVED WALKS	104,377 SF
IMPROVED AREA	19.76 AC	MULTI PURPOSE CT	9,975 SF	PARK ROADS	SF
TURF	6.13 AC	TENNIS CTS	29,556 SF	PARKING LOT	93,020 SF
SHRUB BED	6.19 AC	RESTROOM	2,700 SF	" STALLS STD	179
NATURAL	AC	REC BLDG	17,245 SF	" STALLS HDCP	5
OTHER LANDSCAPING	AC	POOL BLDG	2,527 SF	COURT GAME AREA	SF
DIRT INFIELDS	.73 AC	" DECK	15,358 SF	TENNIS BLDG.	1,575 S.F.
		" WATER	9,224 SF	LAWN EDGING	LF
				VOLLEYBALL CT.	4,000 S.F.
				REVISION	T.R. 9-23-96

CITY OF SAN DIEGO PARK and RECREATION DEPARTMENT

THE GENERAL DEVELOPMENT PLAN

CARMEL VALLEY

COMMUNITY PARK

COUNCIL DIST. NO. 1 COMM. PLAN AREA CARMEL VALLEY

LAMBERT COORDINATES 286-1698 THOMAS BROS PG.1188, A-6

PSD NO. 190

Proposed GDP Amendment for: Multipurpose Field at Carmel Valley Community Park



October 17th, 2024

Project Workshop Timeline

- 1. Public Workshop #1 - Jan 9th, 2024**
- 2. Public Workshop #2 - March 12th, 2024**
- 3. Action Item Meeting - June 11th, 2024**
- 4. Prior & Current GDP's for Carmel Valley Community Park**

Introductions

San Diego Community Members / Project Managers

- Frederik Andersen
- o Daniel Koehler

San Diego Parks & Recreation Staff

- Debbie Marcotte - Area Manager II
- Kathleen Brand - Project Officer II
- Michelle Abella-Shon - Asset Manager

Carmel Valley Recreation Center Staff

- Marilee Pacelli - Recreation Council Chair
- Mike Mangarelli - Recreation Center Director

Workshop #1 Community Feedback - Jan 9th, 2024

Meeting Notes/Comments:

- 40-50 community members in attendance, majority were there in support of pickleball & padel facilities
- Community members noted the following:
 - Facility should be publicly accessible and not a private facility
 - Facility should allow for inclusiveness of all levels of play & be suitable space for children
 - All courts should be lighted to allow for evening play
 - Court booking costs need to be reasonable
 - Some green space should be maintained in that section of the park
 - While indoor pickleball options are available, there are no outdoor pickleball or padel facilities in the Carmel Valley area (the sport is intended to be played on a hard court)
 - Court orientation needs to be kept in mind
 - Public restroom facilities should be easily accessible
 - Refreshment options would be a huge plus given existing facilities in San Diego typically have limited to no offerings
 - This area in the park is utilized currently by sports groups and for occasional community events (movie nights, birthday parties etc.)

Note: There were many specific design discussions related to example renderings that were shown that occurred during this workshop that were outside the scope of the meetings intended purpose

Workshop #2 Community Feedback - Mar 12th, 2024

Important Features

Social Area
Courts for all levels
Coaching
Pro Shop
Restroom Access
On-court Seating
Food & Beverage
Fencing
Designated Parking
Viewing Areas
Clinics / Lessons / Open Play
Kid-Friendly / Summer Camps

Lacking Features at Other Facilities

Bad Layouts
No Lessons / Coaching Available
Not Enough Courts
Not Enough Spacing Between Courts
No Viewing Area or Seating
Far Restroom Access
Lack of Shade
Overcrowded / No Management
No Court Maintenance

Action Item Meeting & Vote - June 11th, 2024

Carmel Valley Recreation Council

On June 11th, 2024, the Carmel Valley Recreation Council approved an action item in a 6-3 vote recommending that a letter be sent to the Park and Recreation Department Director asking that the GDP for Carmel Valley Community Park be amended to include a hard-court area in the north-western section of the park, that was previously intended for multi-sport arenas.



Previous and Current GDPs

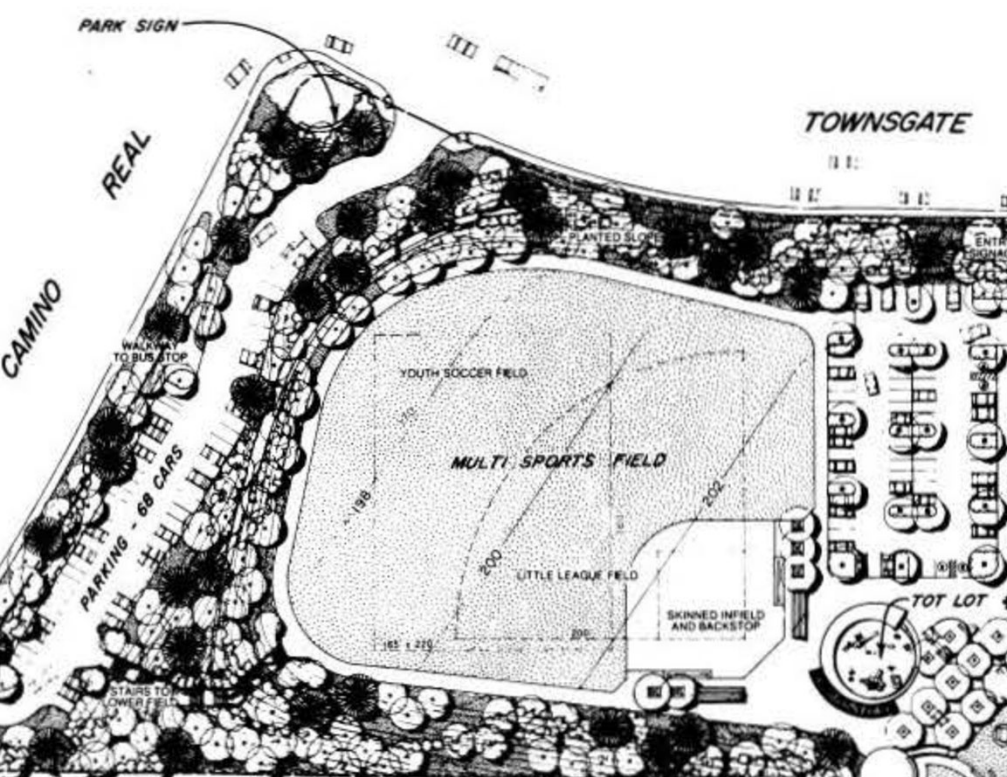

1996 (Initial)



2013 (Current)

New General Development Plan Proposal

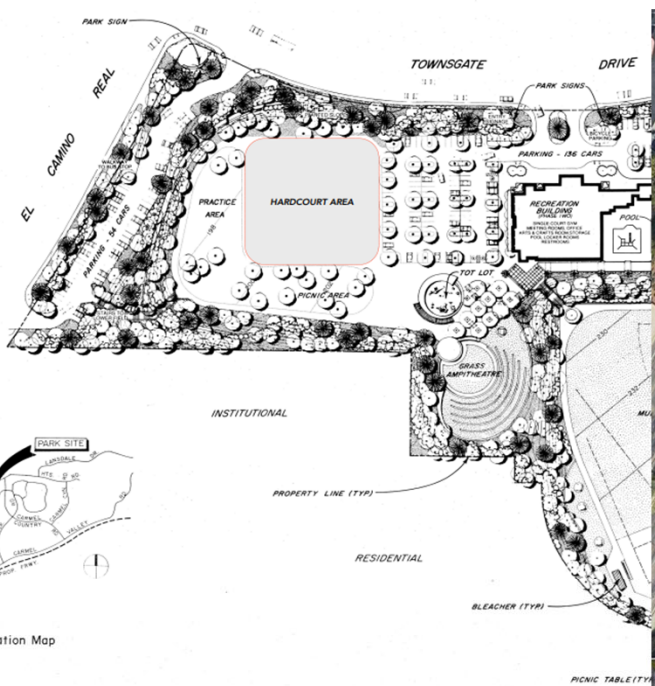

Location Map

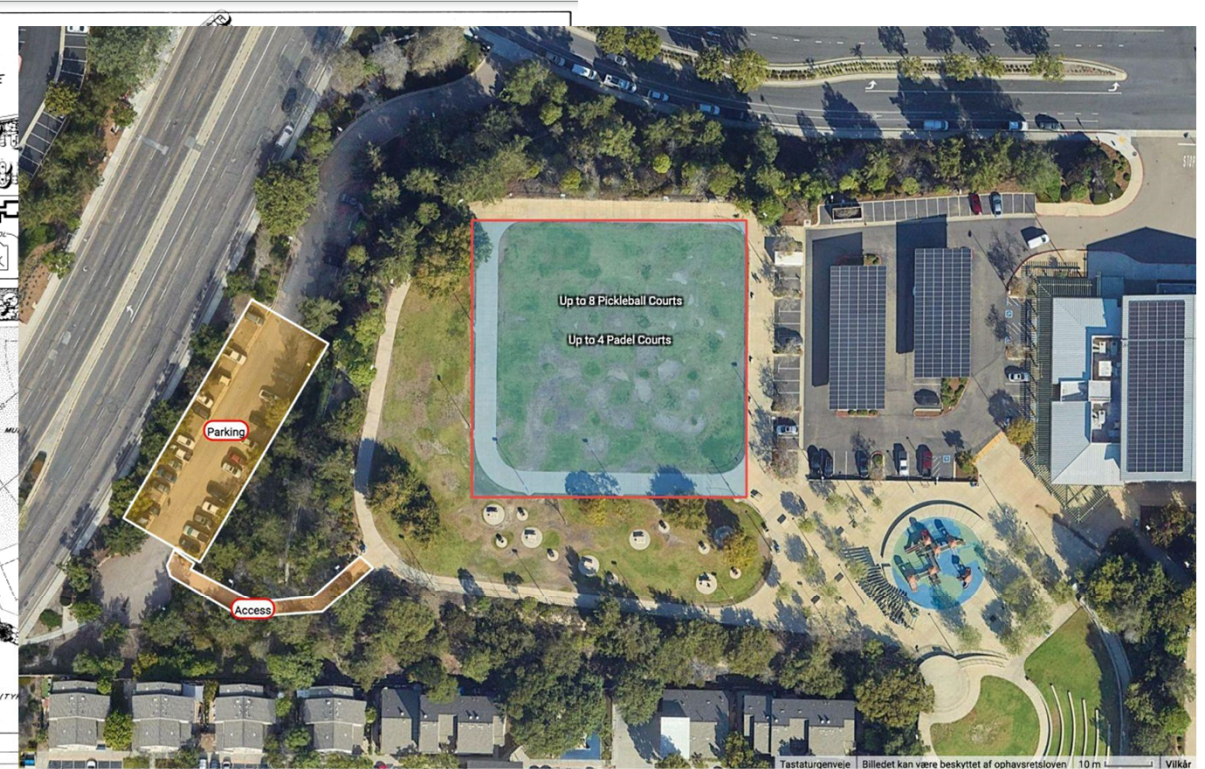

DATA LOG FOR		REFERENCE DOCUMENTS	DATE	ACTION
6-92	6-92	6-92	6-92	6-92
9-95	9-95	9-95	9-95	9-95
1-13	1-13	1-13	1-13	1-13

IMPROVEMENTS SUMMARY (DATA FROM AS-BUILT DRAWINGS)			
ITEM	QUANTITY	ITEM	QUANTITY
TOTAL SITE	19.11 AC	PLAY AREA	4,062 SF
IMPROVED AREA	19.76 AC	PAVED WALKS	104,377 SF
DRY	6.13 AC	PARK BENCHES	11
LANDSCAPE	6.19 AC	PARKING LOT	93,020 SF
OTHER LANDSCAPING	AC	STALLS SITE	179
SOFT INFRASTRUCTURE	73 AC	BECK	17,245 SF
		FOOT BALLS	2,527 SF
		WATER	1,575 SF
		LAWN LIGHTS	12
		VOLLEYBALL CT	4,000 SF

**CARMEL VALLEY
COMMUNITY PARK**

COUNCIL DIST NO 1 COMM PLAN AREA CARMEL VALLEY P.S.O. NO

LAWSUIT THOMAS BROS PG.1189, A-6 190

REVISION T.R. 9-23-96

Public Workshop Comment Summaries

January 9, 2024

- 40-50 community members in attendance, majority were there in support of pickleball & padel facilities
- Community members noted the following:
 - Facility should be publicly accessible and not a private facility
 - Facility should allow for inclusiveness of all levels of play & be suitable space for children
 - All courts should be lighted to allow for evening play
 - Court booking costs need to be reasonable
 - Some green space should be maintained in that section of the park
 - While indoor pickleball options are available, there are no outdoor pickleball or padel facilities in the Carmel Valley area (the sport is intended to be played on a hard court)
 - Court orientation needs to be kept in mind
 - Public restroom facilities should be easily accessible
 - Refreshment options would be a huge plus given existing facilities in San Diego typically have limited to no offerings
 - This area in the park is utilized currently by sports groups and for occasional community events (movie nights, birthday parties etc.)

March 12, 2024

Important Features

Social Area
 Courts for all levels
 Coaching
 Pro Shop
 Restroom Access
 On-court Seating
 Food & Beverage
 Fencing
 Designated Parking
 Viewing Areas
 Clinics / Lessons / Open Play
 Kid-Friendly / Summer Camps

Lacking Features at Other Facilities

Bad Layouts
 No Lessons / Coaching Available
 Not Enough Courts
 Not Enough Spacing Between Courts
 No Viewing Area or Seating
 Far Restroom Access
 Lack of Shade
 Overcrowded / No Management
 No Court Maintenance