

M 42

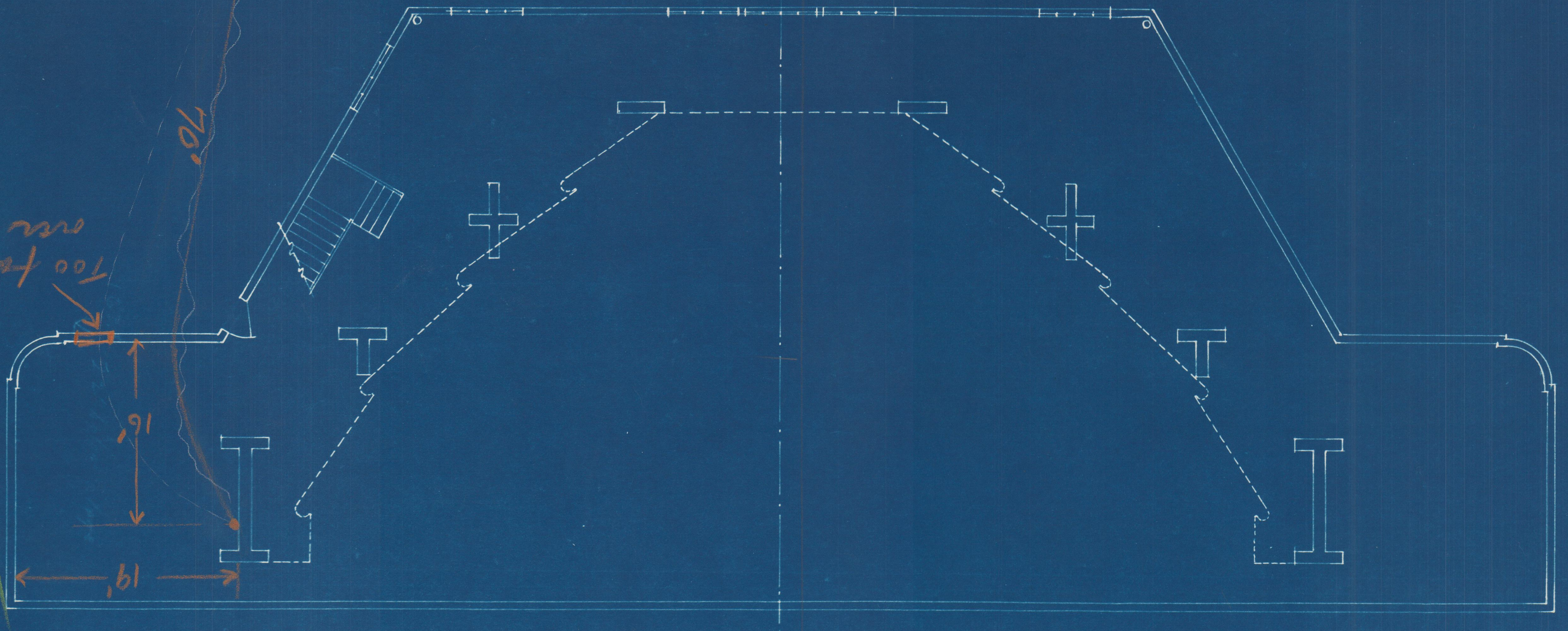

OF SHELL  
 • GROUND FLOOR PLAN •

Boxed out hole  
 in footing  
 2-3 1/2" Fibre  
 Secondary Conduit run  
 from Manhole to Bowl

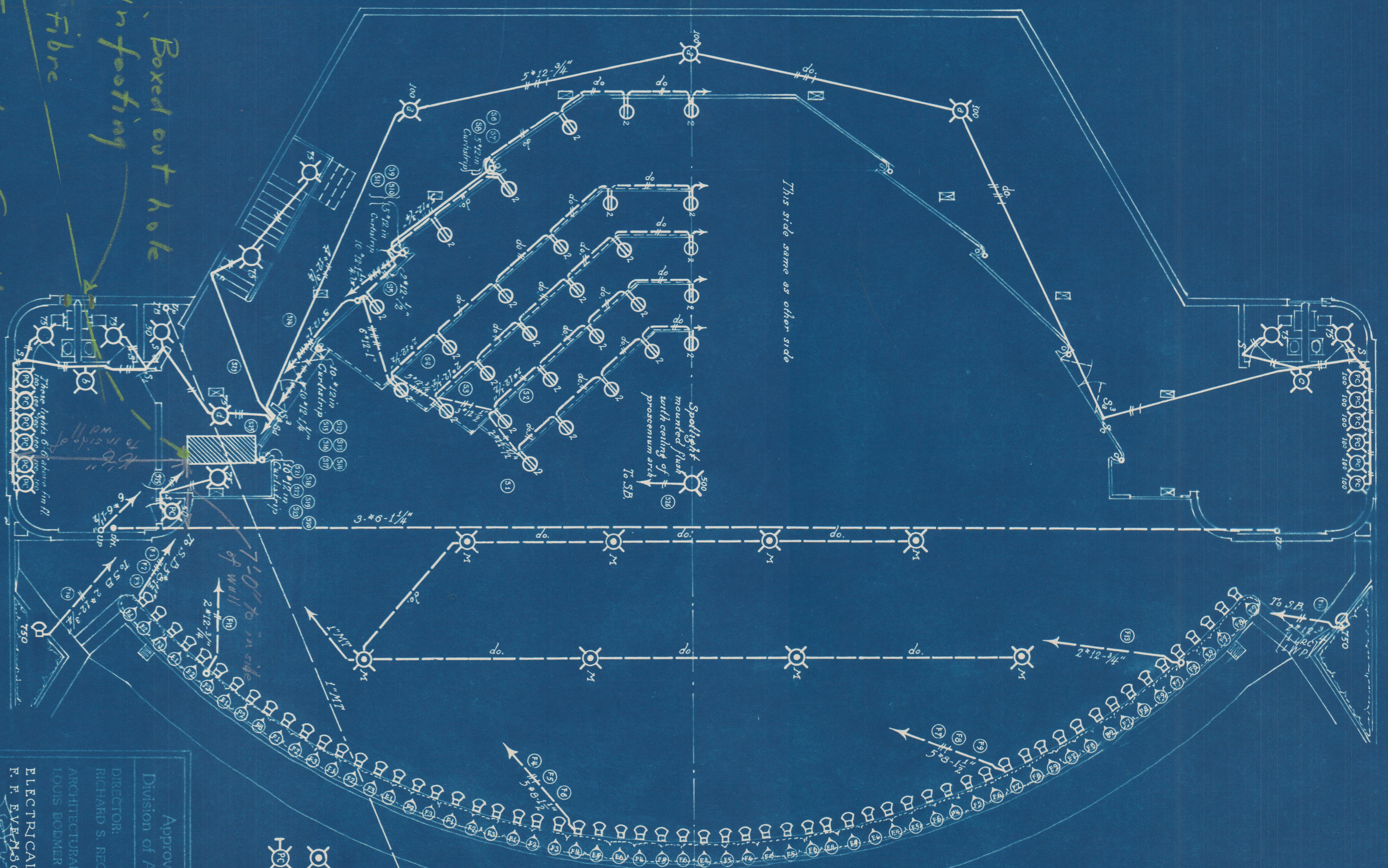

OF SHELL  
 STAGE FLOOR PLAN  
 SCALE 1/8" = 1'-0"

⊗ Microphone pickup outlet; ⓧ box with wire waterproof covers; flush mounted  
 ⊗ Bracket outlet with pull chain switch

Approved by  
 Division of Architecture  
 DIRECTOR: RICHARD S. RECQUA A.I.A.  
 ARCHITECTURAL SUPERVISOR  
 LOUIS BOMER  
 ELECTRICAL ENGINEER  
 F. F. EVENSON  
 DIRECTOR OF WORKS  
 H. H. BARBER

CALIFORNIA PACIFIC INTERNATIONAL EXPOSITION		1935
SAN DIEGO, CALIFORNIA		1935
MUSIC BOWL		
GROUND & STAGE FLOOR PLANS		
ELECTRICAL DEPT.		
Drawn by W.L.P.	Checked by F.F.E.	DATE
Traced by A.W.W.	F.F.E.	3-22-35
F. F. EVENSON ELECTRICAL ENGINEER		
DATE	SHEET	NO.
1935	2	G-57



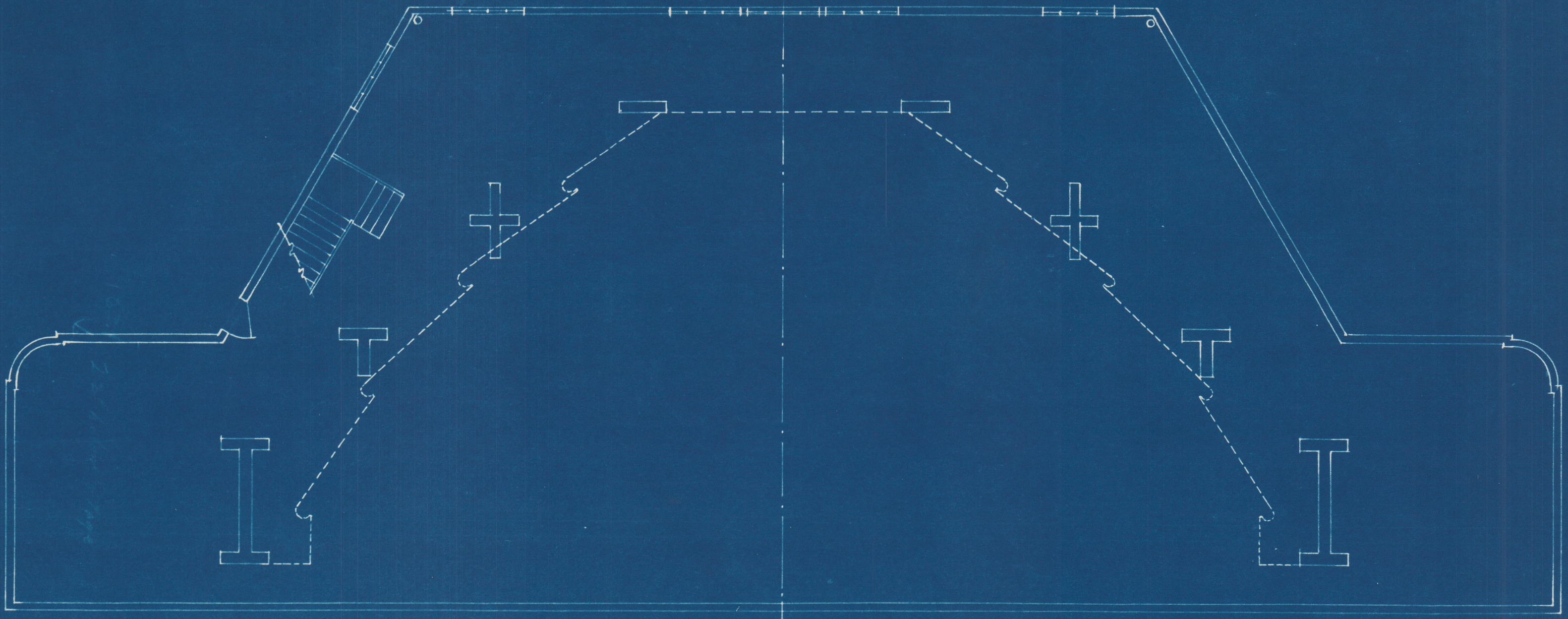

• GROUND FLOOR PLAN •

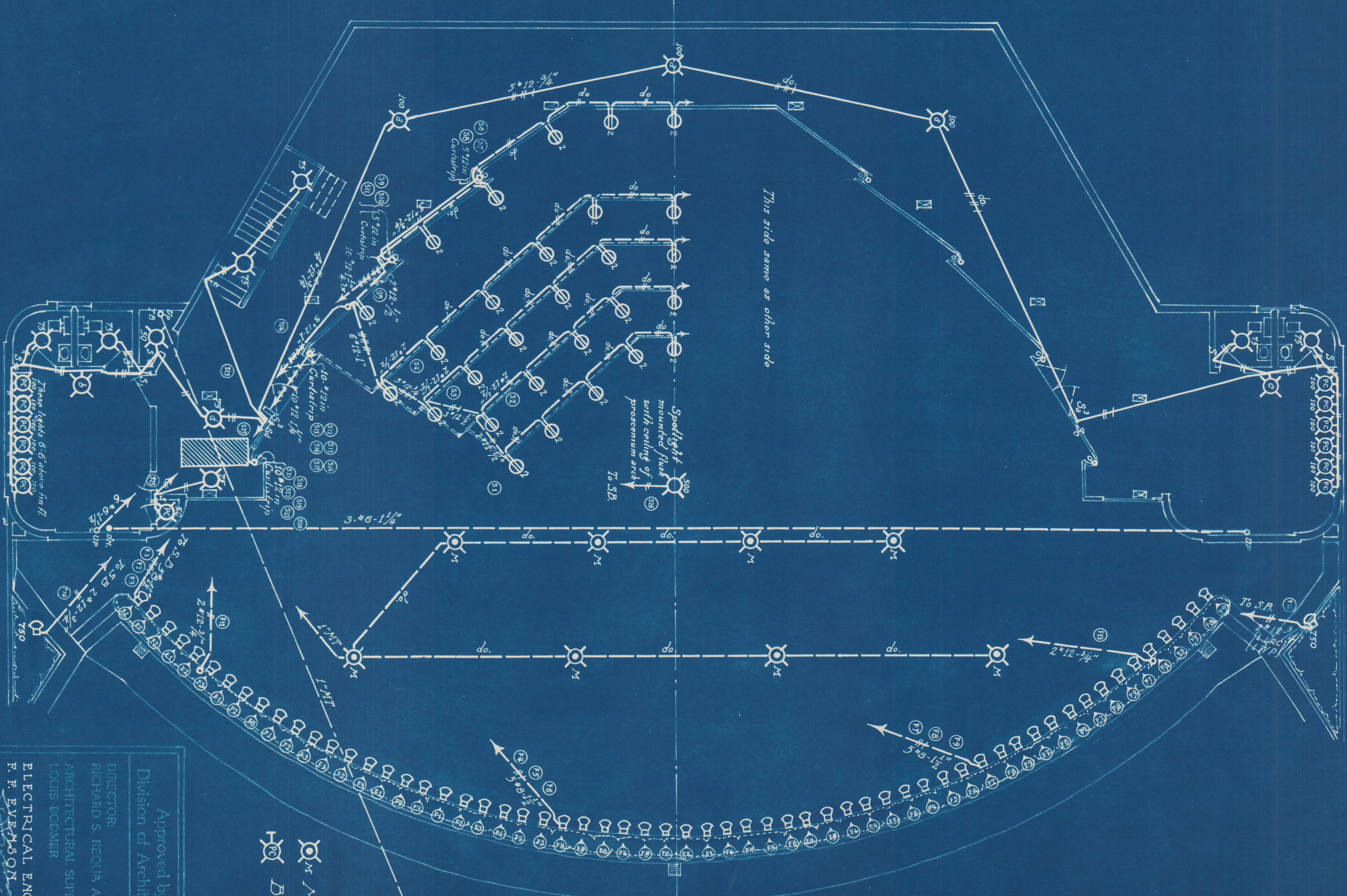

STAGE FLOOR PLAN  
SCALE 1/8" = 1'-0"

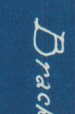
 Microphone pickup outlet; 4" box with waterproof covers; flush mounted.  
 Bracket outlet with pull chain switch.

D-366

Approved by  
 Division of Architecture  
 DIRECTOR: RICHARD S. REGUA A. I. A.  
 ARCHITECTURAL SUPERVISOR  
 EDGUS BOEMER  
 ELECTRICAL ENGINEER  
 F. F. EYENSON  
 DIRECTOR OF WORKS  
 H. H. BARTER

CALIFORNIA PACIFIC INTERNATIONAL EXPOSITION SAN DIEGO, CALIFORNIA		1935
<b>MUSIC BOWL</b> Ground & Stage Floor Plans		
Drawn by: WLP Traced by: AMW Checked by: F. F. EYENSON Date: 3-27-35	DIRECTOR: RICHARD S. REGUA A. I. A. ARCHITECT: LOUIS PODNER ARCHITECTURAL SUPERVISOR: EDGUS BOEMER ELECTRICAL ENGINEER: F. F. EYENSON	SHEET <b>2</b>