



THE CITY OF SAN DIEGO

MEMORANDUM

DATE: August 24, 2015

TO: The Balboa Park Committee  
Agenda of September 1, 2016

FROM: Bruce Martinez, Deputy Director, Park and Recreation Department

SUBJECT: Pershing Drive Bikeway General Development Plan

---

**SUMMARY**

**Issues** – Should the Balboa Park Committee:

1. Advise the proposed General Development Plan for the Pershing Drive Bikeway is consistent with the Balboa Park Master Plan (BPMP) Balboa Park East Mesa Precise Plan (EMPP); and
2. Recommend approval of the proposed General Development Plan for the Pershing Drive Bikeway Project?

**Department Recommendations**

1. Advise the proposed General Development Plan for the Pershing Drive Bikeway is consistent with the BPMP and EMPP; and
2. Recommend approval of the proposed General Development Plan for the Pershing Drive Bikeway Project.

**Other Recommendations**

On June 8, 2016 the Greater Golden Hill Planning Committee voted (9-0-2) to approve, in concept, consistent with the East Mesa Precise Plan, Climate Action Plan and Urban Forest with the requirement that to interface with the sidewalk on 26<sup>th</sup> Street and Pershing.

On June 21, 2016 the North Park Planning Committee voted (11-1-0) to support, in concept, the SanDAG Pershing Bikeway plan as being consistent with the mobility and sustainability goals of the North Park community plan and the City's Climate Action Plan.

**Fiscal Statement** – There is no fiscal impact associated with this action.

**Environmental Review** – The San Diego Association of Governments (SanDAG) as Lead Agency under the California Environmental Quality Act (CEQA) will prepare the required environmental document for this proposed project.

**Code Enforcement Impact** – None

**Housing Impact** - None

## **BACKGROUND**

Balboa Park is located immediately north of downtown San Diego. The Park is surrounded by the communities of Golden Hill, North Park, Uptown and Centre City. Balboa Park is one of the City's largest developed parks at 1,172 acres and is host to numerous passive and active recreational activities, cultural and educational institutions, and special events. Over 12 million visitors come to Balboa Park each year to enjoy the diversity of activities the Park has to offer.

Development, maintenance and management of Balboa Park are governed by the Balboa Park Master Plan, the Central Mesa Precise Plan, the East Mesa Precise Plan and subsequent amendments to those documents. The Balboa Park Master Plan is a part of the City's General Plan, and implements land use policies for Balboa Park. Therefore, amendments to the Master Plan and its Precise Plans must follow the Land Use and Community Planning Element of the General Plan.

The Balboa Park Master Plan (BPMP) was adopted by City Council on July 25, 1989 (Resolution No. R-274090). Subsequent amendments to the BPMP have been adopted by City Council on December 9, 1997 (R-289537); on May 4, 1998 (R-290039-1); on April 13, 2004 (R-299084-1); on September 21, 2004 (R299666); and on July 9, 2012 (R-307555-1). The Master Plan addresses the entirety of Balboa Park and provides general guidelines for development, maintenance and management.

The East Mesa Precise Plan (EMPP) was adopted by City Council on April 13, 1993 (Resolution R-281752). The EMPP addresses the eastern portion of Balboa Park in greater detail than does the BPMP.

Pershing Drive is technically a park road; the roadway was never dedicated as street right-of-way. However, the road serves as a Four Lane Major Road (two lanes each direction, San Diego Street Design Manual) connecting downtown San Diego with the community of North Park. Pershing Drive also provides access to the Interstate 5 North and South freeways. The posted speed limit for Pershing Drive is fifty miles per hour (50 MPH). Level of Service (LOS) D for this type of road is 35,000 Average Daily Trips (ADT). There is a Class II bike lane on either side of Pershing Drive.

The San Diego Bicycle Master Plan identifies Pershing Drive within Balboa Park as an existing Class 2 Bikeway, which is defined as a roadway with a separately striped but contiguous bike lane. However, the Master Plan does not identify improvements to this bikeway as a priority.

Earliest available improvement drawings of Pershing Drive are dated from 1922 and indicate a road width of twenty feet. Later drawings dated from 1933 indicate the widening of existing pavement to a total of approximately 40-50 feet (width varied). The overall alignment appears consistent with today's alignment. Drawings for the current configuration are not readily available; however, the current width varies between approximately 58 feet and 78 feet.

## **DISCUSSION**

### ***East Mesa Precise Plan***

The Circulation element of the EMPP, page III-19, states; "The East Mesa circulation should serve park users first, not commuters." The plan recommendations, page IV-101, indicate the high speed and peak volume of Pershing Drive are not compatible with recreational cross-traffic. The EMPP makes several recommendations to calm traffic on Pershing Drive to be more compatible with park use. These recommendations include:

- Reconfigure the intersection at Pershing and Upas
- Reconfigure the intersection at Pershing and Redwood
- Reconfigure the intersection at Pershing and Jacaranda
- Consider traffic control measures such as stop signs and/or stop lights
- Reconfigure Pershing Drive to include a landscaped median and bike lanes
- Rename Pershing Drive to Pershing Parkway

Cross-sectional drawings of Pershing Drive, page IV-103, indicate a landscaped median in the middle, two vehicular lanes northbound and southbound, and a Class II bike lane on either side of the road. This is consistent with the Four Lane Major Road design in the City's Street Design Manual.

### ***Project Description***

The San Diego Association of Governments (SanDAG) is proposing a project to provide a safer and contiguous bikeway between downtown San Diego and the community of North Park. A major portion of the project involves the reconfiguration of Pershing Drive within Balboa Park. Improvements are also contemplated for Upas Street and Utah Street to the north and 17<sup>th</sup> Street and 19<sup>th</sup> Street to the south. However, this report will focus on those portions of the project within Balboa Park

Pershing Drive south of 26<sup>th</sup> Street/Florida Drive serves as a primary on-ramp/off-ramp for the Interstate 5 freeway. Traffic volumes and speeds are high, and the area is not conducive to bicycle traffic. In this location the proposed project would install a separate two-way bike lane to the east of Pershing Drive. The bike lane would be separated from the roadway by a three foot wide paved median. A six foot wide sidewalk would be installed east of the bike lane. A

southbound one-way bike lane would be maintained on the west side of Pershing Drive and would be improved to include a striped buffer area and colored lane markings at areas where cars and bicycles may cross.

The width of Pershing Drive between 26<sup>th</sup> Street/Florida Drive and Upas Street varies from approximately 50 to 78 feet with a considerable “S” curve at the midpoint. The proposed project would reconfigure the road cross-section to include one vehicular lane in each direction; this is a reduction from the existing conditions and the proposed configuration in the EMPP. The landscaped median indicated in the EMPP would be shifted to separate the bicycle lanes from the vehicular lanes; there would be no median separating the vehicular lanes. The west side of Pershing Drive would have a single southbound bike lane separated from the vehicular lanes by a striped buffer zone. A two-way bike lane would be installed on the east side of Pershing Drive, including a separate five foot wide sidewalk and a five foot wide decomposed granite trail. Colored bike lane markings would be provided at all vehicular crossings.

The intersection of Pershing Drive and Redwood Street would be reconfigured to a traffic circle with pedestrian crosswalks. The traffic circle would have the effect of calming traffic and improving bicycle and pedestrian safety. This differs from the “T” intersection contemplated in the EMPP.

The intersection at Pershing Drive and Jacaranda Place would be reconfigured to a “T” intersection as contemplated in the EMPP. A pedestrian crosswalk would be provided at this intersection as well.

The intersection at Pershing Drive, Upas Street and 28<sup>th</sup> Street would be reconfigured slightly to create a cross intersection. Pedestrian crosswalks would be provided, as would colored bike lane markings. This reconfiguration occurs outside the boundary of Balboa Park.

The medians along Pershing Drive would be landscaped with trees and shrubs/groundcovers where width permits. Where medians are too narrow for landscaping, integral colored concrete will be used. Landscaping would be drought resistant, reflecting the character of the Florida Canyon habitat. The configuration of the landscaped median between the bike lanes and the vehicular lanes will make maintenance much easier and safer.

SanDAG has run traffic modeling scenarios using 2020 and 2035 projections that include the possible closure of Florida Drive between Zoo Place and Morley Field Drive as identified in the EMPP. Modeling suggests all roads within and around Balboa Park still operate at acceptable levels of service.

**CONCLUSION**

The EMPP identifies Pershing Drive as a roadway with vehicular lanes, bicycle lanes and a landscaped median. The land use for Pershing Drive will not change, only the specific configuration of the vehicular and bicycle lanes. The use of this roadway is consistent with the use intended in the Precise Plan and is consistent with the statement that park roads should serve park users first, not commuters. Changes to Pershing Drive should not impact other elements of the EMPP and should not have significant impact on the surrounding communities.

**ALTERNATIVES**

1. Advise the proposed General Development Plan for the Pershing Drive Bikeway is consistent with the BPMP and EMPP, and recommend approval with conditions; or
2. Do not advise the proposed General Development Plan is consistent with the BPMP and EMPP, and do not recommend approval of the proposed General Development Plan.

Respectfully submitted,



Bruce E. Martinez  
Deputy Director

BEM/cd

Attachments: Pershing Bikeway Project GDP

# Pershing Bikeway - North Park to Downtown





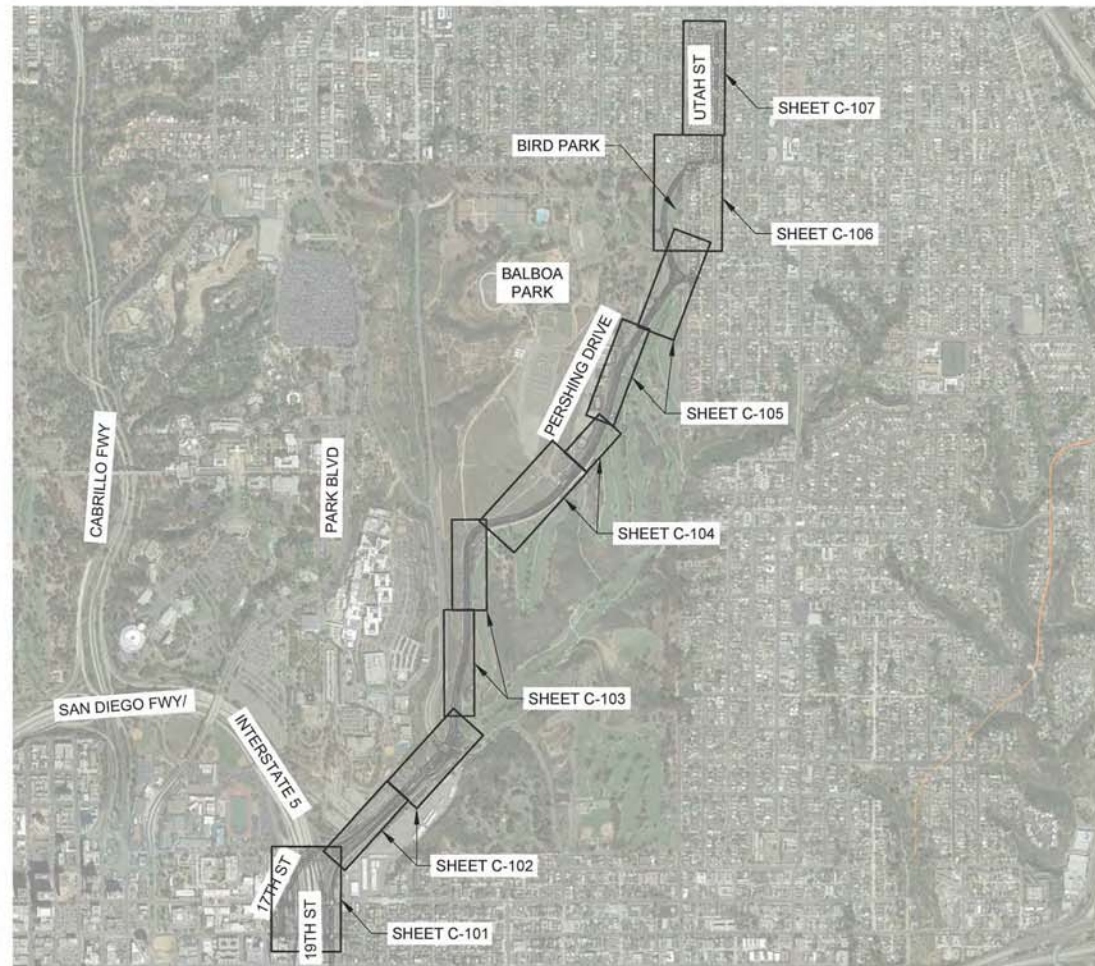



CIP 1223057

San Diego, California



LOCATION MAP  
SCALE: 1"=1000'

**LEGEND**

-  TWO-WAY SEPARATED BIKEWAY
-  D.G. PATH
-  CONCRETE PAVING
-  LANDSCAPING / BIO-FILTRATION AREA
-  RRFB
-  SIDEWALK
-  CURBLIN
-  RETAINING WALL
-  BIKE LANE BUFFER

**DRAWING INDEX:**

PLAN	SHEET NUMBER	#
TITLE SHEET	G-001	01
LAYOUT SHEETS	C-101 to C-107	02 to 08
TYPICAL SECTIONS	C-201 to C-202	09 to 10
PLANTING LEGEND	L-501	11

**CLIENT:**

SANDAG  
401 B Street, Suite 800  
San Diego, CA 92101  
619.699.1900

**PREPARED BY:**



233 A Street, Suite 703  
San Diego, California 92101  
p.619.269.5982



NOT FOR CONSTRUCTION

DESIGNED:	JJC	REVISIONS
REVIEWED:	LD, BJ	NO DATE ITEM
DRAWN:	JJC, LD	
PROJECT NO.:	2015-109	
DATE:	AUGUST 19, 2016	
SCALE:	FILE	

**alta**  
PLANNING + DESIGN  
www.altaplanning.com

233 A Street, Suite 703  
San Diego, California 92101  
p.619.269.5982



**Pershing Bikeway**

San Diego, CA

GENERAL DEVELOPMENT PLAN  
FOR PERSHING DRIVE  
TITLE SHEET

SHEET NO.  
**G-001**  
1 OF 11



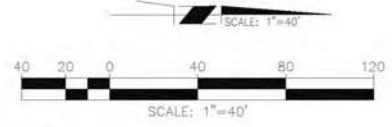
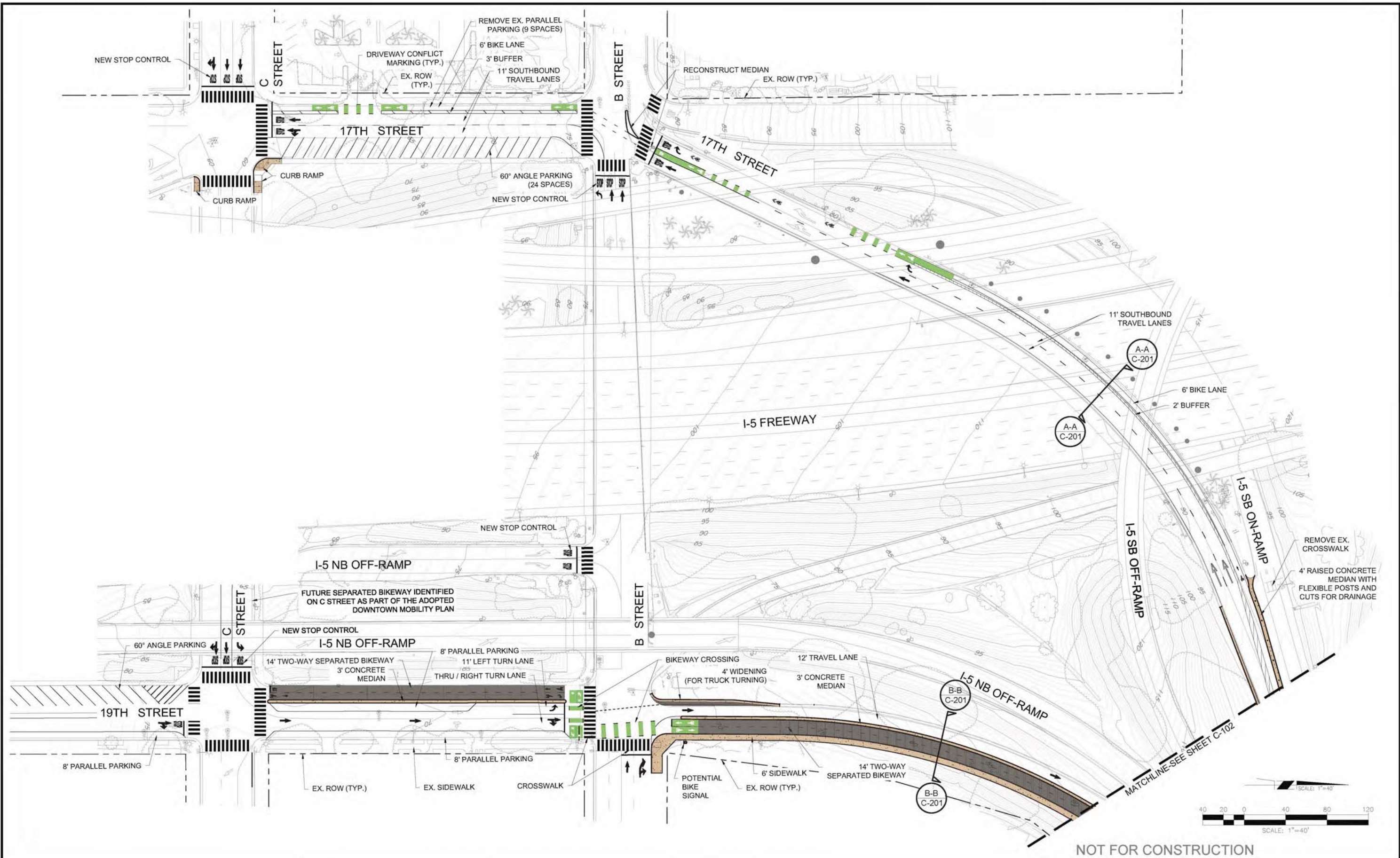

NOT FOR CONSTRUCTION

DESIGNED:	JJC	REVISIONS	
REVIEWED:	LD, BJ	NO	DATE
DRAWN:	JJC, LD	ITEM	
PROJECT NO.	2015-109	DATE	AUGUST 19, 2016
SCALE	FILE		

**alta**  
 PLANNING + DESIGN  
 www.altaplanning.com

233 A Street, Suite 703  
 San Diego, California 92101  
 p.619.269.5962

**SANDAG**

**GO byBIKE**

**Pershing Bikeway**

San Diego, CA

GENERAL DEVELOPMENT PLAN  
 FOR PERSHING DRIVE

**LAYOUT1**

SHEET NO.  
**C-101**

**2** OF **11**



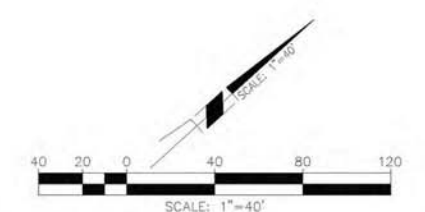
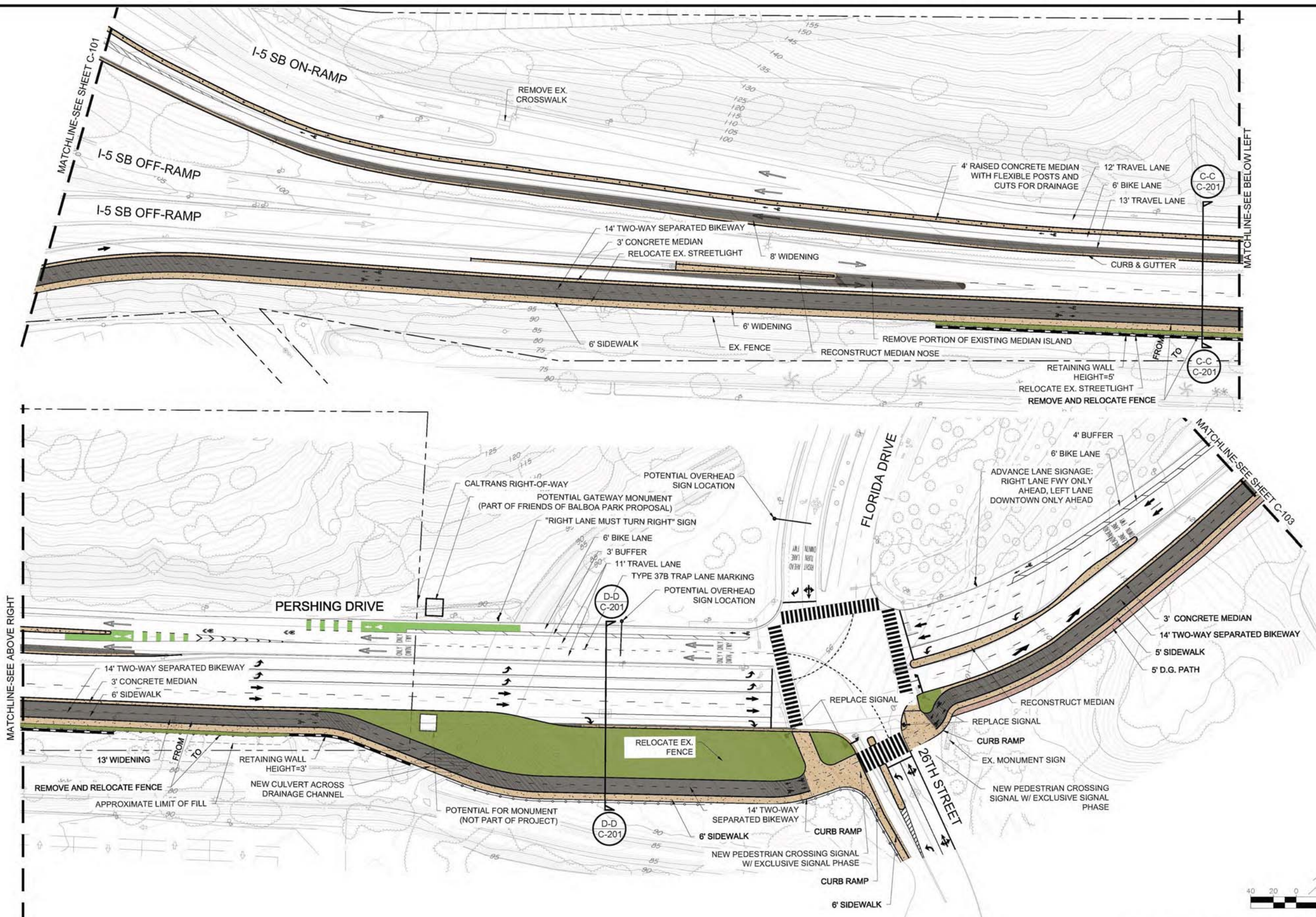

NOT FOR CONSTRUCTION

DESIGNED:	JJC	REVISIONS	
REVIEWED:	LD, BJ	NO	DATE
DRAWN:	JJC, LD	ITEM	
PROJECT NO.	2015-109		
DATE	AUGUST 19, 2016		
SCALE	FILE		

**alta**  
PLANNING + DESIGN  
www.altaplanning.com

233 A Street, Suite 703  
San Diego, California 92101  
p.619.299.5962

**SANDAG**

**GO byBIKE**

**Pershing Bikeway**

San Diego, CA

GENERAL DEVELOPMENT PLAN FOR PERSHING DRIVE

LAYOUT 2

SHEET NO. C-102

3 OF 11



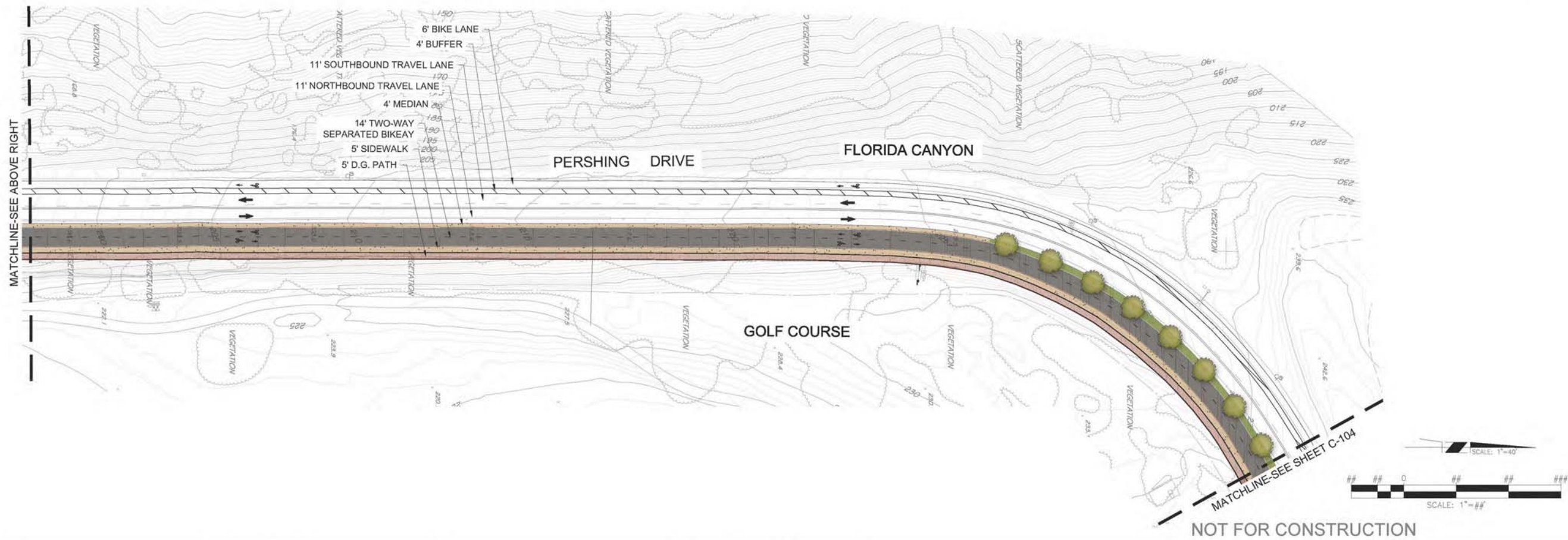
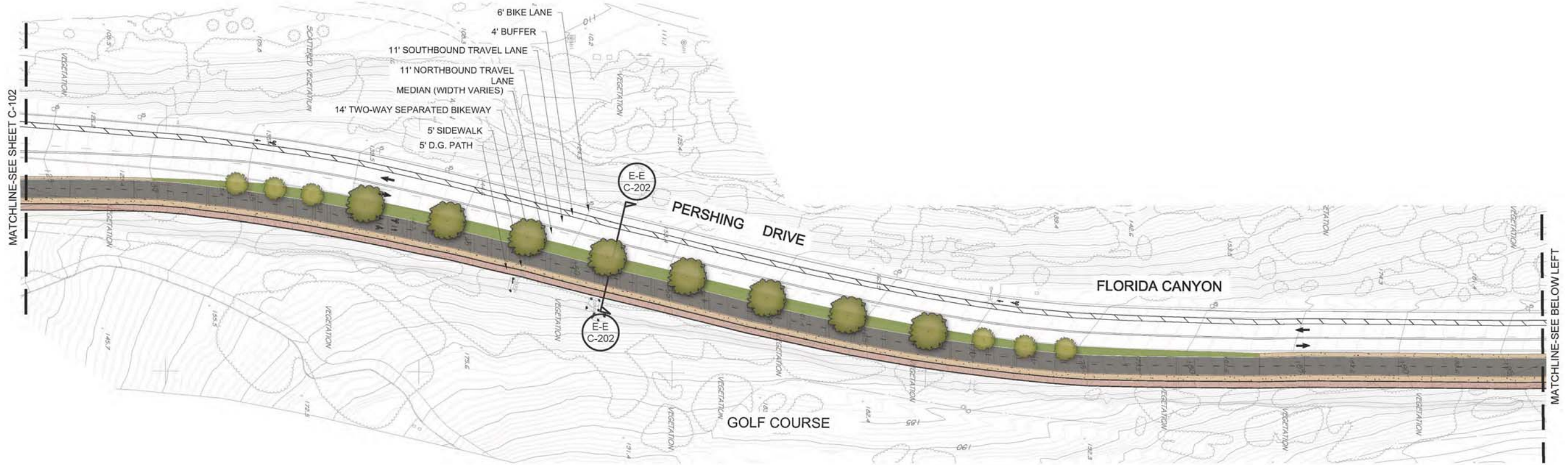

NOT FOR CONSTRUCTION

DESIGNED:	JJC
REVIEWED:	LD, BJ
DRAWN:	JJC, LD
PROJECT NO.:	2015-109
DATE:	AUGUST 19, 2016
SCALE:	FILE

REVISIONS		
NO.	DATE	ITEM



233 A Street, Suite 703  
San Diego, California 92101  
p 619.269.5982



### Pershing Bikeway

San Diego, CA

GENERAL DEVELOPMENT PLAN  
FOR PERSHING DRIVE  
LAYOUT 3

SHEET NO.  
**C-103**  
4 of 11



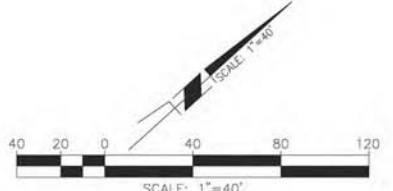

NOT FOR CONSTRUCTION

DESIGNED:	JJC	REVISIONS	
REVIEWED:	LD, BJ	NO	DATE
DRAWN:	JJC, LD	ITEM	
PROJECT NO.	2015-109		
DATE	AUGUST 19, 2016		
SCALE	FILE		



233 A Street, Suite 703  
San Diego, California 92101  
p 619 269 5982



**Pershing Bikeway**

San Diego, CA

GENERAL DEVELOPMENT PLAN  
FOR PERSHING DRIVE  
LAYOUT 4

SHEET NO.  
**C-104**  
5 OF 11



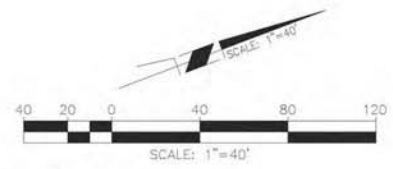
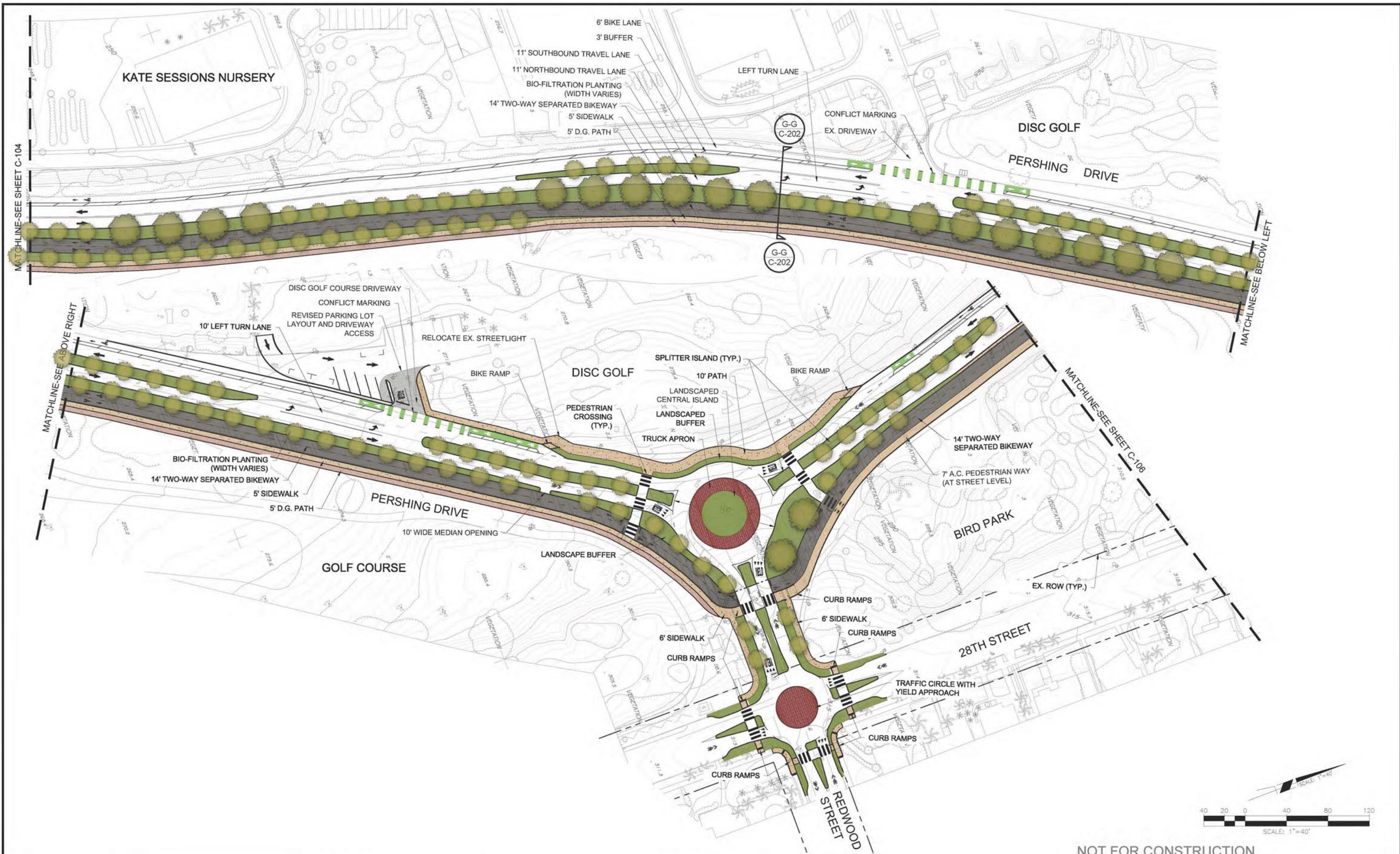

NOT FOR CONSTRUCTION

DESIGNED: JJC	REVISIONS
REVIEWED: LD, BJ	NO. DATE ITEM
DRAWN: JJC, LD	
2015-109 AUGUST 19, 2016	
PROJECT NO. DATE	
SCALE FILE	

**alta**  
 PLANNING + DESIGN  
 www.altaplanning.com

233 A Street, Suite 703  
 San Diego, California 92101  
 p. 619.269.5982



**Pershing Bikeway**

---

San Diego, CA

GENERAL DEVELOPMENT PLAN  
 FOR PERSHING DRIVE

**LAYOUT 5**

SHEET NO.  
**C-105**

6 of 11



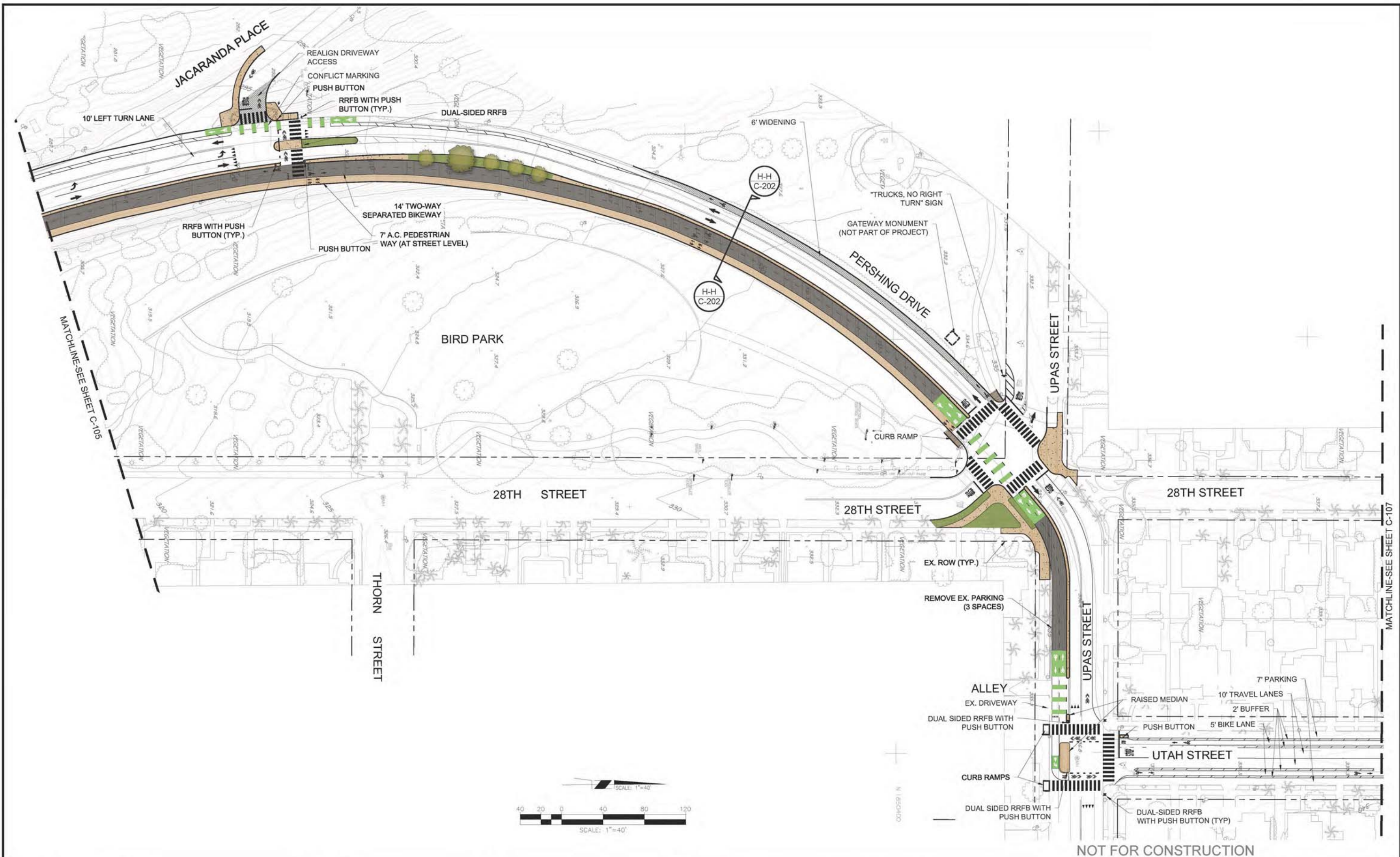

NOT FOR CONSTRUCTION

DESIGNED:	JJC
REVIEWED:	LD, BJ
DRAWN:	JJC, LD
PROJECT NO.:	2015-108
DATE:	AUGUST 18, 2016
SCALE:	FILE

REVISIONS		
NO.	DATE	ITEM

**alta**  
 PLANNING + DESIGN  
 www.altaplanning.com

233 A Street, Suite 703  
 San Diego, California 92101  
 p 619.269.5982

**SANDAG**

**GO byBIKE**

**Pershing Bikeway**

San Diego, CA

GENERAL DEVELOPMENT PLAN  
 FOR PERSHING DRIVE

**LAYOUT 6**

SHEET NO.  
**C-106**

7 OF 11



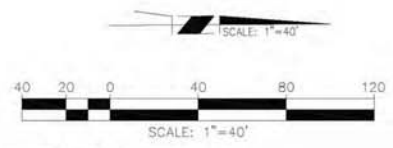
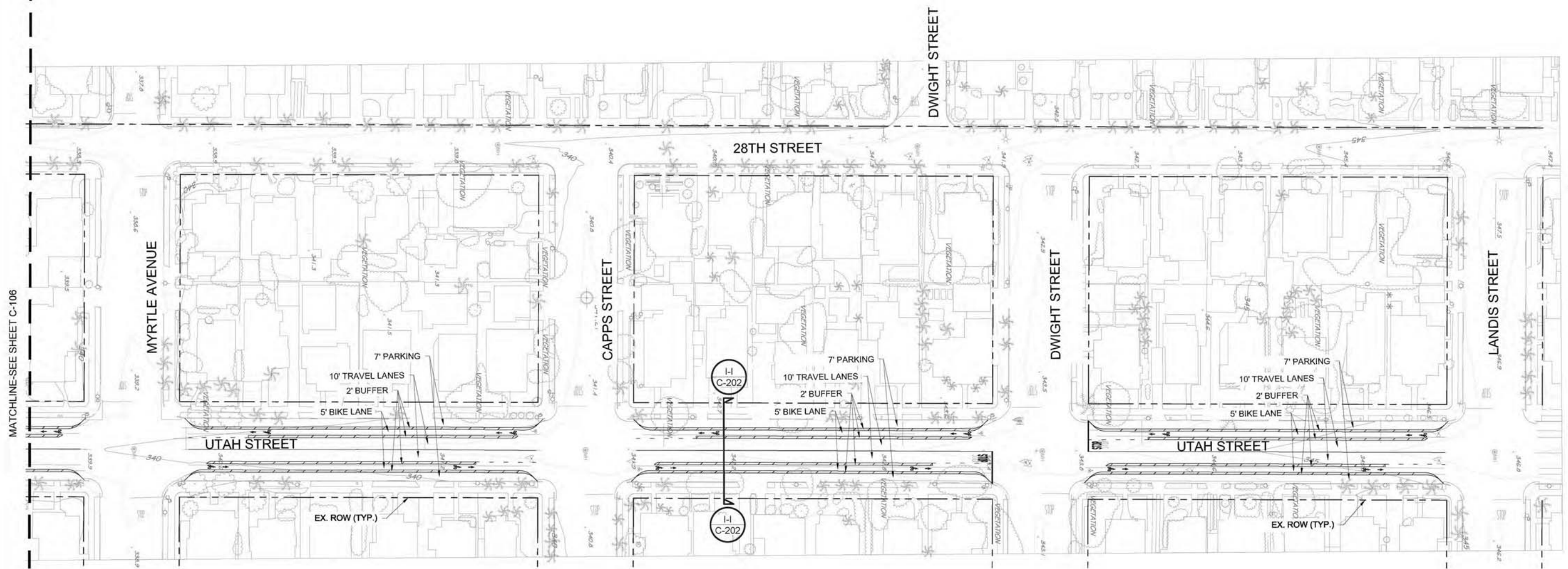

NOT FOR CONSTRUCTION

DESIGNED:	JJC	REVISIONS
REVIEWED:	LD, BJ	NO DATE ITEM
DRAWN:	JJC, LD	
PROJECT NO.:	2015-109	DATE
SCALE:	FILE	



233 A Street, Suite 703  
San Diego, California 92101  
p 619.269.5992



**Pershing Bikeway**

San Diego, CA

**GENERAL DEVELOPMENT PLAN  
FOR PERSHING DRIVE**

**LAYOUT 7**

SHEET NO.  
**C-107**  
8 of 11

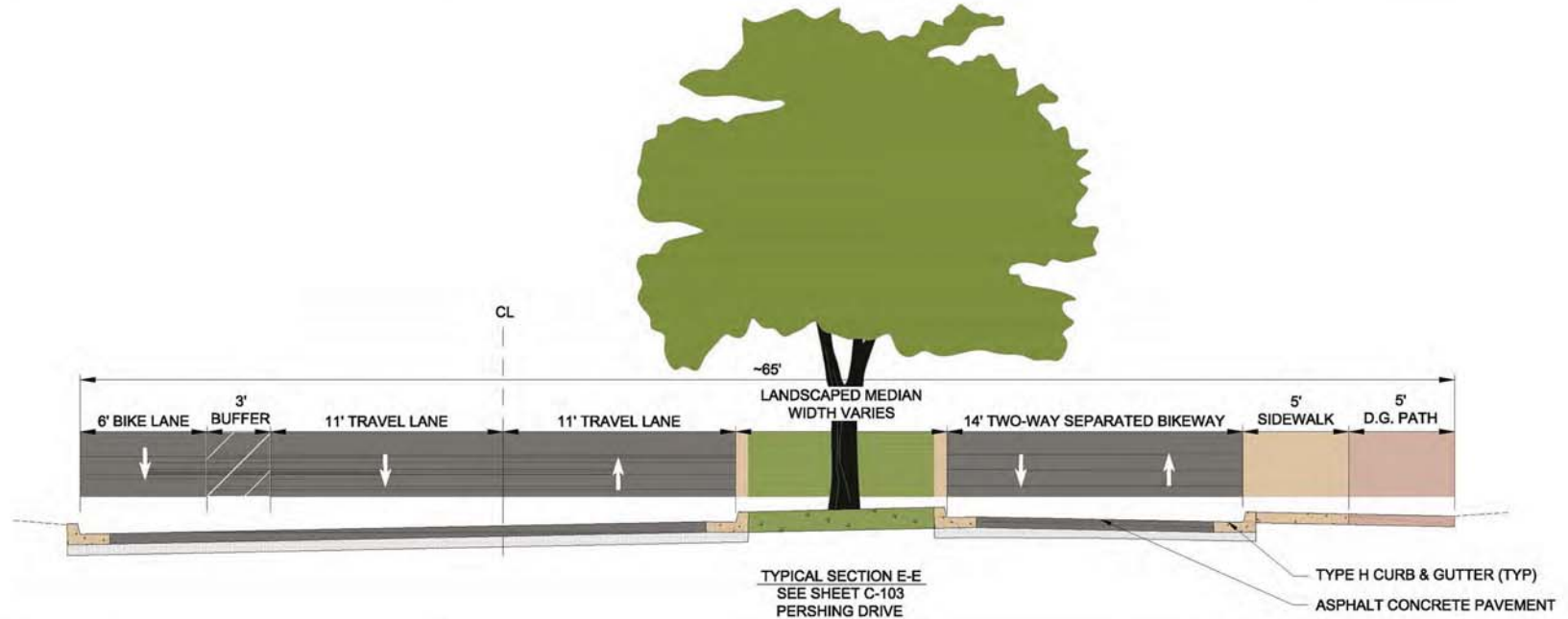
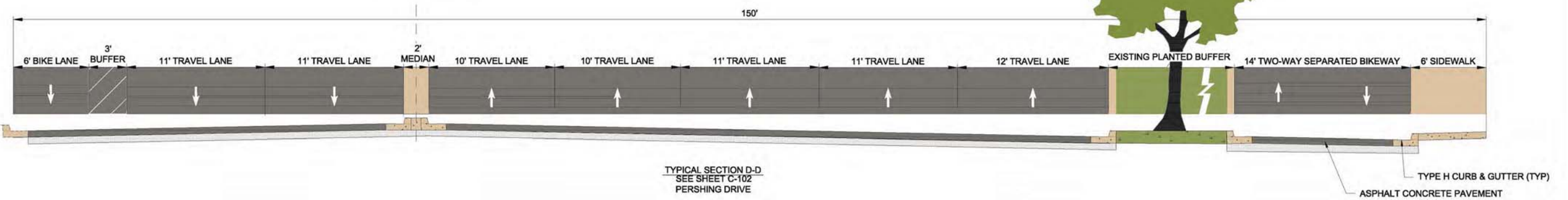
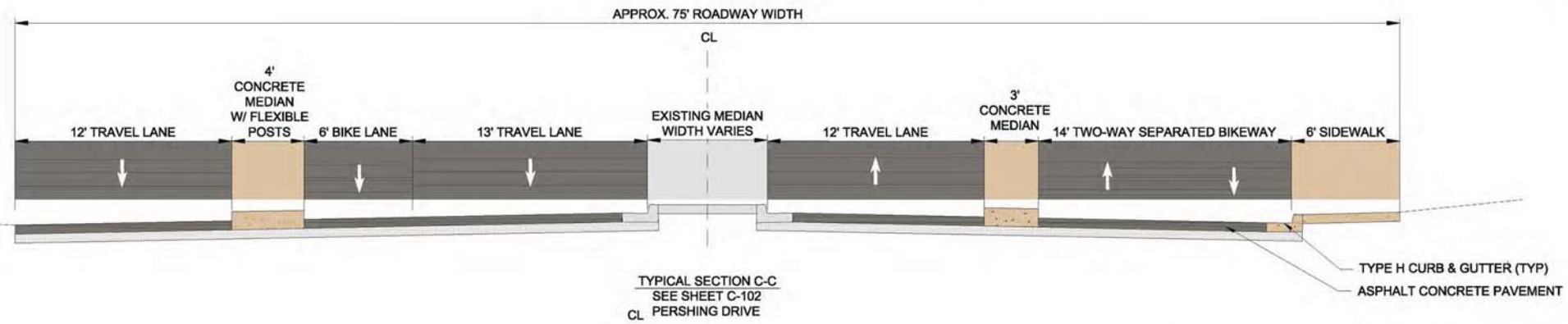
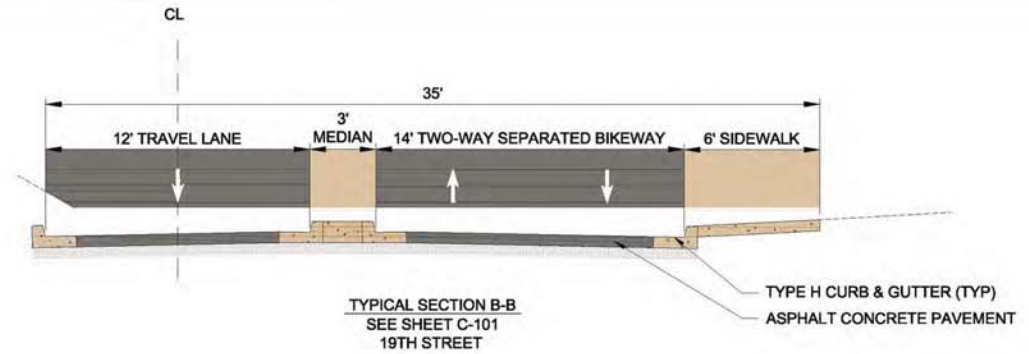
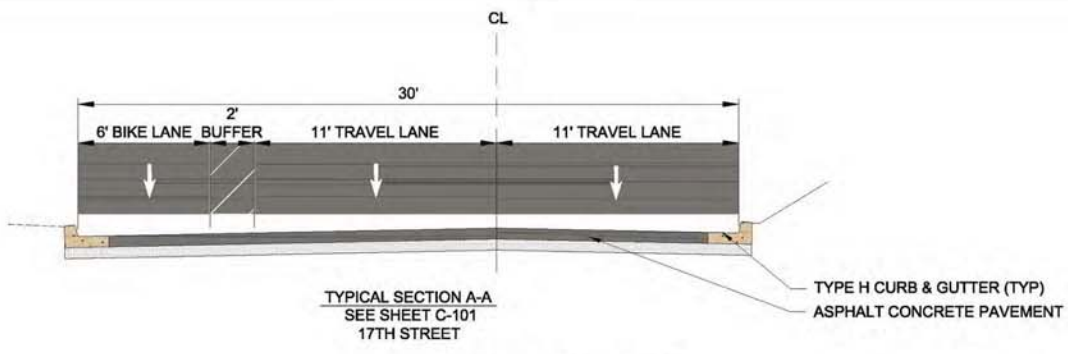

NOT FOR CONSTRUCTION

DESIGNED: JJC	REVISIONS
REVIEWED: LD, BJ	NO DATE ITEM
DRAWN: JJC, LD	
PROJECT NO. 2015-109	DATE AUGUST 19, 2016
SCALE	FILE



233 A Street, Suite 703  
San Diego, California 92101  
p. 619.269.5982



### Pershing Bikeway

San Diego, CA

GENERAL DEVELOPMENT PLAN  
FOR PERSHING DRIVE  
TYPICAL SECTIONS

SHEET NO.  
**C-201**  
09 OF 11



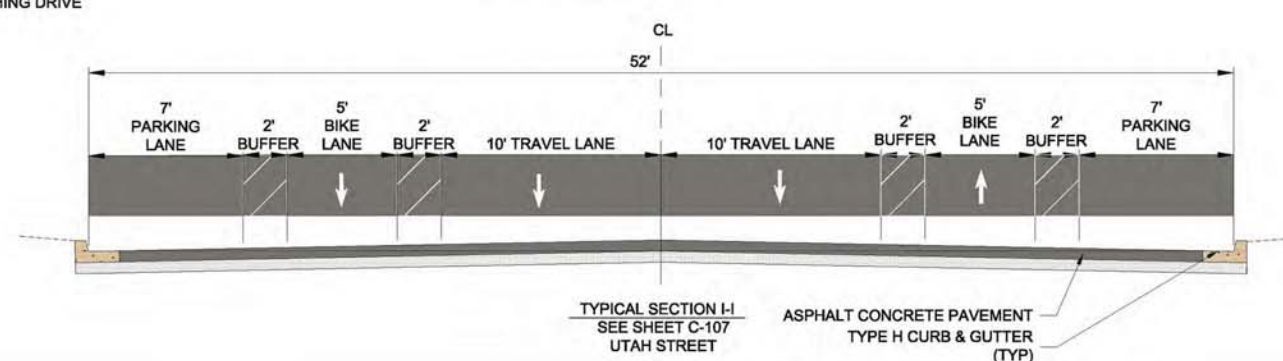
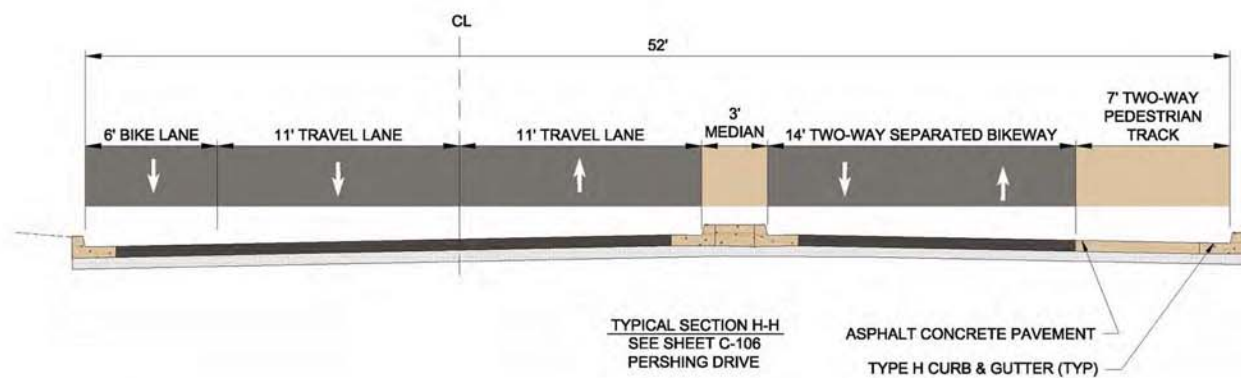
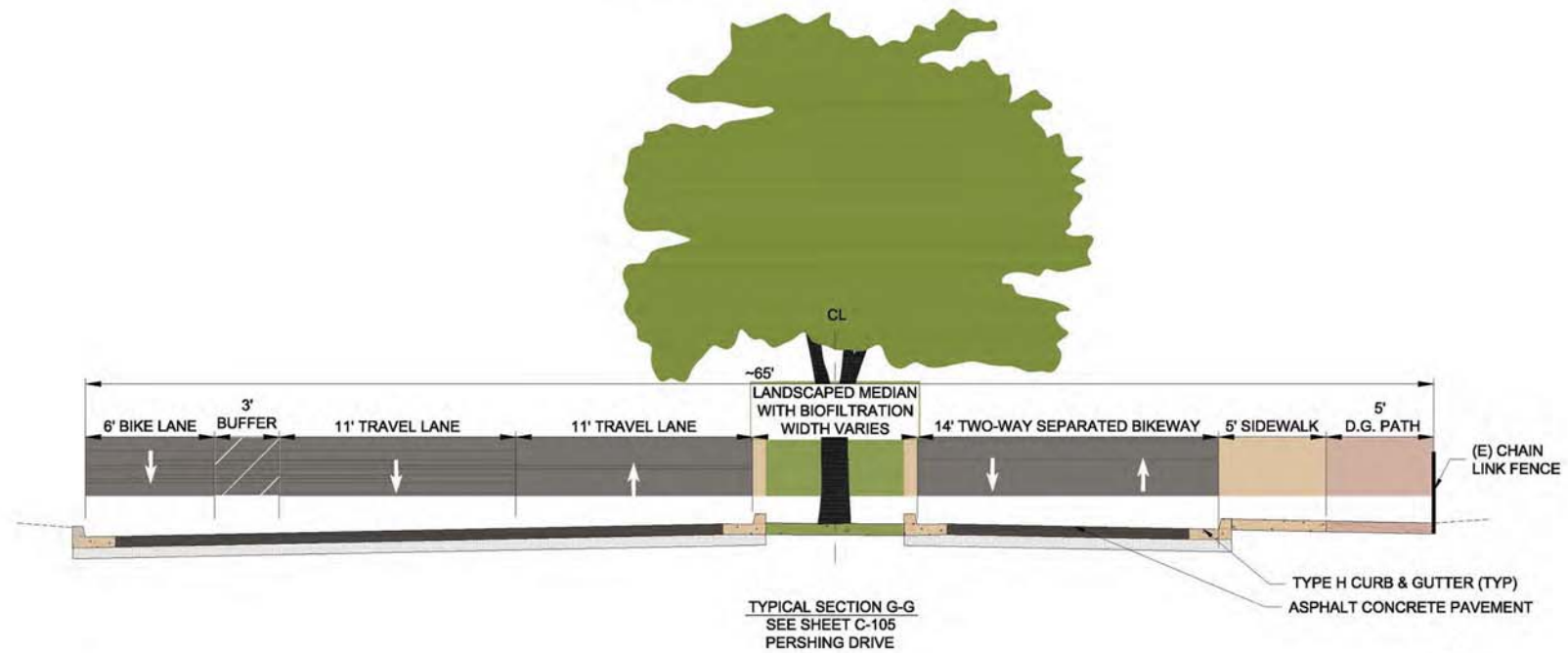
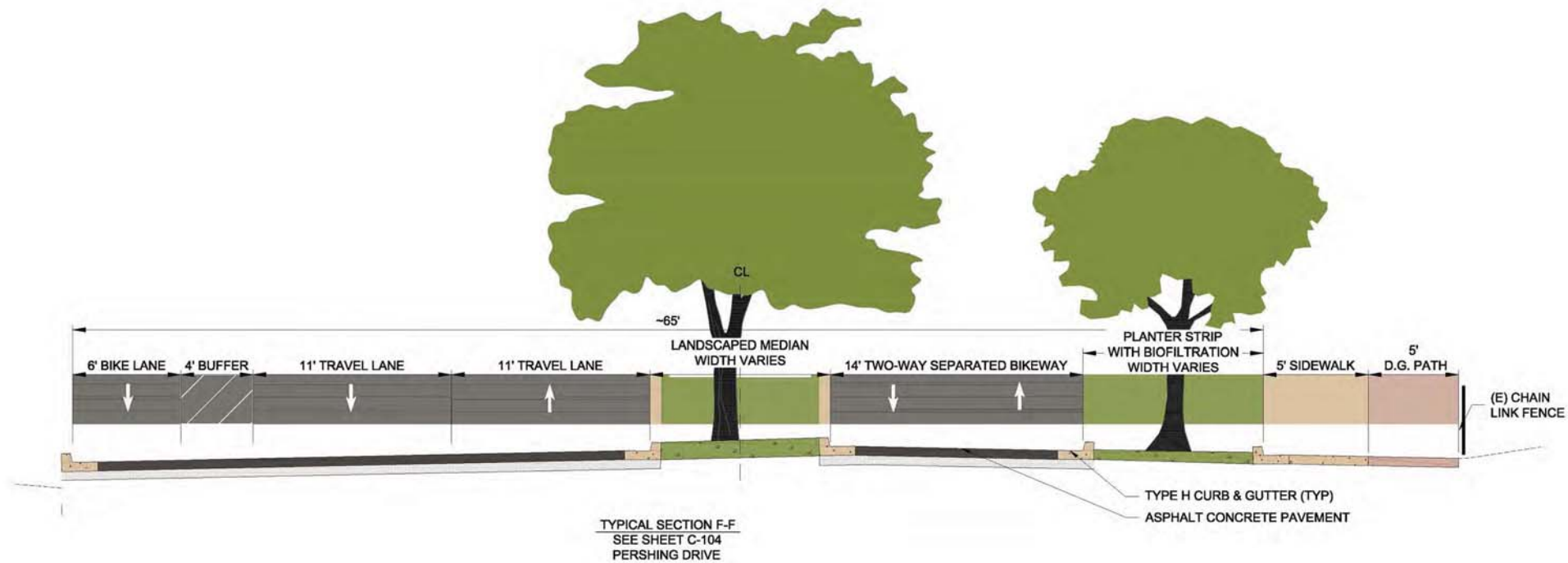

NOT FOR CONSTRUCTION

DESIGNED: JJC	REVISIONS
REVIEWED: LD, BJ	NO. DATE ITEM
DRAWN: JJC, LD	
2015-109 AUGUST 19, 2016	
PROJECT NO. DATE	
SCALE FILE	

**alta**  
PLANNING + DESIGN  
www.altaplanning.com

233 A Street, Suite 703  
San Diego, California 92101  
p. 619.269.5982



**Pershing Bikeway**

San Diego, CA

GENERAL DEVELOPMENT PLAN  
FOR PERSHING DRIVE  
**TYPICAL SECTIONS**

SHEET NO.  
**C-202**  
10 OF 11



## POTENTIAL TREE LIST

Botanical Name	Common Name	Litter	Drought	Native	Flower Color	Type
<b>Median Width 5'-7'</b>						
<i>Cercis occidentalis</i>	Western Redbud	Medium	Yes	Yes	Pink	D/F
<i>Melaleuca quinquenervia</i>	Cajuput Tree	Medium	Yes	No	White	E/F
<i>Metrosideros excelsus</i>	New Zealand Christmas	Medium	Yes	No	Red	E/F
<i>Quercus ilex</i>	Holly Oak	Medium	Yes	No	No	E
<i>Tabebuia ipi</i>	Pink Trumpet	High	Yes	No	Pink	D/F
<b>Median width 7'-10'</b>						
<i>Arbutus 'Marina'</i>	Marina Madrone	High	Yes	Yes		E
<i>Calocedrus decurrens</i>	Incense Cedar	Low	Yes	Yes		E
<i>Platanus 'Columbia'</i>	London Plane Tree	High		No		D
<b>Median Width 12'-18'</b>						
<i>Pinus torreyana</i>	Torrey Pine	Medium	Yes	Yes		E
<i>Quercus agrifolia</i>	Coast live Oak	Medium	Yes	Yes		E

## POTENTIAL PLANT LIST

Botanical Name	Common Name	Zone: A (Above ponding area) or B (ponds in storm events)	Native	Flower Color	Height	Width
<b>Biofiltration plantings</b>						
<i>Achillea millefolium</i>	Common Yarrow	B	Yes	White	2'	2'
<i>Carex pansa</i>	California Meadow Sedge	A,B	Yes	Tan	8"	1"
<i>Carex spissa</i>	San Diego Sedge	A	Yes	Tan	3-4'	2-3'
<i>Chondropetalum lectorum</i>	Small Cape Rush	A,B	No	Brown	2-3'	3-4'
<i>Fragaria chiloensis</i>	Beach Strawberry	B	Yes	White	4"	1"
<i>Juncus patens</i>	California Grey Rush	A,B	Yes	Brown	2'	2'
<i>Leymus condensatus</i>						
'Canyon Prince'	Canyon Prince Wild Rye	B	Yes	Wheat	2-3'	2-3'
<i>Muhlenbergia dubia</i>	Mexican Muhly	B	No		1-3'	1-3'
<b>Native shrubs and perennials</b>						
<i>Achillea millefolium</i>	Common Yarrow		Yes	White	2'	2'
<i>Arctostaphylos densiflora</i>			Yes	White	6-10'	6-12'
'Howard McMinn'	Howard McMinn Manzanita		Yes	White	6-8'	4-5'
<i>Carpenteria californica</i>	Bush Anemone		Yes	Purple	5-6'	6'
<i>Ceanothus 'Concha'</i>	Concha' California Lilac		Yes	Yellow	8'	6'
<i>Dendromecon harfordii</i>	Channel Island Bush Poppy		Yes	White to Pink	1-3'	5'
<i>Eriogonum fasciculatum</i>			Yes			
'Dana Point'	Dana Point Buckwheat		Yes			
<i>Frangula californica</i>			Yes			
'Mound San Bruno'	Coffee Berry		Yes		2-4'	10'
<i>Viguiera laciniata</i>	San Diego Sunflower		Yes	Yellow	2'	2'
<i>Cistus species</i>	Rockrose		Yes	Pink		
<i>Grevillea species and hybrids</i>			Yes	Pink		
<i>Leucophyllum species</i>			Yes	Purple		
<i>Mahonia aquifolium N</i>	Oregon Grape		Yes	Yellow		
<i>Myrtus communis</i>			Yes	White		
'Compacta'	Dwarf Myrtle		Yes	Blue		
<i>Rosmarinus officinalis</i>	Rosemary		Yes	Blue		
<i>Westringia fruticosa</i>	Coast Rosemary		Yes	Pink		
<i>Muhlenbergia capillaris</i>	Pink Muhly Grass		Yes	Pink		
<i>Phormium tenax and some species and hybrids</i>	New Zealand Flax		Yes	Varies		
<i>Anigozanthos species and hybrids</i>			Yes	Varies		
<i>Kangaroo Paw</i>			Yes	Varies		
<i>Encelia californica, N</i>	California Sunflower		Yes	Yellow		
<i>Osteospermum fruticosum</i>	Trail African Daisy		Yes	Pink		
<i>Mimulus, Native species and hybrids</i>	Monkey Flower		Yes	Orange		
<i>Penstemon heterophyllus, N</i>			Yes	Blue		
<i>Penstemon parryi, N</i>	Foothill Penstemon		Yes	Pink		
<i>Penstemon spectabilis, N</i>	Parry's Beardtongue		Yes	Pink		
	Showy Penstemon		Yes	Orange/Red		
<i>Salvia Africana lutea</i>	Dune Sage		Yes	Blue		
<i>Salvia chamaedryoides</i>	Germander Sage		Yes	Blue		
<i>Salvia clevelandii, N</i>	Cleveland Sage		Yes	Blue		
<i>Salvia leucantha</i>	Mexican Bush Sage		Yes	Pink		
<i>Salvia greggii</i>	Autumn Sage		Yes	Pink		
<i>Lavandula dentata</i>	French Lavender		Yes	Purple		
<i>Verbena peruviana</i>	Peruvian Verbena		Yes	Purple		
<i>Lavandula stoechas</i>	Spanish Lavender		Yes	Purple		
<b>Groundcovers</b>						
<i>Arctostaphylos glandulosa ssp. crassifolia</i>	Del Mar Manzanita		Yes	Purple	1'	
<i>Fragaria chiloensis</i>	Beach Strawberry		Yes	White	4"	
<i>Ceanothus Griseus</i>			Yes	Purple	2-3'	1'
'Yankee Point'	Yankee Point Ceanothus		Yes	Rose	2-3'	
<i>Salvia leucophylla 'Point Sal'</i>	Point Sal Purple Sage		Yes	Pink	2-3'	2'
<i>Ceanothus griseus horizontalis species and hybrids, N</i>			Yes	Blue	8-10'	
<i>Carmel Creeper</i>			Yes	Pink	8-10'	
<i>Lantana montevidensis</i>	Trailing Lantana		Yes	Blue		
<i>Rosmarinus officinalis 'Huntington Carpet'</i>	Huntington Carpet Rosemary		Yes	Blue		
<i>Rosmarinus officinalis 'Lockwood de Forest'</i>	Lockwood de Forest		Yes	Blue		
<i>Thymus pseudolanuginosus</i>	Woolly Thyme		Yes	Pink		

### SMALL WIDTH MEDIAN TREES

CERCIS OCCIDENTALIS



MELALEUCA QUINQUENERVIA



METROSIDEROS EXCELSUS



TABEBUIA IPE



### GROUNDCOVERS

ARCTOSTAPHYLOS GLANDULOSA SSP. CRASSIFOLIA



### MEDIUM WIDTH MEDIAN TREES

ARUBUTUS 'MARINA'



CALOCEDRUS DECURRENS



PLATANUS 'COLUMBIA'



CEANOTHUS GRISEUS 'YANKEE POINT'



### LARGE WIDTH MEDIAN TREES

PINUS TORREYANA



QUERCUS AGRIFOLIA



SALVIA LEUCOPHYLLA 'POINT SAL'



### BIOFILTRATION PLANTING

CAREX SPISSA



ACHILLEA MILLEFOLIUM



### NATIVE SHRUB AND GRASS MIX

CEANOTHUS 'CONCHA'



FRANGULA CALIFORNICA 'MOUND SAN BRUNO'



VIGUIERA LACINIATA



NOT FOR CONSTRUCTION

DESIGNED: JJC  
 REVIEWED: LD, BJ  
 DRAWN: JJC, LD  
 2015-109 AUGUST 19, 2016  
 PROJECT NO. DATE  
 SCALE FILE

REVISIONS		
NO.	DATE	ITEM



233 A Street, Suite 703  
 San Diego, California 92101  
 p.619.269.5982



Pershing Bikeway

San Diego, CA

GENERAL DEVELOPMENT PLAN  
 FOR PERSHING DRIVE

PLANTING LEGEND

SHEET NO.

L-501

11 OF 11