

Information Priority List For Individuals Presenting Special Event Proposals To the Balboa Park Committee: Presentations Will Be Limited to 5 Minutes

1. Name of Event – Esri User Conference Party
2. When –
 - a. Date(s) – Thursday, July 12, 2018
 - b. Time (including Set-up & Break-down)-
Event time: July 12, 2018 5pm-10pm
Set up: & Wednesday, July 11, 2018: 7pm-10pm and -Thursday, July 12, 2018: 8am – 5pm
Load out: Thursday, July 12, 2018 by 11:59pm (except dumpsters picked up on July 13, 2018 by 12 pm)
- c. During the Moratorium (Memorial Day – Labor Day) - Yes
3. Where (Provide map(s) showing location & site plan) – Botanical Lawns, Patio B, Bea Evenson Fountain, Cascades, El Prado, Plaza de Panama
 - a. Road Closure(s)- No
 - b. Parking Lot Closure(s)- Casa de Balboa Parking Lot: 21 stalls Monday, July 9th- Thursday, July 12th for catering trucks, Botanical Building Parking Lot: 3 stalls in the for vendor loading/unloading July 12th, Pepper Grove North Lot: 3 stalls for vendor loading/unloading July 12th
 - c. Bridge Closure- No
4. Estimated Attendance – 12,000
5. Amplified Music – Yes
 - a. Other prolonged noise impacts? No
 - b. Acts on a local or national level? Local
 - c. When do you plan to conduct event sound checks? 3-5pm
6. Do you plan to apply for an Alcohol Permit? Yes, alcohol will be served in the museum venues under existing alcohol contracts. Will be seeking to have alcohol in Patio B
7. Partnering with a park entity? Yes
 - a. Which one(s)? the San Diego Museum of Art, The San Diego Natural History Museum, Prado Restaurant, Reuben H. Fleet Science Center, Museum of Photographic Arts, Model Railroad Museum, and the History Center
8. Public Benefit Non-Profit? No
9. Have completed noticing Park Institutions? I have spoken with all groups who we will be contracting with and have notified the BPCP.
10. Are there performances at the:
 - a. Old Globe – Yes, (the Old Globe has been notified. In previous years we have been able to successfully mitigate their concerns and work closely with them to make sure the event did not pose a noise issue to their patrons. This year the Sculpture Garden will not be used, which should alleviate any noise concerns. In addition all ESRI staffers will not park in the Alcazar Lot and majority attendees arrive by bus.

b. Organ Pavilion – Yes, Twilight Concerts 6:15-7:15pm

11. Other special event of more than 500 people occurring concurrently? No

a. Location(s) in the Park:

12. Will you be making a donation to Balboa Park, a facility or institution located in the Park or outside the Park? No

a. How much – NA

b. Who – NA

13. Other unique event feature not covered above? This event was previously held in Balboa Park 2011-2014 and 2016-17.

Mingei Museum

- Assorted Seafood
- Special Exhibit
- Entertainment

The NAT

- Desserts
- Special Exhibits
- Entertainment

Plaza de Panama

- Pub Fare
- Entertainment
- Giant Games

Casa de Balboa

- Assorted Seafood
- Museum of Photographic Arts (MoPA)
- Special Exhibits
- Entertainment

- Spanish Cuisine
- Entertainment

Botanical Lawns

- Pub Fare
- Entertainment

SD Museum of Art

- Dessert & Coffee
- Entertainment

Patio B

- Aged 21 and over only
- Pub Fare
- Entertainment

Cascades Fountain

- Street Fare
- Entertainment

- Kid-friendly food
- Special Exhibit
- Entertainment



Tour a variety of world-class museums and enjoy live music, performances, and cuisine from around the globe along El Prado walkway and at each venue.

Main Stage

Red Hot Band + DJ

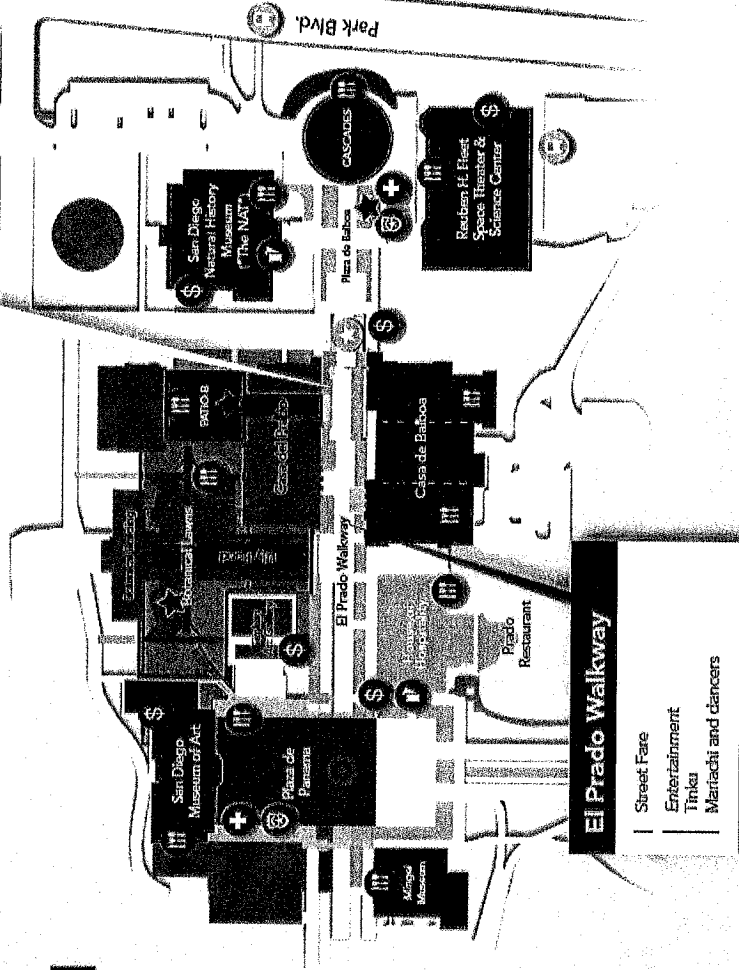

- Shuttle Load/Unload
- Security/Lost and Found
- First Aid
- Restrooms are located in every building
- Food
- ATM
- On-site Ticket Sales
- Main Stage
- Small Stage



Mini Menu

- Mingei Museum
- Shrimp Cocktail
- Sliced Ahi Sashimi
- Ceviche

- Plaza de Panama
- Fish 'n' Chips
- Lasagna
- Pizza

- House Hospitality
- Paelia
- Tortilla Espanol
- Potato Bravas

- Botanical Lawns
- Fish 'n' Chips
- Lasagna
- Pizza

- Patio B
- Fish 'n' Chips
- Lasagna + Veggie Lasagna
- Pizza

- El Prado Walkway
- Kettle Corn Action Station
- Frozen Chocolate Dipped Bananas
- Water + Lemonade

- Casa de Balboa
- Shrimp Cocktail
- Sliced Ahi Sashimi
- Ceviche

- Cascades Fountain
- Mini Corn Dog Bites
- Chili and Veggie Chili
- Fried Mac 'n' Cheese Bites
- Fleet Science Center
- Chicken Fingers with Ranch Dressing
- Milk Shakes Station
- Shaved Ice

*Additional Food Options Available at All Stations

2018 Esri UC Thursday Night Party, July 12, 2018

MAIN STAGE

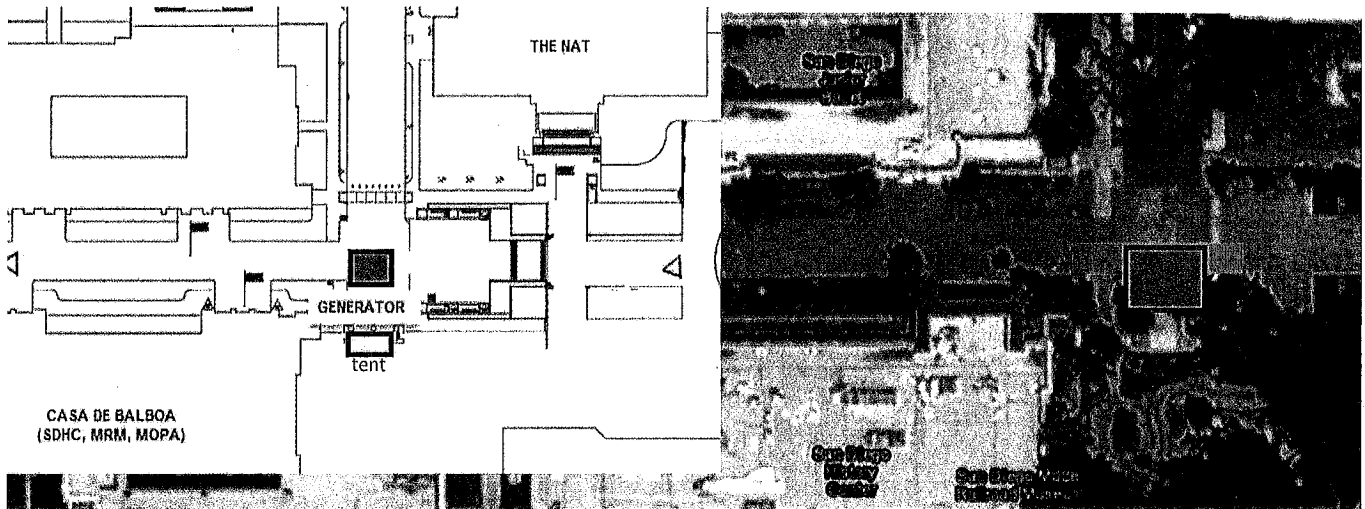

1—10'x20' tent

3—6' tables (Main Stage Greenroom Tent)

12—Chairs

70 KVA Generator

2018 Esri UC Thursday Night Party—Thursday, July 12, 2018

Plaza de Panama

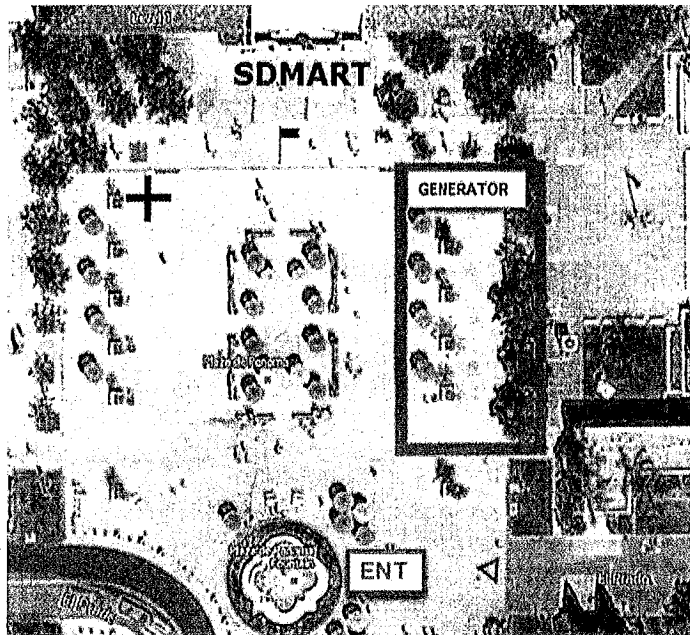

Kitchen:
12 Fryers
4 Hot Boxes

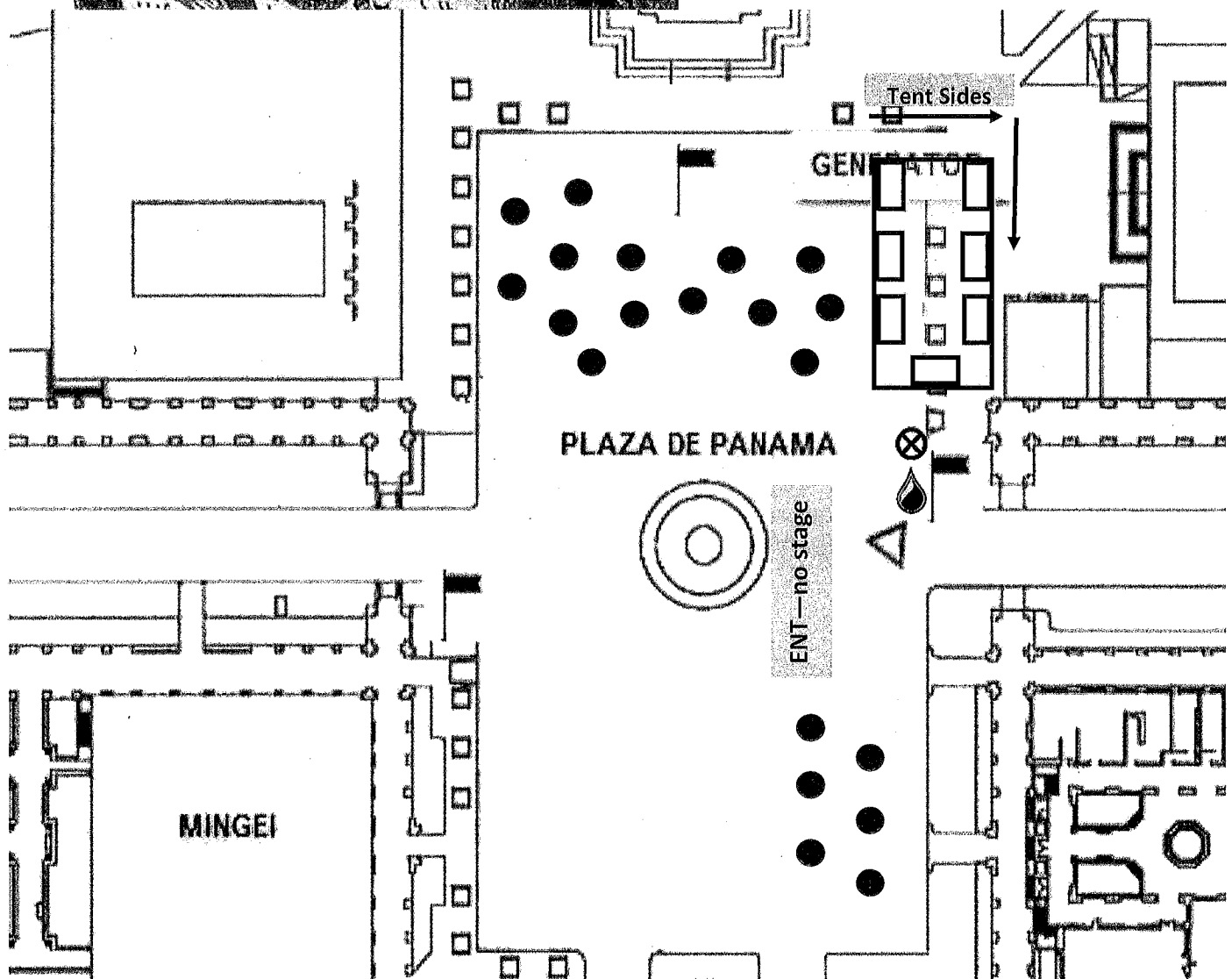

2018 Esri UC Thursday Night Party—Thursday, July 12, 2018

Botanical Garden/Lawns

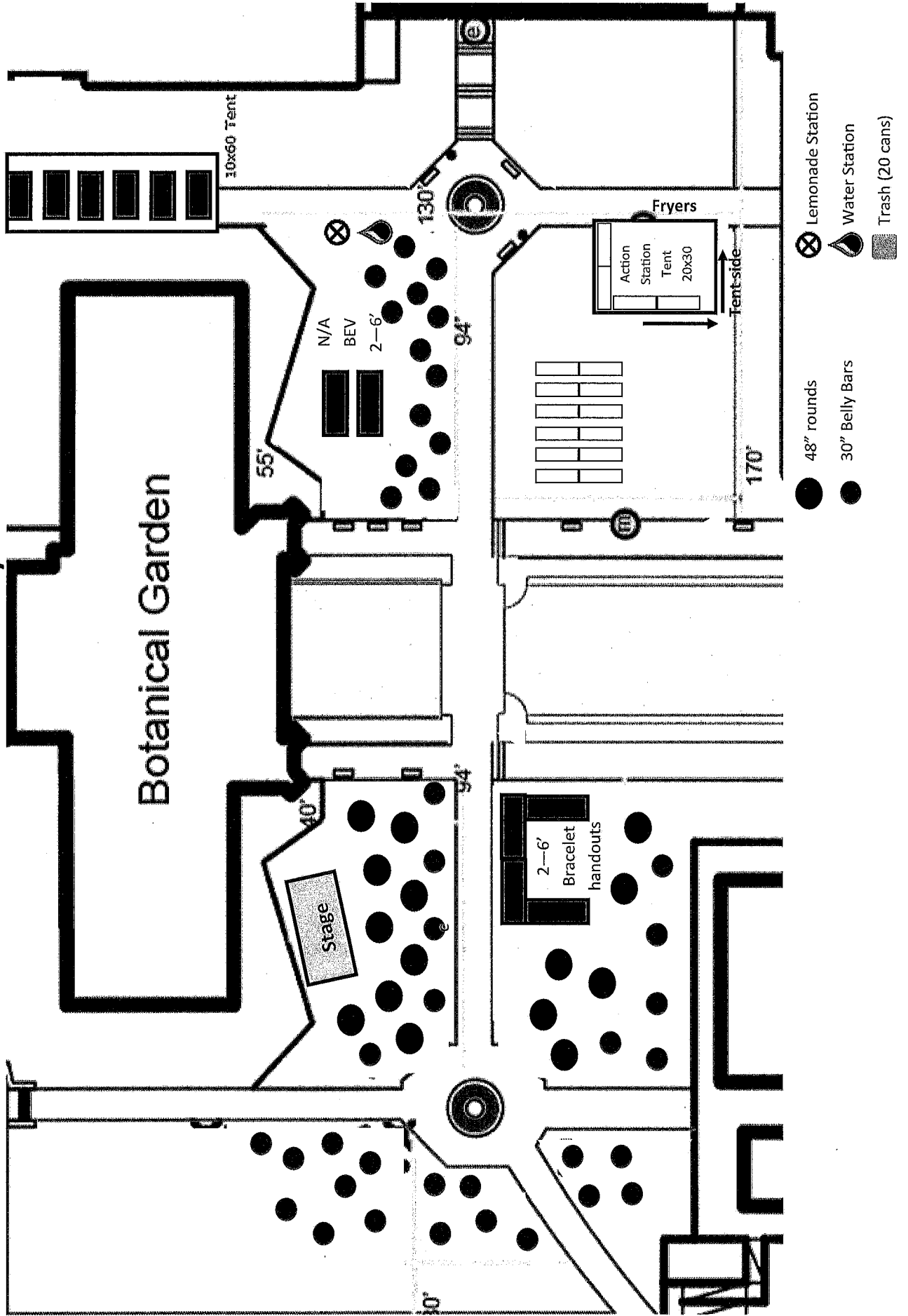

Bea Everson Fountain—2018 Esri UC Thursday Night Party, July 12, 2018

Kitchen:
 15 Fryers
 8 Ovens
 4 Hot Boxes

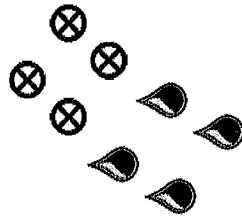
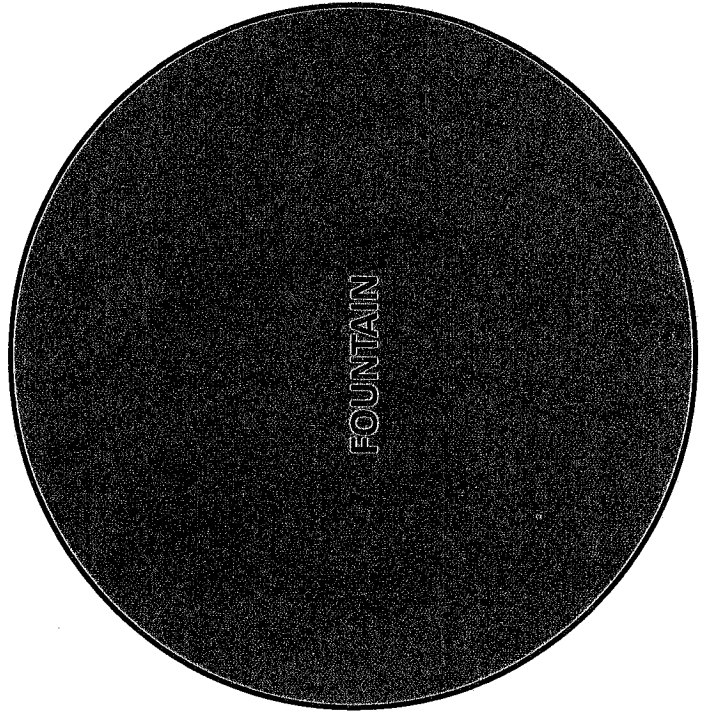
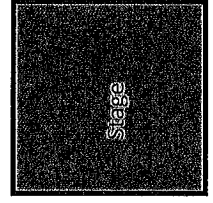
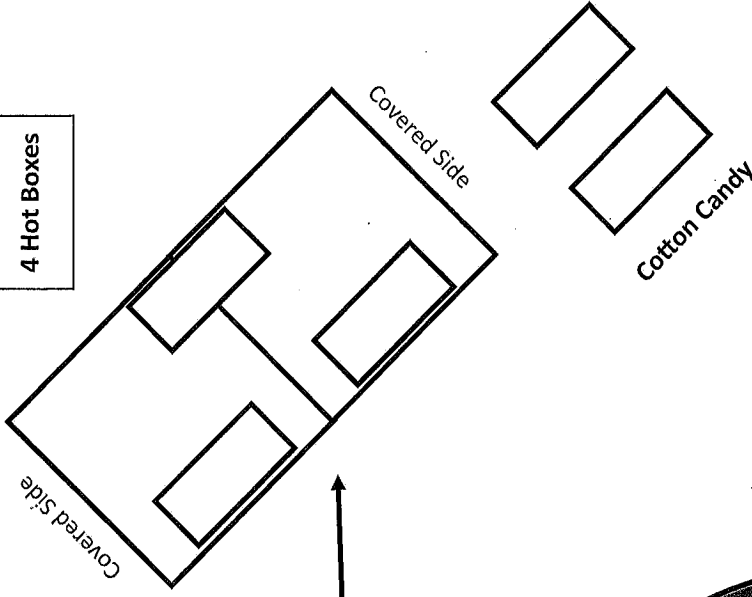
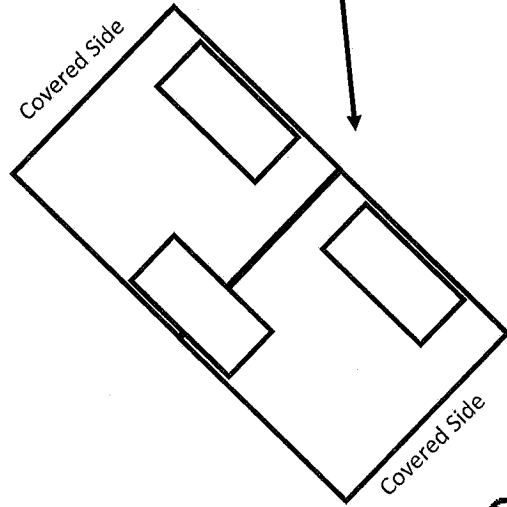
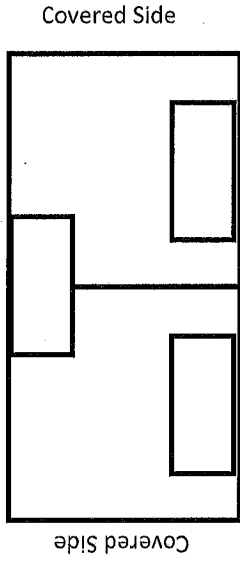

2 Bars & 2-6' table
 for bracelet
 Giveaway (in front
 of NAT)



2018 Esri UC Thursday Night Party—Thursday, July 12, 2018

El Prado Walkway

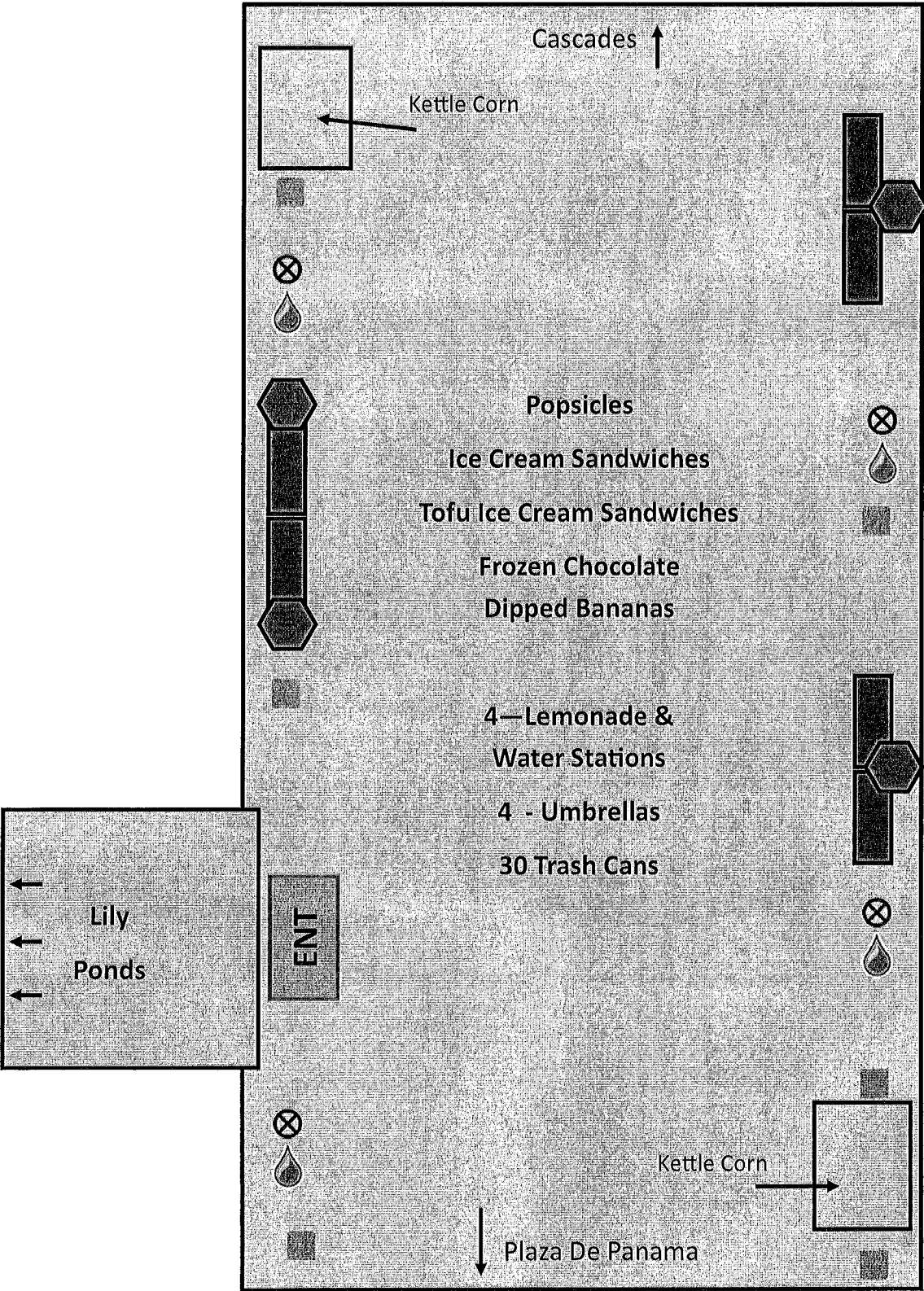

2018 Esri UC Thursday Night Party—Thursday, July 12, 2018

Patio B

