

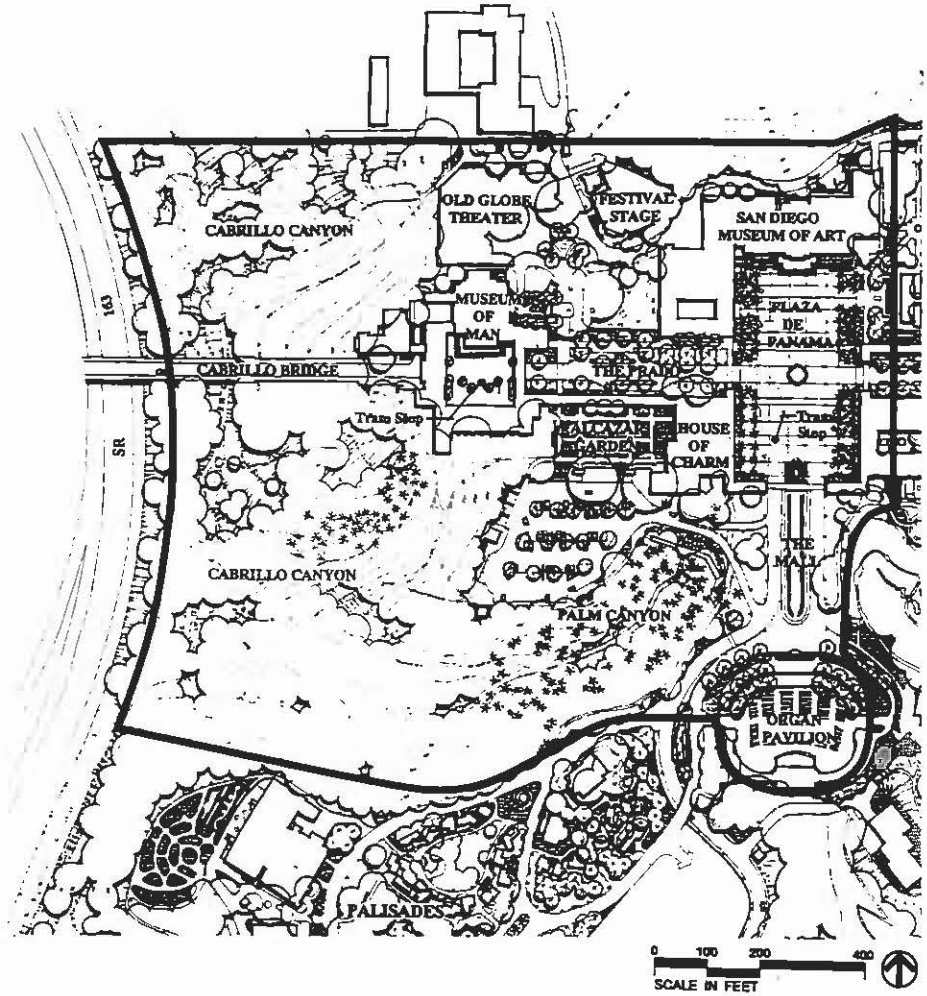

SPECIFIC RECOMMENDATIONS

West Prado



Site Amenities:

- Prado Light Standard: Western Lighting Standards Capistrano Series CA10 (or equal). Custom fixture as shown in Appendix. Color shall be Frazee Shutter Green 6125N gloss enamel.
- Removable Bollard: Western Lighting Standards Capistrano series custom design with 17" base as shown (or equal) in Appendix. Color to match light standards.
- Prado Drinking Fountain: Western Lighting Standards Capistrano series mini base as shown (or equal) in Appendix. Color to match light standards.



- Prado Cast Iron/Wood Bench: TimberForm Site Complements model numbers 2118-x and 2119-x (or equal) with cast iron supports and patterned wood slats. Bench depth is 2' - 2.5" and height is 2' - 9.5". Seat height is 1' - 5" with surface mounting and wood size 1.5" x 2.5". Length to be determined. Finish to be powder coating color RAL 6009. See Appendix.
- Prado Concrete Bench: Dura Art Stone cast stone Coronado bench 6U, minimum 6' length, installed with epoxy adhesive, nordic cream color and sanded smooth finish, order number: S-6U-E-S-13-SK (or equal). 26" wide seat, 17" height and minimum 72" length. See Appendix.
- Plaza Chair: Wesnic Food Court Furniture, Bentwood III side chairs, with mesh seat and Fan Back, model #302 (or equal). See Appendix.
- Prado Plaza Table: Falcon Table Base model #2704-UH (or equal) with cast iron base, 18 ga. 4" steel tubing, rubber cushion glides, 15" cast iron spider, 24" diameter base spread, 27.5" overall height. 36" round marble table top available through distributor. California Umbrella with 1-1/4" diameter pole available through Sunstar Bistro. See Appendix.
- Prado Metal Trash Receptacles: Victor Stanley Ironsites Concourse Series, model #RS-12 (or equal). Color to match light standards. See Appendix.
- Prado Concrete Trash Receptacle: Dura Art Stone cast stone trash receptacle model number TR-N round, nordic cream color with light sand blast finish, order number: S-TR-N-S-13-LSB (or equal) with 30" diameter, 36" height. Matching ash urn (at building entries only) order number: S-AU-N-S-13-LSB (or equal) with 19" diameter, 22" height. See Appendix.
- Plant Container: Dura Art Stone cast stone 3' & 4' wide, design N Aquarian round planters, 30" & 36" height, nordic cream color with light sand blast finish and 2" centered drain holes. Order numbers:
 - S-4-N-36-S-13-LSB-2" centered (or equal)
 - S-4-N-30-S-13-LSB-2" centered (or equal)
 - S-3-N-30-S-13-LSB-2" centered (or equal)See Appendix.
- Prado Tree Grates: Urban Accessories, cast iron tree grate model "O.T." series (or equal). Round or square shape and size to be determined. See Appendix.

Signage:

- Stop Sign Standard: Western Lighting Standards Capistrano series as shown in Appendix (or equal). Color shall be Frazee Shutter Green 6125N, gloss enamel or equal.
- Prado Tram Stop Sign Standard: Western Lighting Standards Capistrano series as shown in Appendix (or equal). Color shall be Frazee Shutter Green 6125N, gloss enamel or equal.
- Prado Pedestrian Orientation Sign Standards: Western Lighting Standards Mini Capistrano series as shown in Appendix (or equal). Color shall be Frazee Shutter Green 6125N gloss enamel or equal.



1. Plaza de California

Design Objective:

Incorporate a Park tram stop, seating, new planting and additional lighting in the Plaza de California.

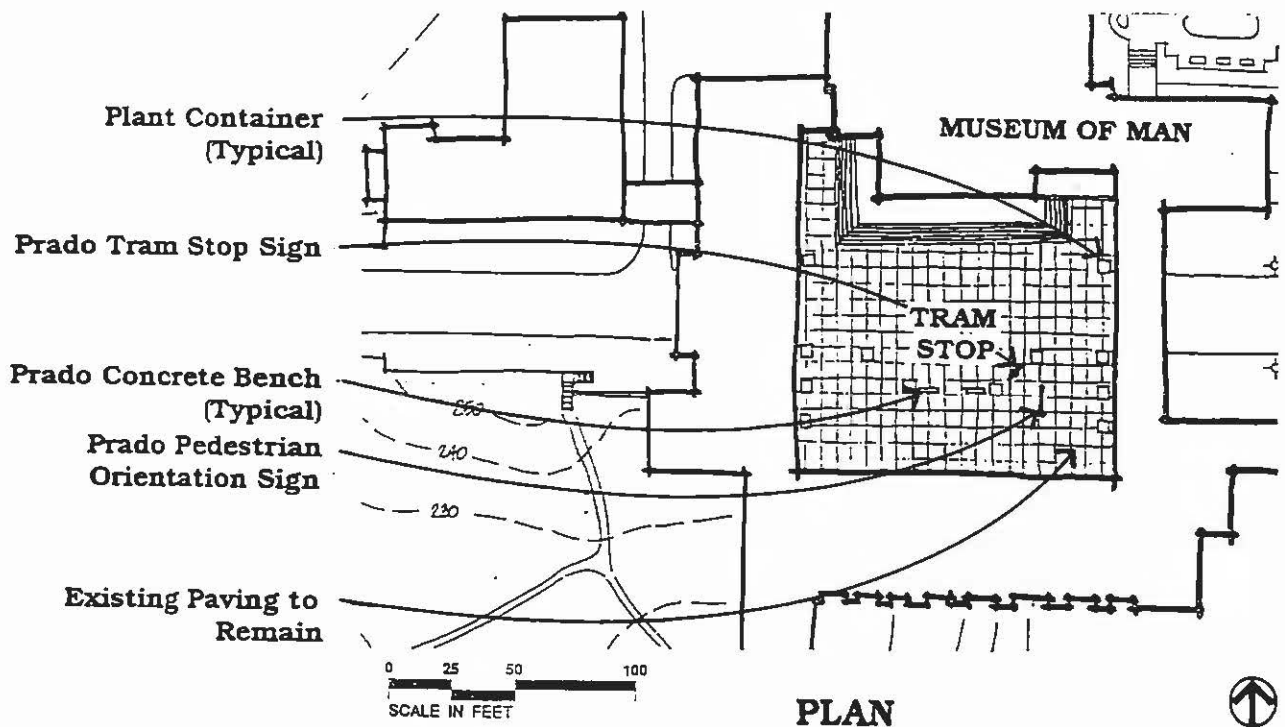

Recommendations:

- Define vehicular circulation areas with plant containers 48" in diameter.
- Provide 36 inch diameter plant containers for container trees placed on west and east edges of the plaza.
- Place concrete benches for the tram stop inside the south arcade.
- Maintain an unobstructed pedestrian sightline and access from the front door of the Museum of Man to the center arch of the south arcade.
- Retain and refurbish original attached light fixtures on perimeter of plaza. Add new light fixtures under all arcades using reproductions of the original 1915 light fixtures.

Container Tree: *Chamaerops humilis* - Mediterranean Fan Palm



2. The Prado Streetscape

Design Objective:

Modify the West Prado in order to provide for automobile turnout lanes while re-establishing as much of the historical character of this processional space as possible.

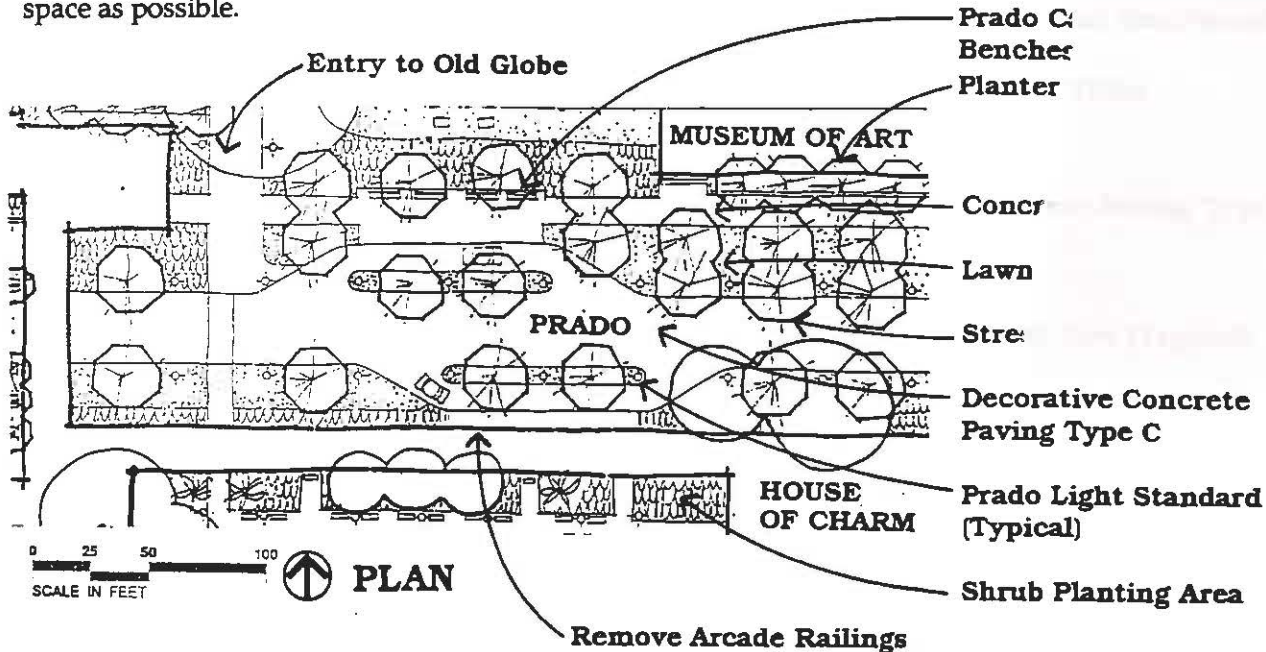

Recommendations:

- Replace asphalt with decorative concrete paving to match existing East Prado paving surface.
- Install a pedestrian drop-off lane on each side of the vehicular circulation lanes as shown on the plan.
- Include a loading zone in each drop-off lane.
- Add sidewalk access to drop-off areas according to plan. Remove arcade railings where needed to provide access.
- Incorporate new planting after rehabilitation of arcades and the House of Charm have been completed. Utilize accent shrubs and groundcover that will remain below two feet in height and are consistent with landscape guidelines and historic themes. Retain all significant trees per the Balboa Park horticulturist. (See appendix for specific horticultural recommendations).
- Remove junipers from the Museum of Art planter and replace with small accent shrubs, climbing vines, and small trees.

Street Tree: *Alectryon excelsum* - N.C.N.

Planter Tree (Museum of Art): *Eriobotrya deflexa* - Bronze loquat



3. Alcazar Garden

Design Objective:

Rehabilitate the garden fixtures and hardscape.

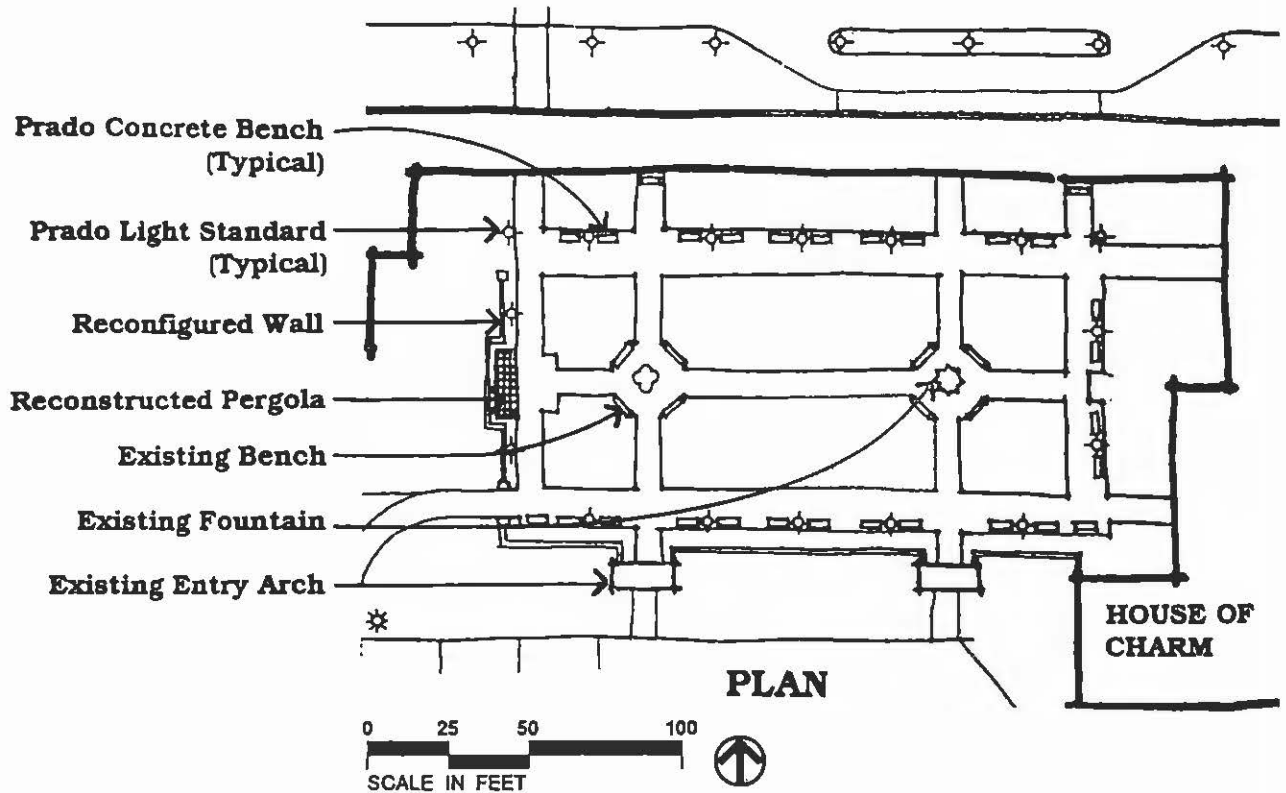

Recommendations:

- Reconstruct the historic pergola on the west side of the garden that existed during the 1915 and 1935 Expositions.
- Remodel the masonry wall on the west side of the garden as shown on the plan to match south wall.
- Renovate the existing south entry arches.
- Remove the existing flood lights from the south entry arches and install pole lights as shown on the plan.
- Widen sidewalks to accommodate concrete benches and light standards.
- Rehabilitate the entry pilasters on the southwest entry.
- Rehabilitate the garden fountains and nearby benches to their 1935 appearance.
- Relocate the maintenance area adjacent to the garden to a new ground maintenance building on the west side of the Alcazar parking lot.



The Alcazar garden pergola as it appeared in 1915.



4. Old Globe Plaza

Design Objective:

Provide a new ramped entry and pedestrian plaza for the Old Globe Theater complex.

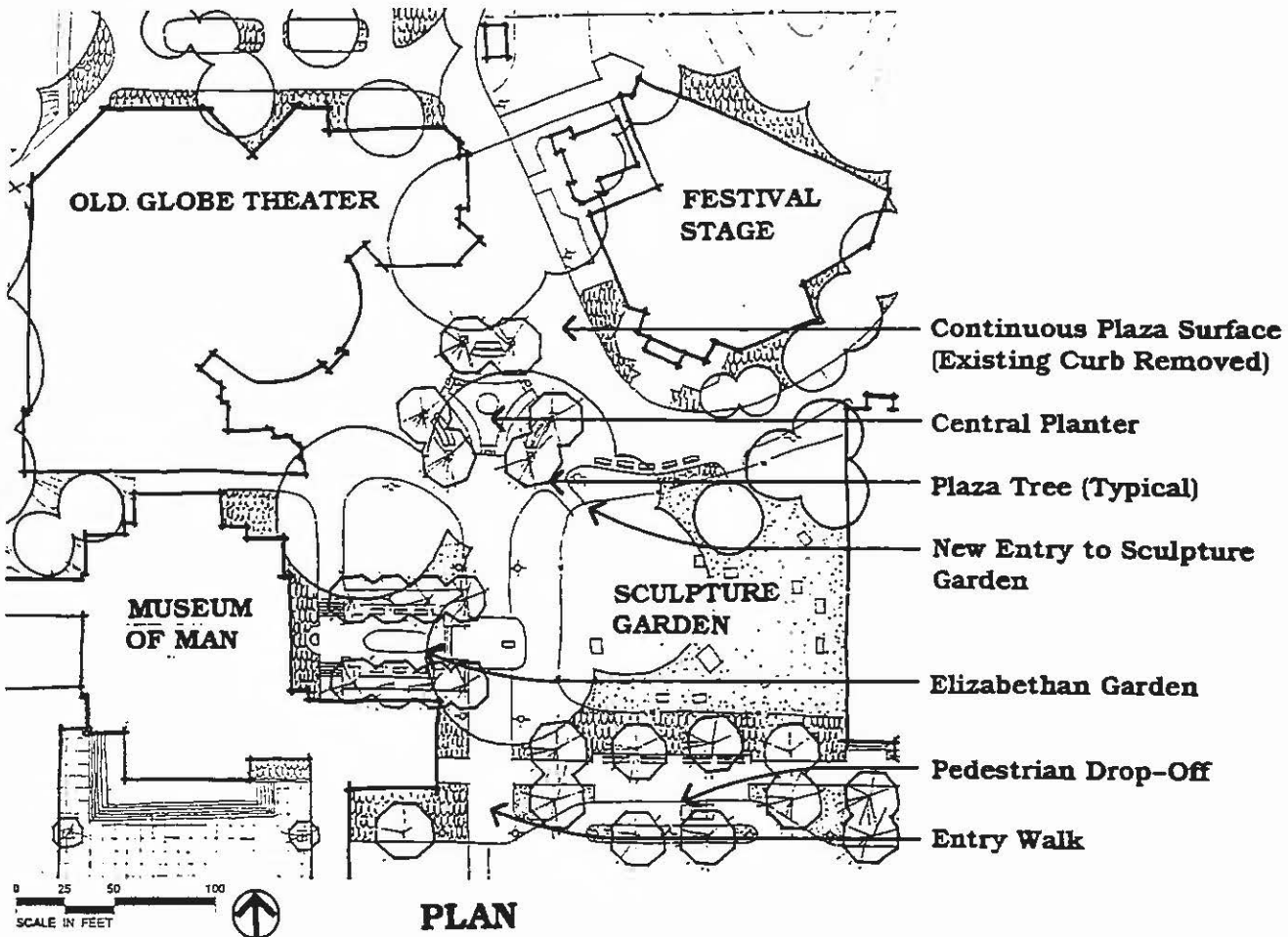

Recommendations:

- Utilize scored concrete as a paving surface throughout the plaza.
- Remove the existing curb on Old Globe Way to create a continuous paving surface throughout the plaza.
- Provide wide raised planter walls and benches for seating.
- Confine all permanent institution signage within leasehold area.
- Install a new freestanding restroom building on the northwest side of the Lowell Davies Festival Stage that is architecturally compatible with surrounding Elizabethan architecture.
- Add new entry to the Sculpture Garden from the plaza.



5. Archery Range

Design Objective:

Relocate the archery range to a comparable alternate location when possible and return the area to a naturalized preserve for general public use. Provide for interim shared use of the area until an alternate site for an archery range is chosen and prepared.

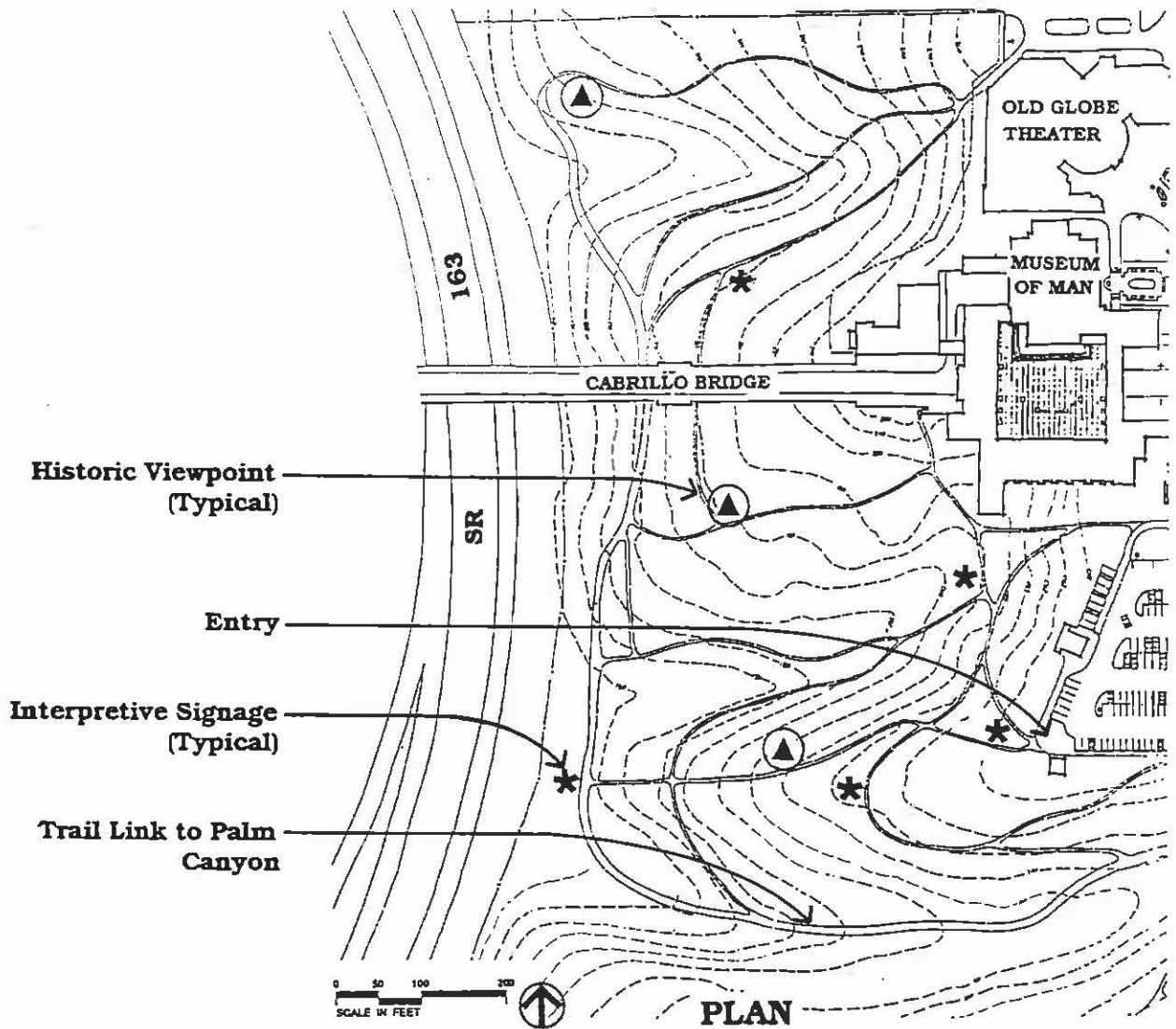

Recommendations:

- Remove the fence and restricted use signs from the range perimeter.
- Develop a trail system that incorporates historic viewpoints and interpretive material.
- Incorporate linkages between the former archery range area and the Palm Canyon trail system and Alcazar Garden.
- Develop interim use guidelines between Park Management and San Diego Archers to ensure public safety and effective use of the area.



6. Palm Canyon

Design Objective:

Add additional plantings and interpretive material to enhance Palm Canyon.

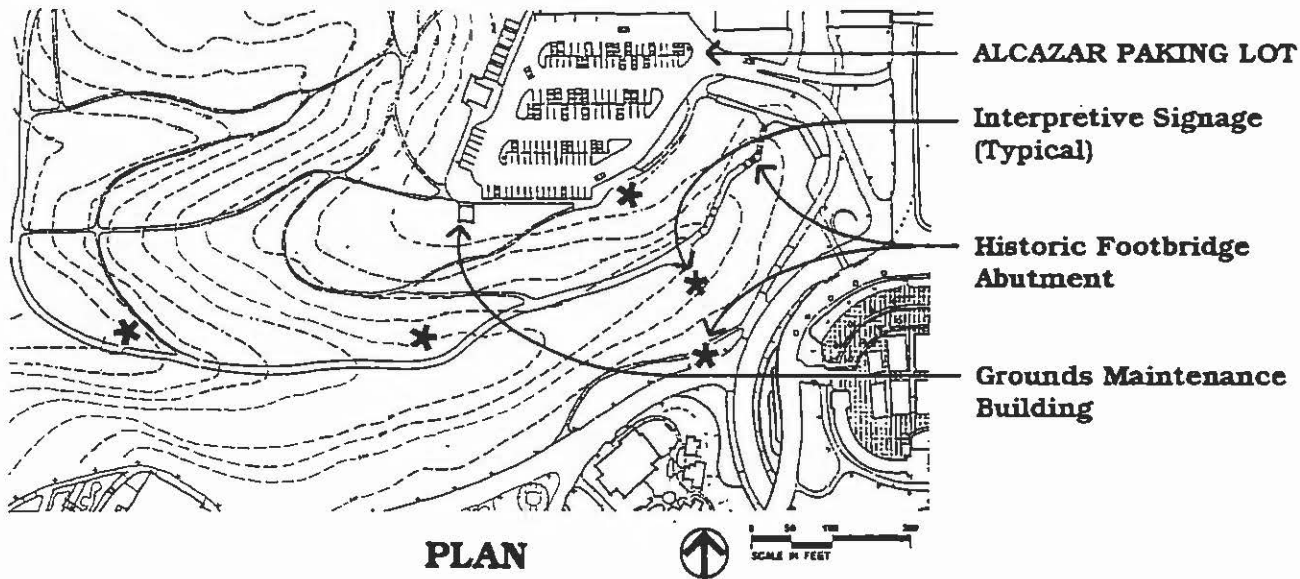

Recommendations:

- Extend the present concrete path at the bottom of the canyon and add a small interpretive area at the terminus of the concrete path containing benches and interpretive signage.
- Provide lighting along the pedestrian path using Prado pole lighting.
- Construct new trails that link the interpretive area to the two bridge heads of the former Palm Canyon bridge at the top of each side of the canyon.
- Provide interpretive signage at both remaining historic foot bridge abutments.
- Construct new trails that will link with the former archery range open space.
- Construct a new trail that links the interpretive area to the proposed protea garden behind the Balboa Park Club.
- Add additional plantings to the canyon under the direction of the Balboa Park horticulturist.



7. Plaza de Panama

Design Objective:

This plaza should be restored to its historic role as the outdoor “living room” of San Diego. Its central location at the crossing point of the two major sightlines of the Central Mesa will cause it to function as the primary public square of the Central Mesa. Because of its singular importance as a pedestrian crossroad, as a cultural center, and as a visual focal point, a variety of special events, ceremonial occasions, and everyday passive and active uses can be accommodated.

In order to return the plaza to its historic function and spatial identity, several design elements will be employed. First, the edge of the plaza must be delineated on the ground plane through the use of a band of paving that subtly contrasts with the remainder of the plaza. Second, a vertical treatment is needed to return a sense of spatial enclosure to the northeast side of the plaza. This treatment must, however, be transparent enough to retain visual access to the Timken Gallery. A small bosque of queen palms was chosen for this purpose, and this treatment was repeated in the other three quadrants of the plaza to retain its formal symmetry and preserve views to surrounding architecture. Finally, a central focal feature is needed to give further definition to the spatial relationships and site lines of the space. A low pool was chosen for this purpose to retain axial views and to provide a cooling water element that is consistent with the Spanish Colonial themes in the Prado. Vehicular circulation through the plaza should be defined with bollards to allow for a flush plaza surface.

The Plaza de Panama in its current role as a vehicular circulation and parking area.



A computer simulation of the proposed plaza which will serve as a central pedestrian open space.

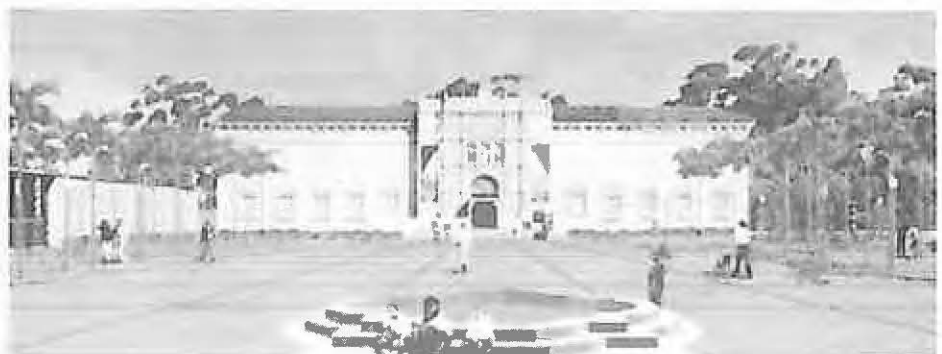



BALBOA PARK · CENTRAL MESA PRECISE PLAN

Precise Plan - Specific Recommendations

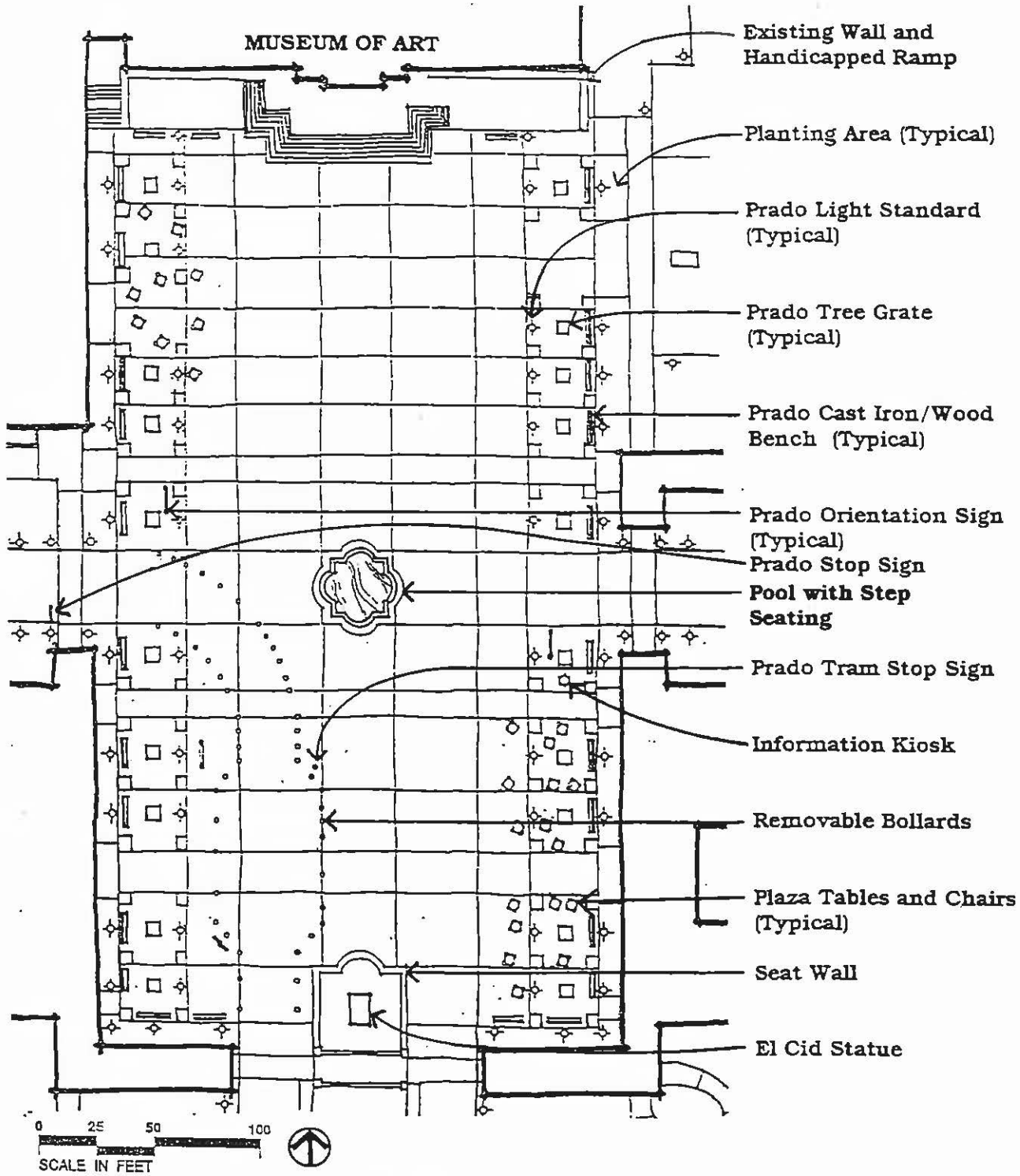

**PLAZA DE PANAMA
PLAN**



Recommendations:

- Utilize subtly colored, scored concrete paving surfaces that are similar to existing Prado paving throughout the plaza. (See decorative paving diagram.)
- Install a stop sign at the vehicular entry to Plaza.
- Confine vehicular traffic to two lanes through the southwest corner of the plaza and include drop-offs and tram stops.
- Define the vehicular circulation route with the use of removable bollards to match Prado light standard bases. Chains connecting bollards should not be used.
- Provide movable chairs and tables in the plaza. The areas closest to the House of Hospitality and Sculpture Garden Cafe are well suited to this purpose.
- Place benches along the periphery of the plaza as shown.
- Plant bosques of queen palms at the margins of the plaza.
- Accent the central axial crossing point of the Prado by placing a Spanish Colonial pool in the plaza. Two levels of monumental steps will form the rise to the central pool. These should not exceed 30" in height and be surrounded by a rim that is a minimum of 16" wide to provide seating. Concealed down lights built into the pool steps should be included. Mosaic tiles inside the pool should repeat historic motifs such as the sunburst design found on the tile dome of the California Building. Decorative brass fixtures should also be included inside the pool to support a portable stage deck for special events.
- Provide aesthetically pleasing night lighting in the plaza. Features in the Plaza de Panama to highlight will be the bosques of palms, the central pool, El Cid, and the surrounding arcades and architecture.
- Define vehicular circulation through the plaza at night by illuminating the bollards with up lights installed flush with the plaza paving.

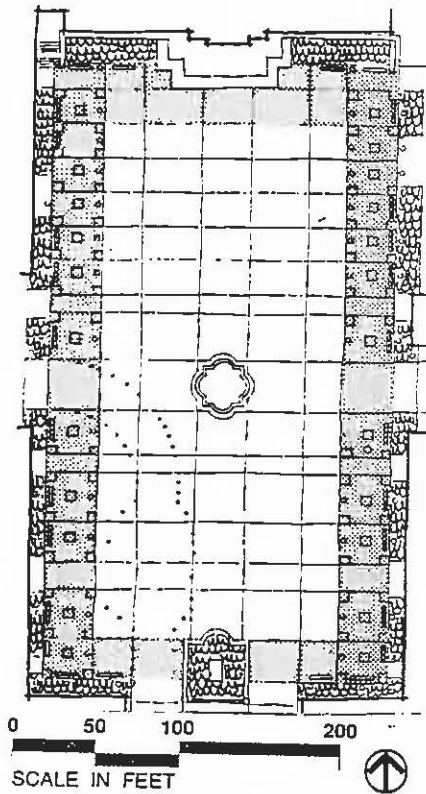

PLAZA PAVING DETAIL

- Type A
- Type B

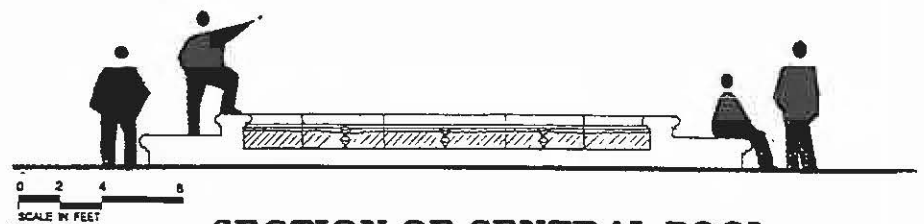

SECTION OF CENTRAL POOL



- Locate a seat wall around the statue of El Cid, enclosing seasonal flower beds.
- Provide unobtrusive and secure electrical service to support sound and lighting equipment in several areas of the plaza. Provision should also be made for power to be provided to a stage that could be set up over the central fountain.

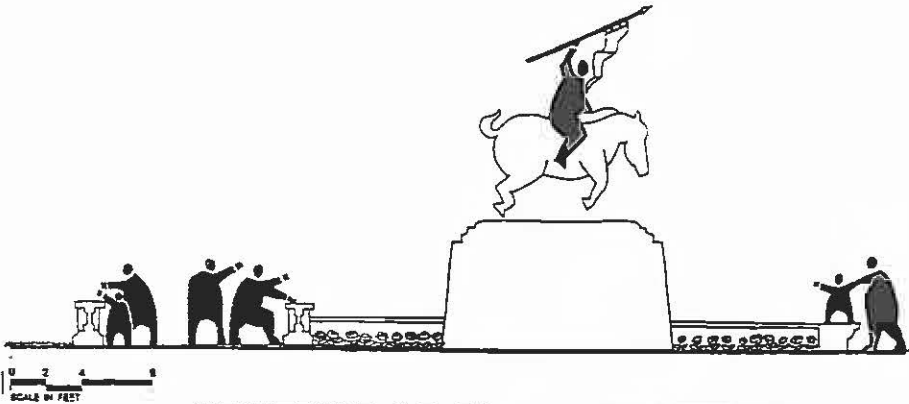

SECTION OF EL CID SEATWALL



8. The Mall

Design Objective:

Restore pedestrian access along the central mall between Plaza de Panama and the Organ Pavilion. Allow for vehicular circulation on the western portion only.

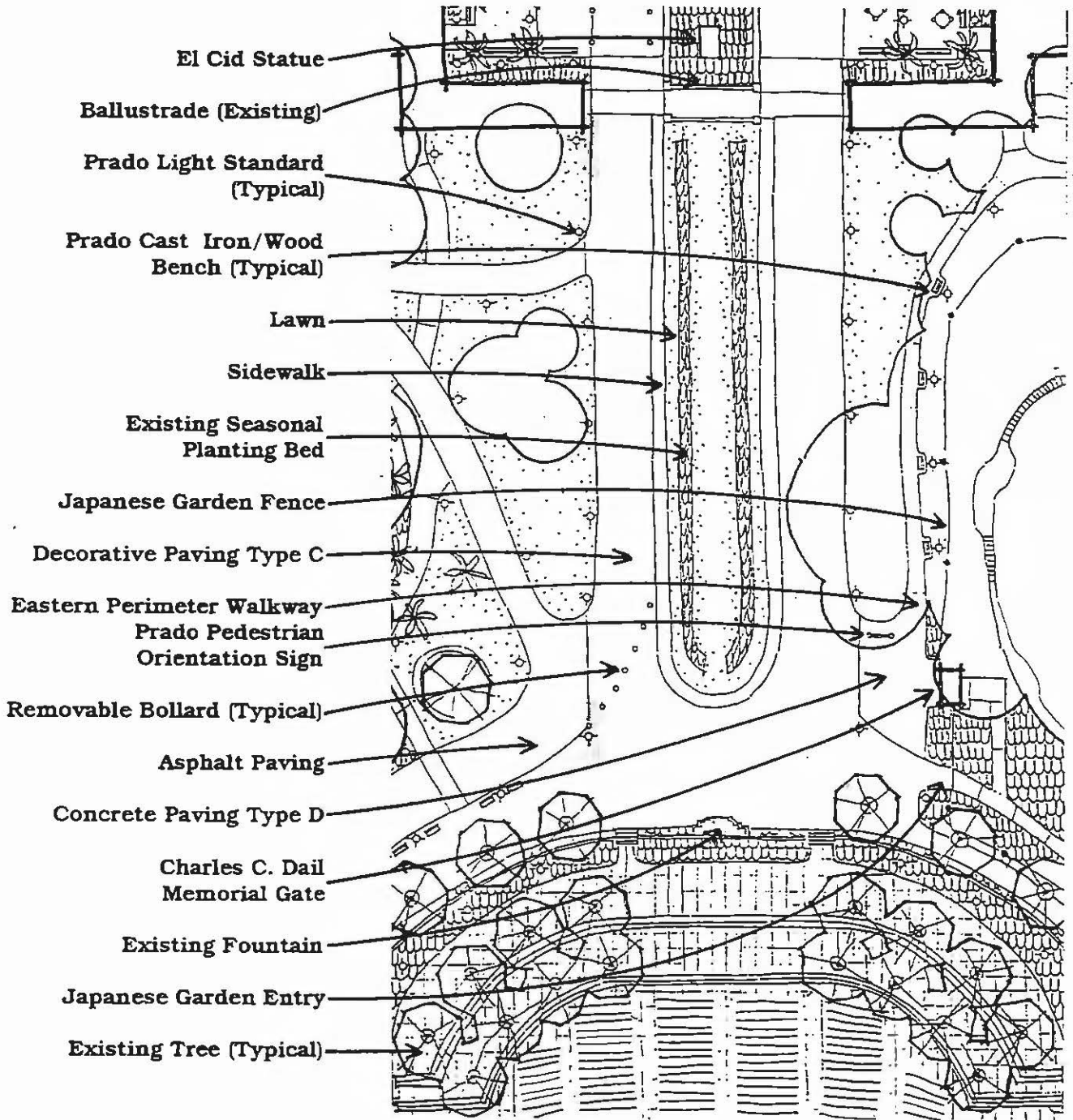

PLAN





Recommendations:

- Retain the existing configuration of the central landscaped area containing lawn and seasonal planting beds.
- Border the planting area with a six foot wide type C concrete sidewalk separated from adjacent paving by a six inch curb.
- Relocate the existing backflow preventer device located in the central landscaped area to a location hidden from public view.
- Replace the permanent pole used for Christmas decoration with a removable pole that will fit into a capped metal sleeve installed flush with finish grade. Install in place only during use.
- Repave the existing asphalt roadway and sidewalks bordering the Organ Pavilion with type C paving.
- Reconfigure the plaza and pedestrian walkway on the north side of the Organ Pavilion. Pave with scored concrete type C paving.
- Separate automobile circulation from pedestrian areas south of the central planting area with bollards that match the Prado light standard bases.
- Provide an entry area for the Japanese Garden that connects to the existing eastern perimeter walkway as shown on the plan. Pave with concrete type D.
- Relocate existing Queen Palms to other locations in the Park to provide an unobstructed view of the Organ Pavilion from the Plaza de Panama.



9. Organ Pavilion

Design Objective:

Retain the existing design and plant materials. Add torrey pines behind the east peristyle to provide a symmetrical visual backdrop.

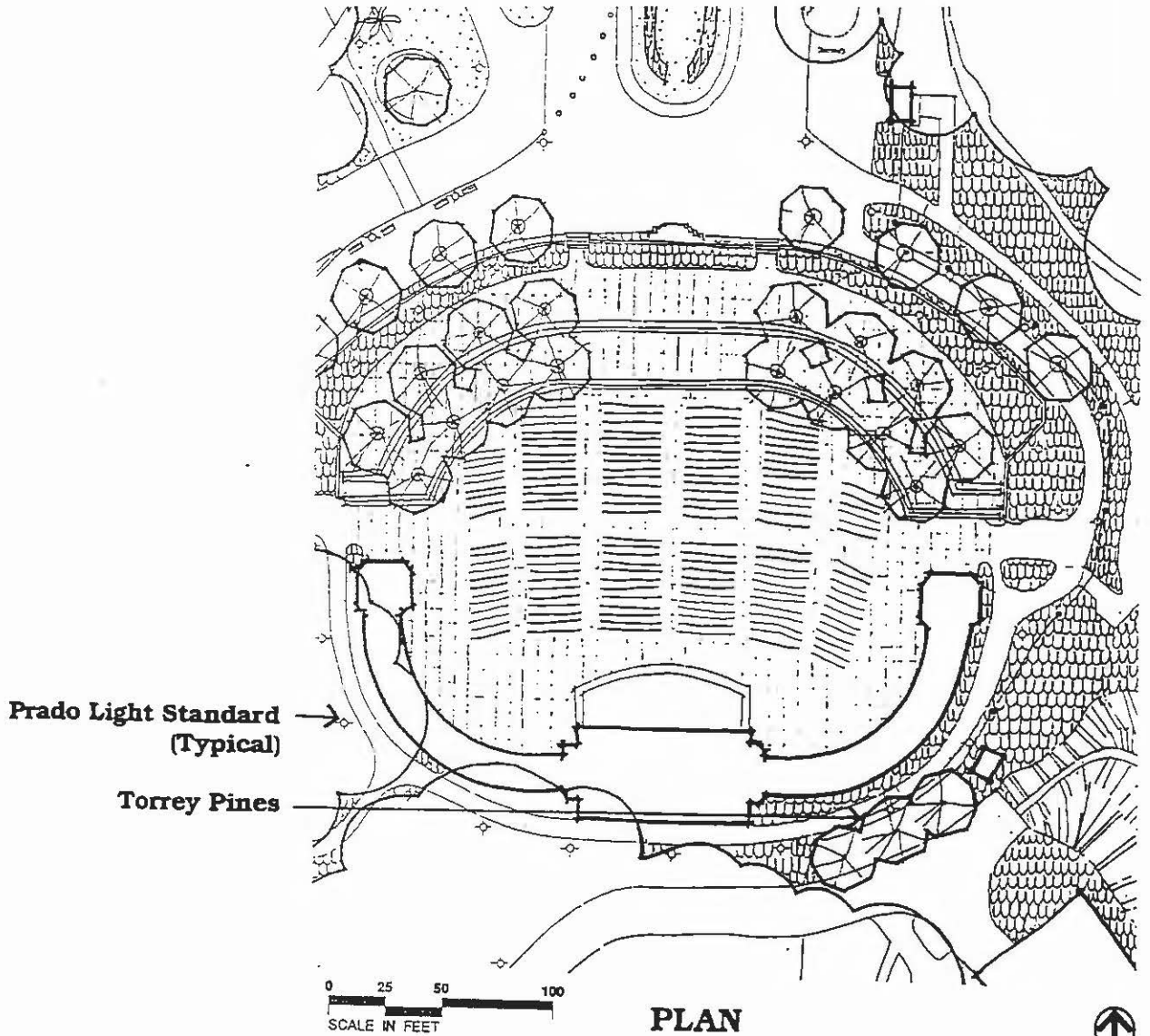



East Prado

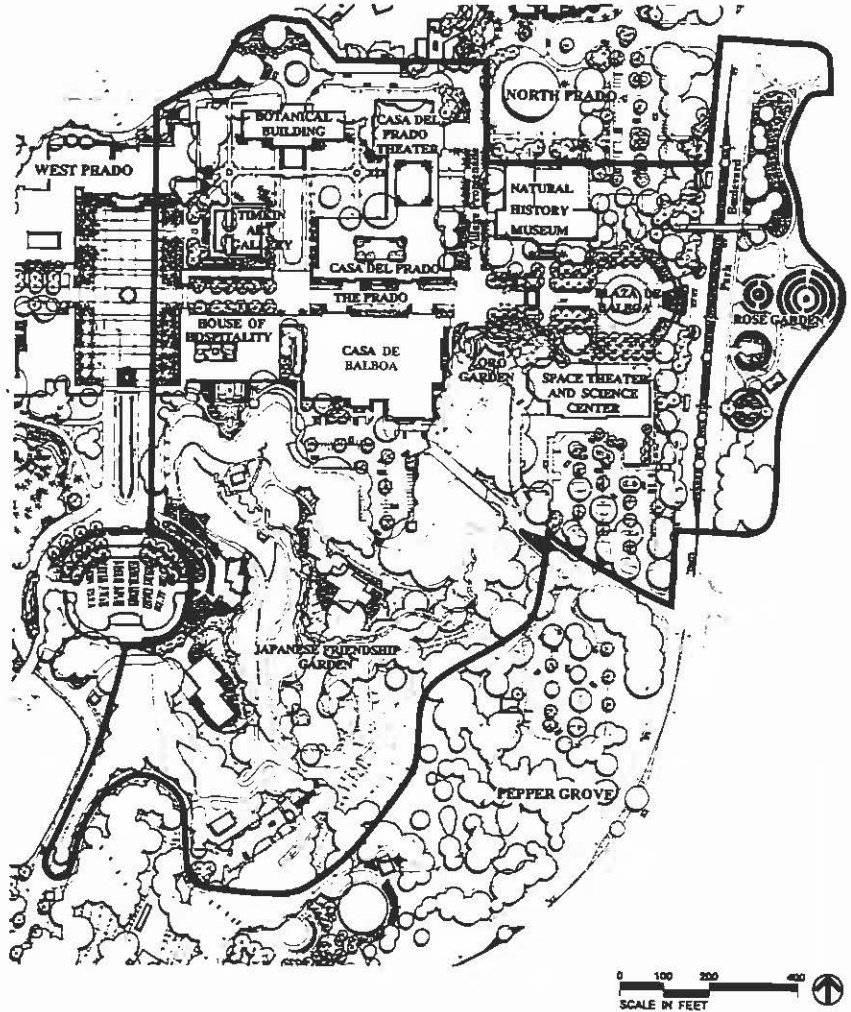

Site Amenities:

- Prado Light Standard: Western Lighting Standards Capistrano Series CA10 (or equal). Custom fixture as shown in Appendix. Color shall be Frazee Shutter Green 6125N gloss enamel.
- Prado Drinking Fountain: Western Lighting Standards Capistrano series mini base as shown in Appendix (or equal). Color to match light standards.
- Prado Cast Iron/Wood Bench: TimberForm Site Complements model numbers 2118-x and 2119-x (or equal) with cast iron supports and patterned wood slats. Bench depth is 2' - 2.5" and height is 2' - 9.5". Seat height is 1'-5" with surface mounting and wood size 1.5" x 2.5". Length to be determined. Finish to be powder coating color RAL 6009. See Appendix.



- Prado Concrete Bench: Dura Art Stone cast stone Coronado bench 6U, minimum 6' length, installed with epoxy adhesive, nordic cream color and sacked smooth finish, order number: S-6U-E-S-13-SK (or equal). 26" wide seat, 17" height and minimum 72" length. See Appendix.
- Plaza Chair: Wesnic Food Court Furniture, Bentwood III side chairs, with mesh seat and Fan Back, model #302 (or equal). See Appendix.
- Prado Plaza Table: Falcon Table Base model #2704-UH (or equal) with cast iron base, 18 ga. 4" steel tubing, rubber cushion glides, 15" cast iron spider, 24" diameter base spread, 27.5" overall height. 36" round marble table top available through distributor. California Umbrella with 1-1/4" diameter pole available through Sunstar Bistro. See Appendix.
- Prado Metal Trash Receptacles: Victor Stanley Ironsites Concourse Series, model #RS-12 (or equal). Color to match light standards. See Appendix.
- Prado Concrete Trash Receptacle: Dura Art Stone cast stone trash receptacle model number TR-N round, nordic cream color with light sand blast finish, order number: S-TR-N-S-13-LSB (or equal) with 30" diameter, 36" height. Matching ash urn (at building entries only) order number: S-AU-N-S-13-LSB (or equal) with 19" diameter, 22" height. See Appendix.
- Plant Container: Dura Art Stone cast stone 3' & 4' wide, design N Aquarian round planters, 30" & 36" height, nordic cream color with light sand blast finish and 2" centered drain holes. See Appendix. Order numbers:
 - S-4-N-36-S-13-LSB-2" centered (or equal)
 - S-4-N-30-S-13-LSB-2" centered (or equal)
 - S-3-N-30-S-13-LSB-2" centered (or equal)
- Prado Tree Grates: Urban Accessories, cast iron tree grate model "O.T." series (or equal). Round or square shape and size to be determined. See Appendix.

Signage:

- Prado Pedestrian Orientation Sign Standards: Western Lighting Standards Mini Capistrano series as shown in Appendix (or equal). Color shall be Frazee Shutter Green 6125N gloss enamel or equal.



1. The Prado Streetscape

Design Objective:

Preserve the landscape treatment along the pedestrian promenade and rejuvenate the Promenade Plaza area at the junction with Village Promenade.

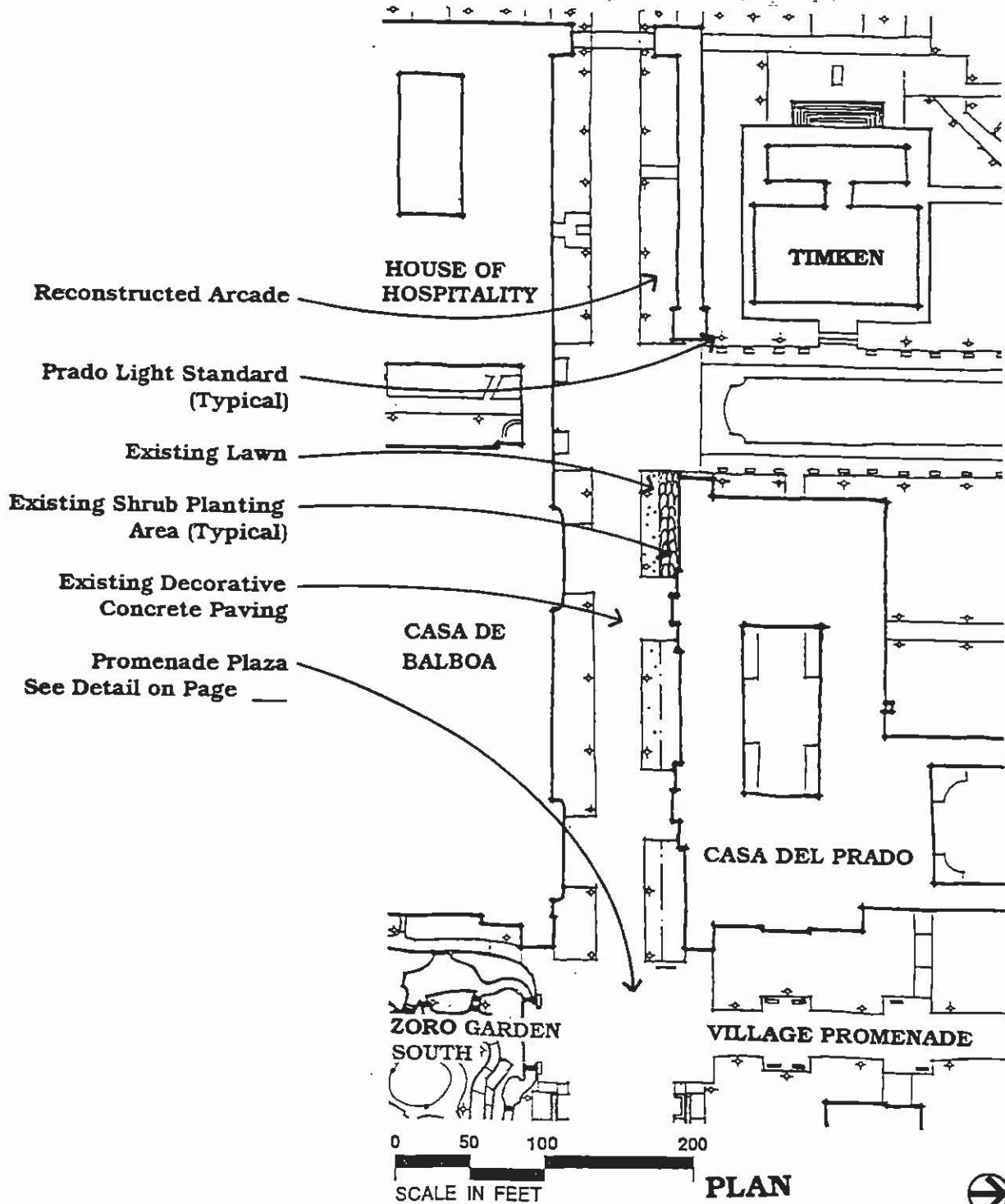



Recommendations:

- Preserve existing plantings along the Prado.
- Replace existing light standards with the recommended model in locations shown on the plan.
- Install replicas of the large planting urns which were present during the Expositions on the pilasters which form the entry to Zoro Garden.
- Relocate the existing freestanding planting urn and remove the two existing trees and planters to restore this area to its Exposition configuration.

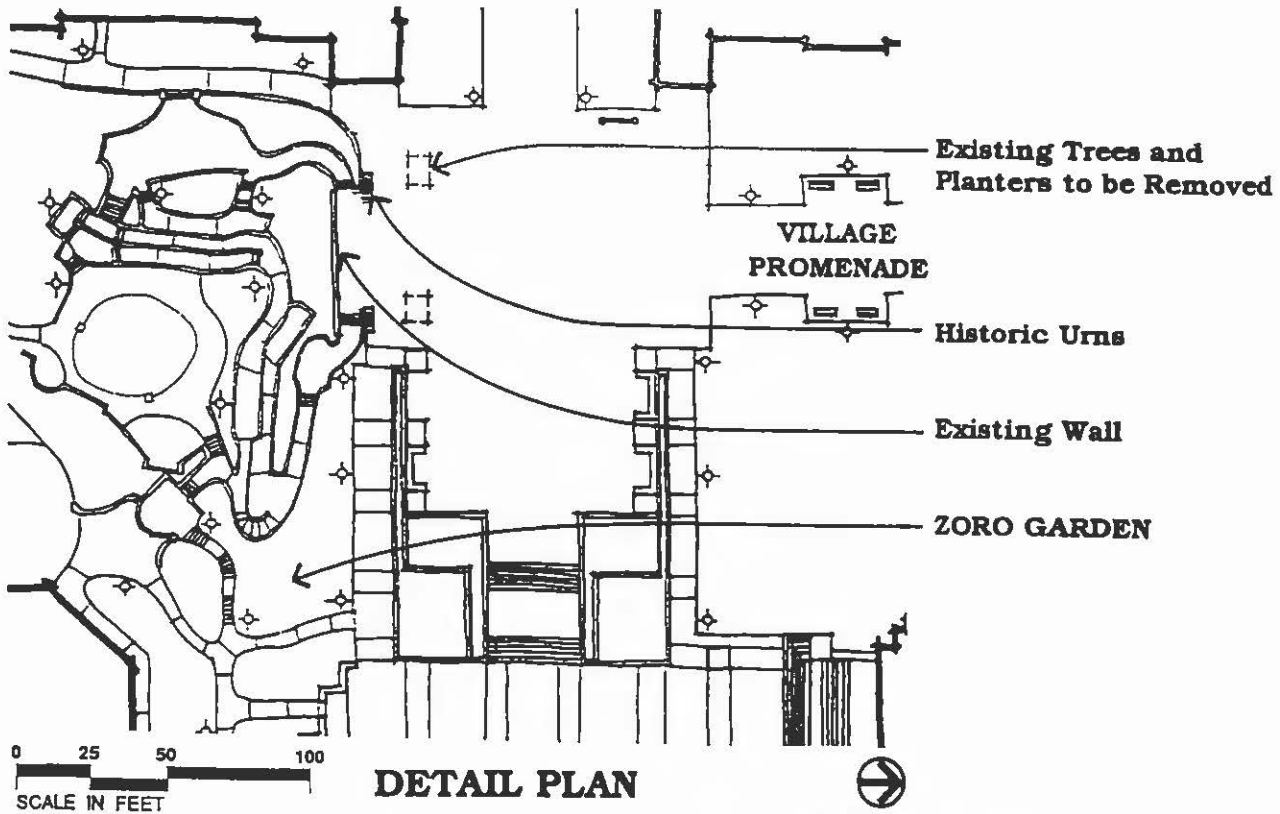

Planting urns as they appeared in 1915.



2. Village Promenade*

Design Objective:

Return the north/south portion of Village Place to a pedestrian promenade.

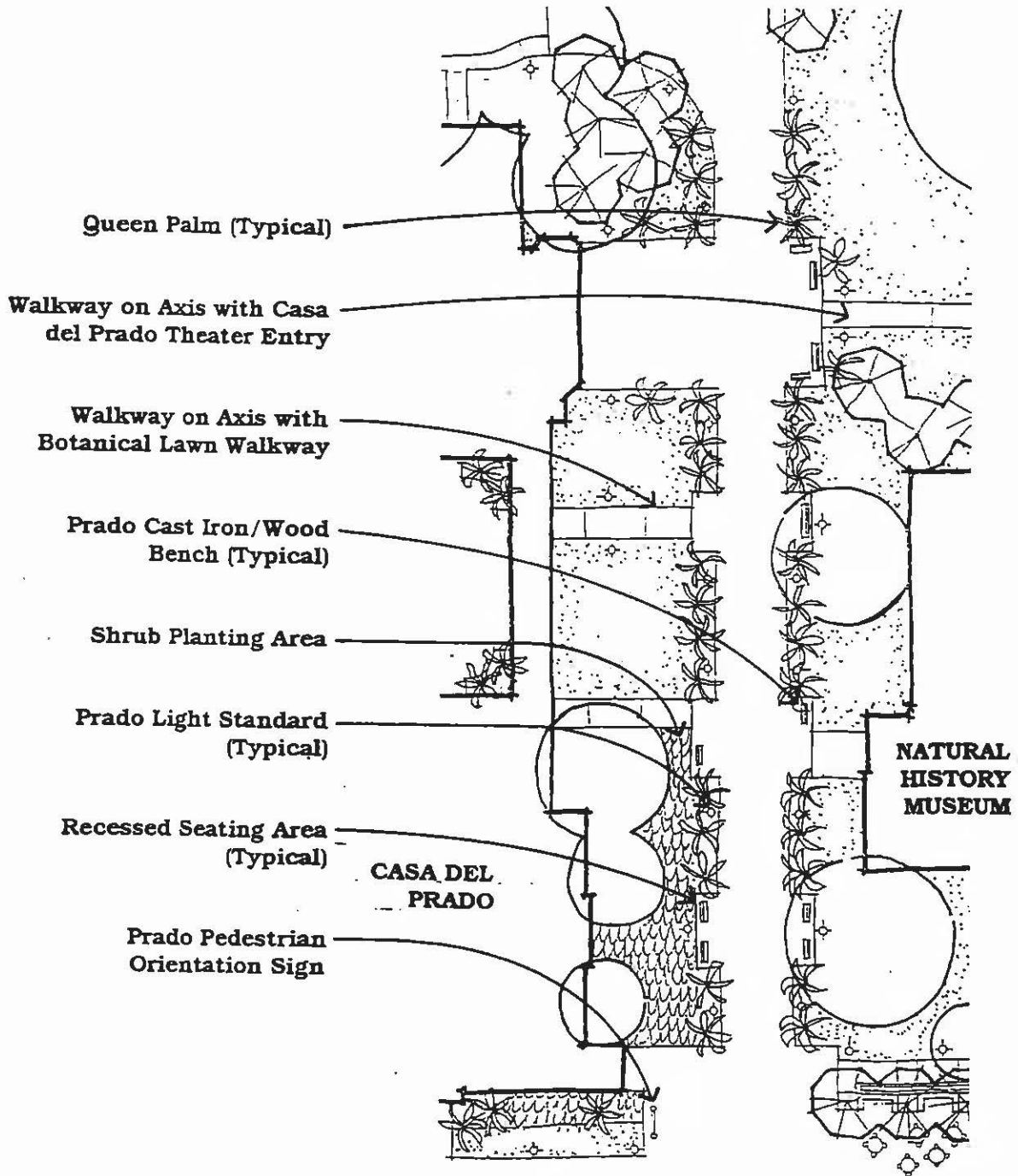

0 25 50 100
SCALE IN FEET

PLAN





Recommendations:

- Remove existing sidewalks on both sides of Village Place and return them to lawn and garden areas.
- Narrow the width of paved walkway to 30 feet.
- Replace asphalt paving with type C decorative concrete to complement the paving in the Prado.
- Add two new seating areas that face one another and are recessed from the promenade adjacent to the Casa del Prado and Natural History Museum.
- Relocate the walkway connecting Village Promenade to Casa del Prado courtyard so that the new walk is on axis with the Botanical Building lawn walkway. Remove the existing iron railings in the arcade openings to allow for free circulation through the courtyard.
- Provide a seating enclave directly across South Village Promenade from the relocated walkway that will serve as the eastern terminus of the sightline formed by the Botanical Building lawn walkway.
- Provide seating across from the Casa del Prado Theater entry.
- Relocate existing queen palms.



3. Cafe Del Rey Moro Garden

Design Objective:

Preserve and rehabilitate the Cafe del Rey Moro Garden.

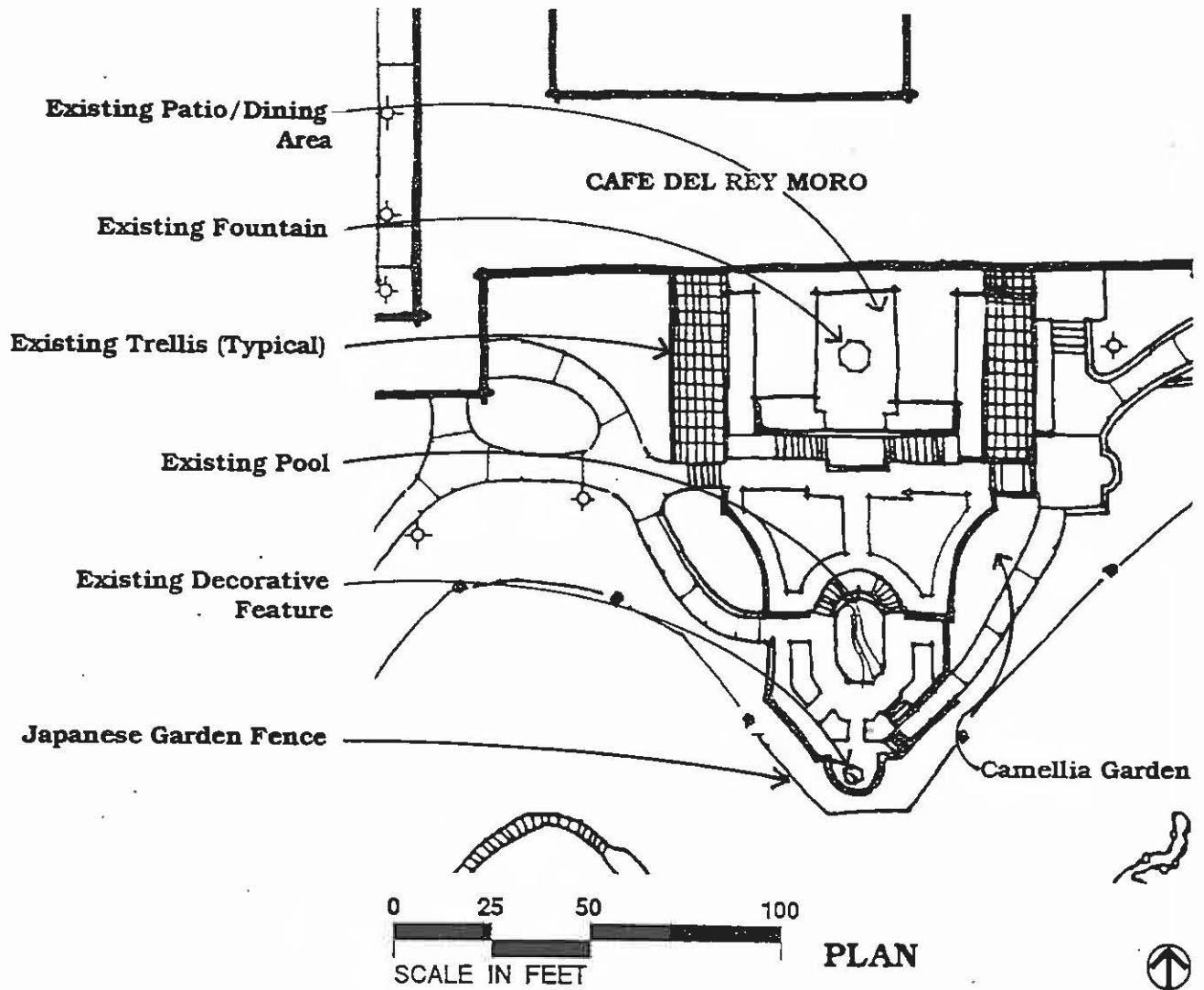

Recommendations:

- Repair and reconstruct landscape features such as fountains, balustrades, and paving materials where needed.
- Adhere closely to the original 1935 design when making any alterations to the garden.
- Rehabilitate the camellia garden as directed by the Park horticulturalist.



4. Botanical Building Gardens

Design Objective:

Restore historic features and detailing to the Botanical Building Gardens.

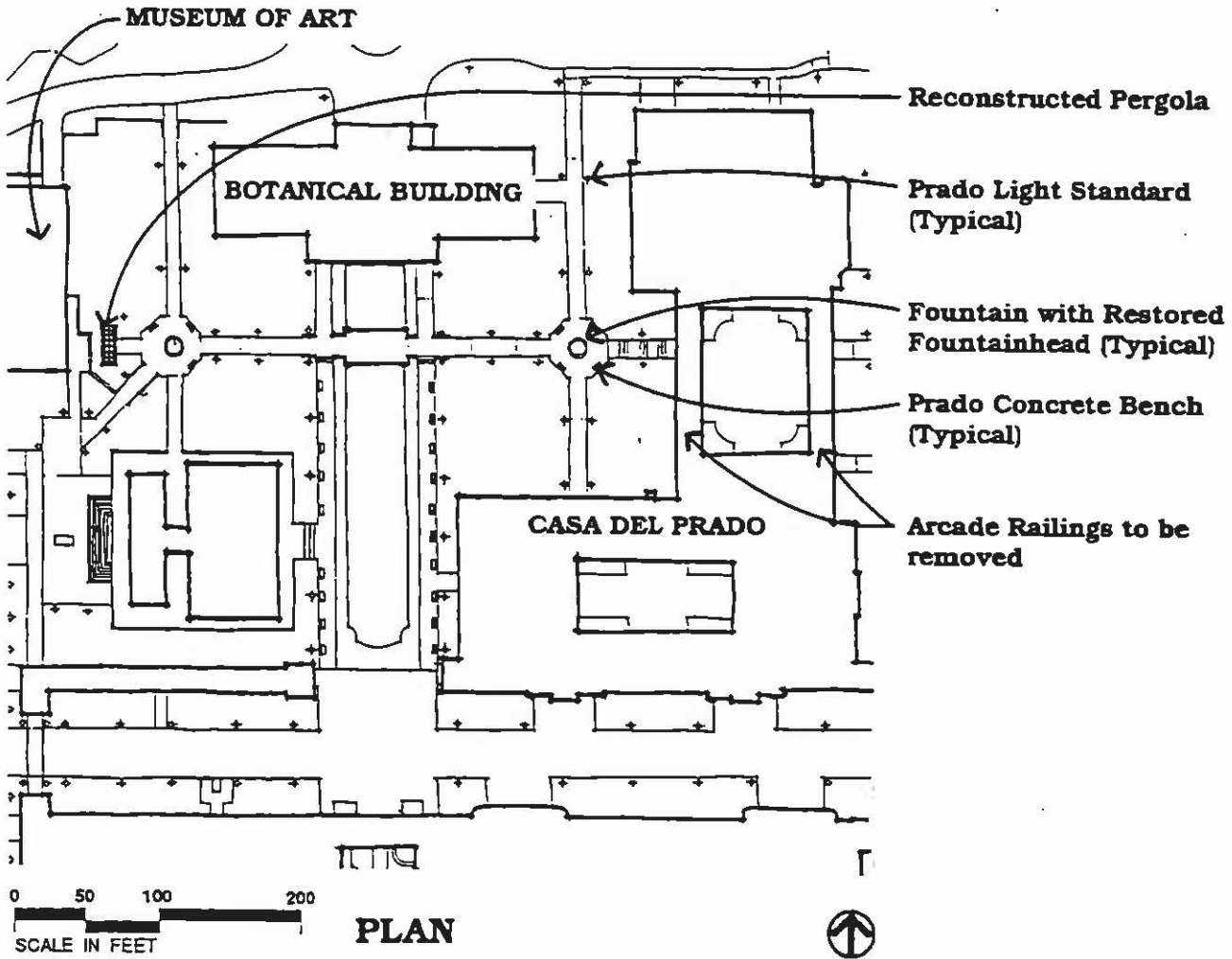



Recommendations:

- Reconstruct the pergola built in 1915 located at the west terminus of the main walkway.
- Refurbish the circular fountains and replace existing fountain heads with those of 1915 Exposition design.
- Remove iron railings between the arches of the Casa del Prado patio that will enable the circulation access and sightline of the east walkway to extend through to the Village Promenade.*

* proposed name for a new feature



The Botanical Gardens pergola in 1915.



5. Casa de Balboa Parking Area

Design Objective:

Regrade and reconfigure Casa de Balboa parking lot to improve surface drainage, provide improved delivery access for large trucks, and provide a pleasant Prado entry experience for the pedestrian.

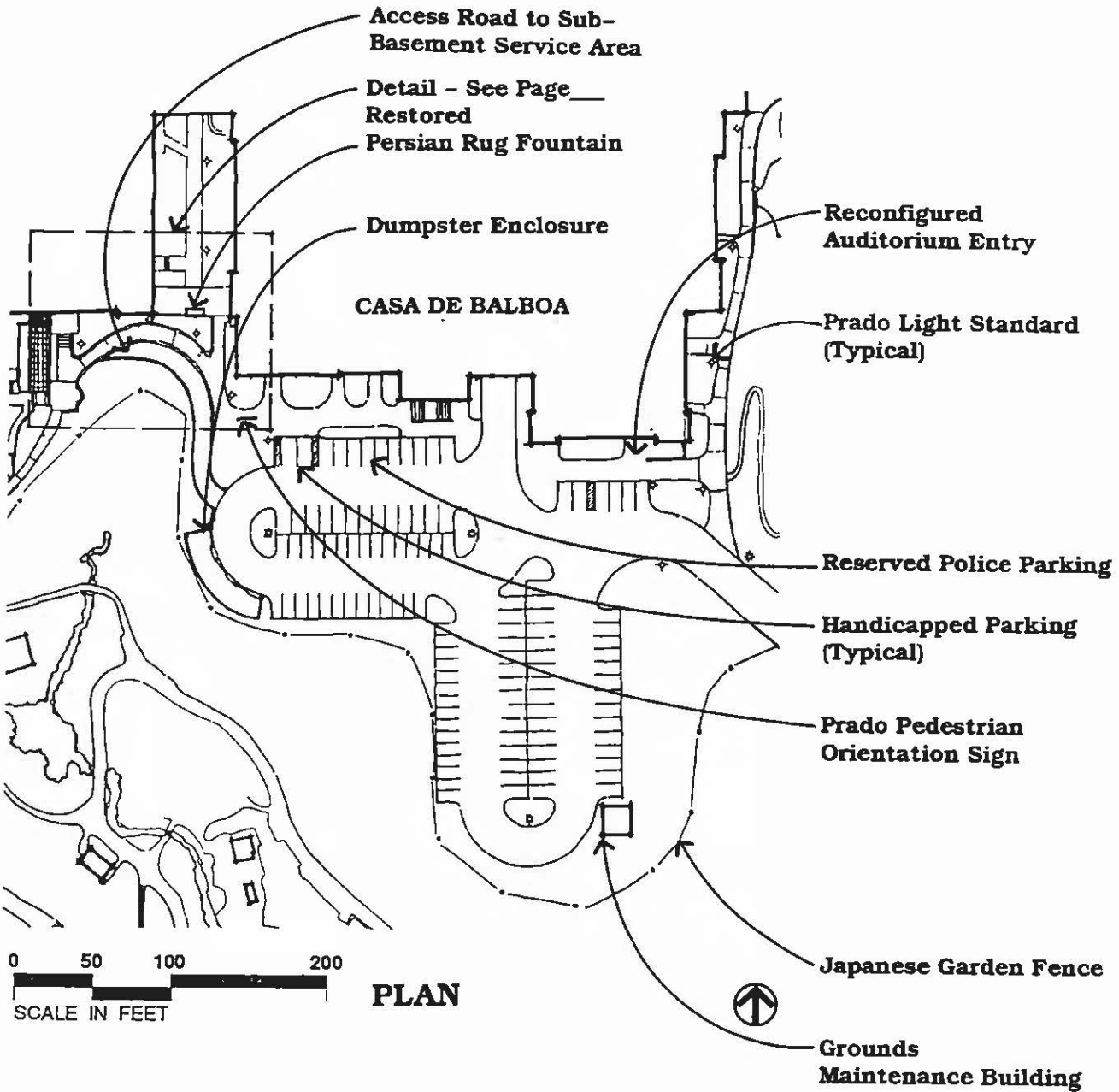



Recommendations:

- Lower the elevation of the parking lot so that surface drainage does not flow into the southeast corner of the Casa de Balboa.
- Reconfigure and restripe the Casa de Balboa lot.
- Construct enclosures for trash dumpsters that will harmonize with surrounding architecture and historical themes.
- Locate a new grounds maintenance building adjacent to the south portion of the lot.
- Relocate the Park mower shop off the Central Mesa as soon as space becomes available.
- Install new 15' wide pedestrian walkway and service access to the House of Hospitality using decorative concrete paving.
- Provide a drop-off area for service vehicles.
- Provide delivery truck access to a subbasement in the reconstructed House of Hospitality.
- Provide priority parking for three police vehicles.
- Restore and incorporate the existing Moorish "Persian Rug" fountain into the new walkway to the Prado. Install reproductions of historic urns in their original locations flanking the fountain.
- Reconfigure the pedestrian walkway east of Casa de Balboa to Zoro Garden according to the plan.

Parking Lot Tree:

Eucalyptus ficifolia - Red Flowering Gum

Eucalyptus degulpta - Mindanao Gum

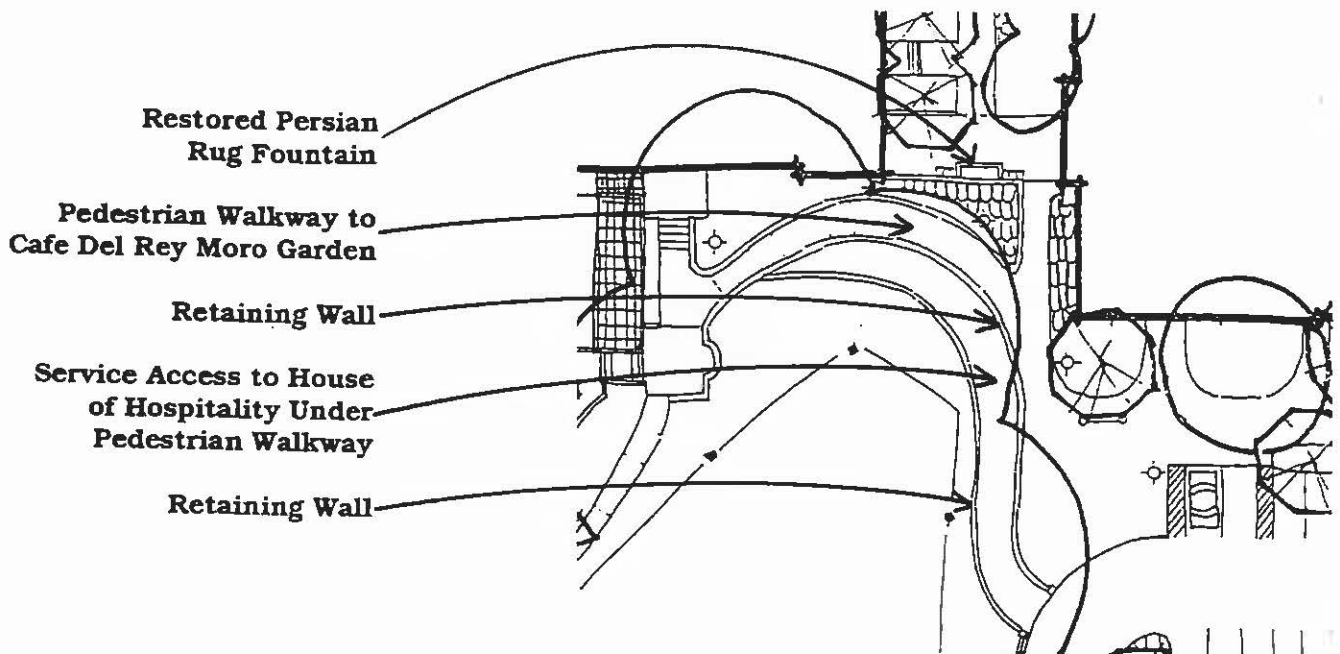



6. Zoro Garden

Design Objective:
Refurbish Zoro Garden.

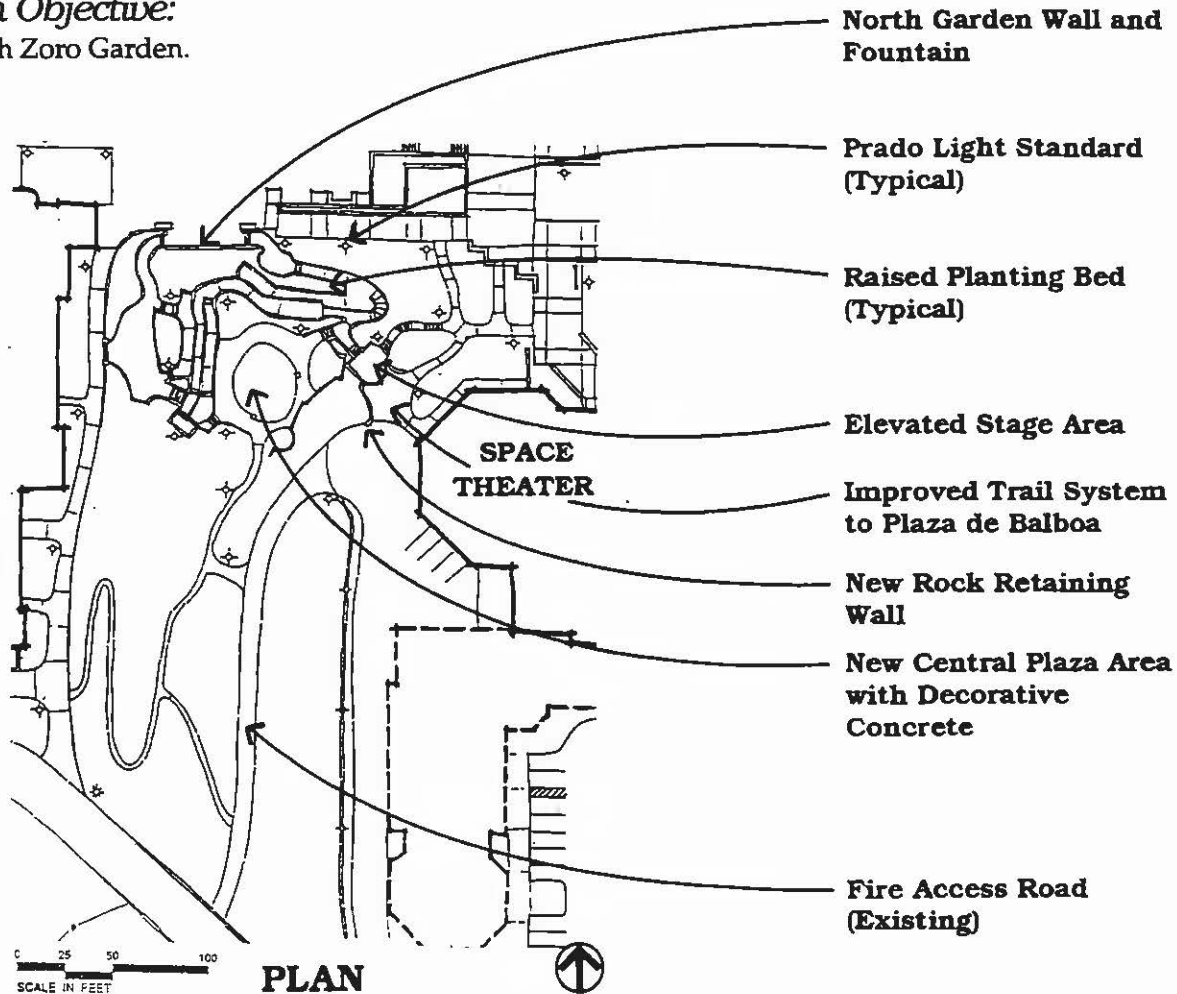

Recommendations:

- Pave the circular central plaza area with exposed aggregate concrete.
- Remove the grounds maintenance storage building and construct a rock retaining wall to provide an elevated stage area.
- Install new plant material throughout Zoro Garden as directed by the Park Horticulturalist.
- Construct a new pedestrian trail system with stairs that will link the Zoro Garden with Plaza de Balboa.
- Refurbish the north garden wall and fountain.
- Retain the fire access road from the Space Theater service area to the Japanese Garden fence.
- Add pole lighting as shown.



7. Space Theater Parking Lot

Design Objective:

Reconfigure the parking lot and provide pedestrian access to the Space Theater from Park Boulevard.

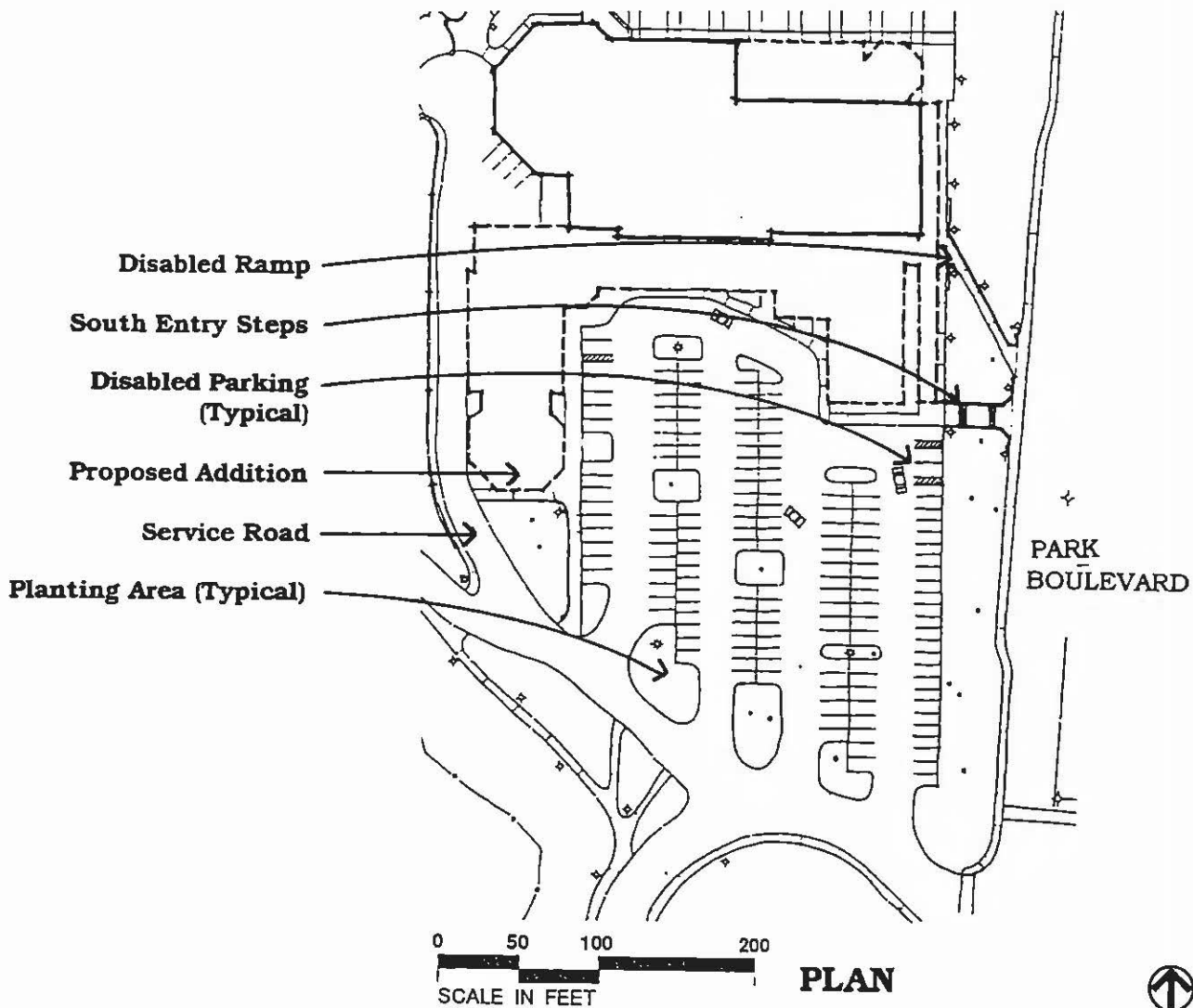

Recommendations:

- Reconfigure parking lot when required by proposed building expansion.
- Construct steps and ramp connecting the parking lot with Park Boulevard.
- Incorporate trees in this area such as the following:
Parking Lot Tree: Eucalyptus ficifolia - Red Flowering Gum



8. Plaza de Balboa

Design Objective:

Enhance Plaza de Balboa to serve the future needs of Park visitors.

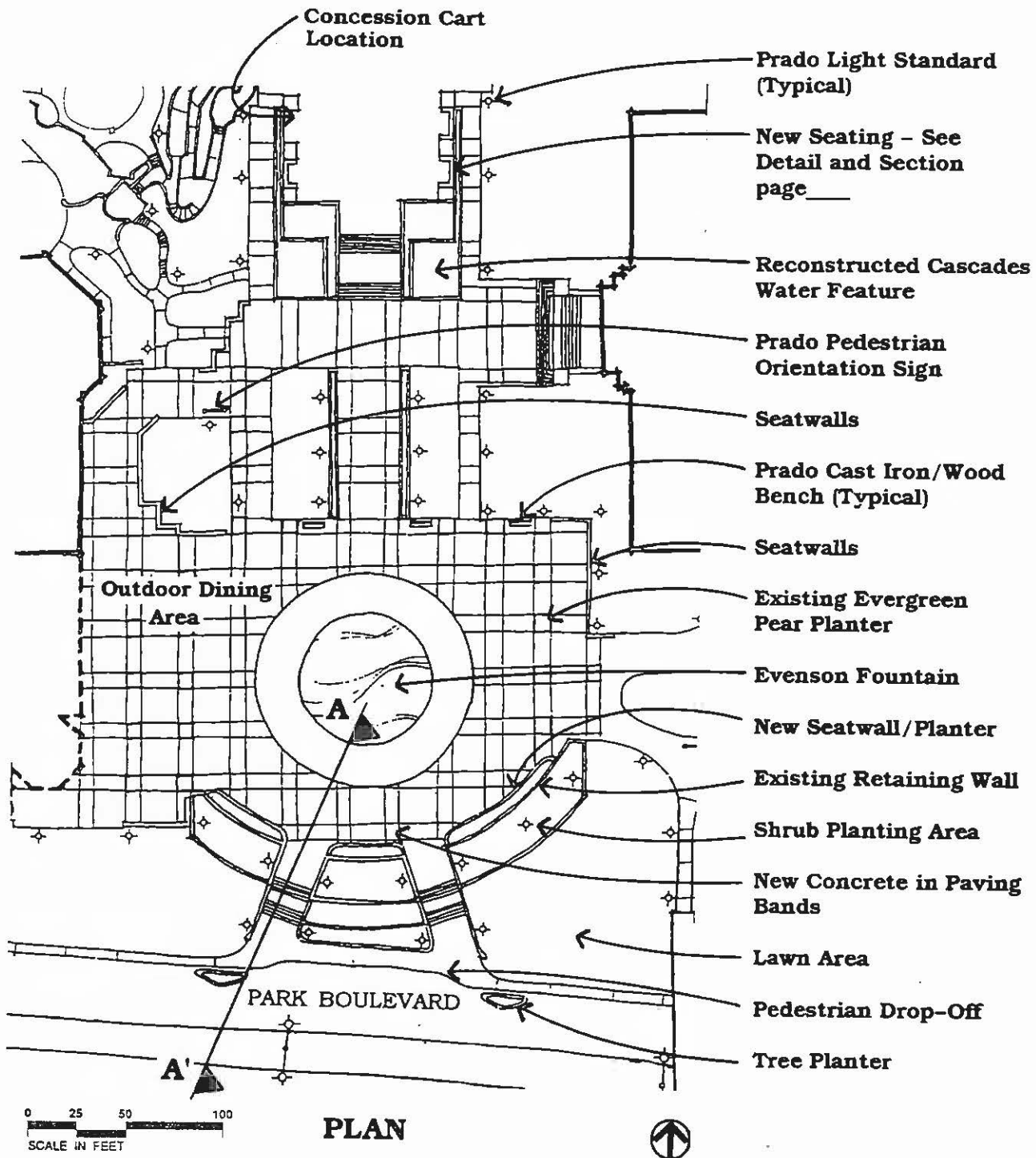



Recommendations:

- Create an east entry from Park Boulevard by providing dual stairways that will connect the Plaza with a pedestrian drop-off lane at Park Boulevard. Preserve the existing pump mechanism for the Evenson Fountain.
- Provide low seat walls in front of the existing raised planters on the east side of the Evenson fountain.
- Repair and refurbish the Cascades water feature.
- Redesign seating and planting areas in the southwestern portion of the plaza near the Space Theater.
- Provide movable tables and chairs for outdoor dining near the Space Theater's food service area.
- Replace decorative bands with textured colored concrete to complement surrounding architecture.

Plaza Tree: *Pyrus kawakamii* - Evergreen Pear

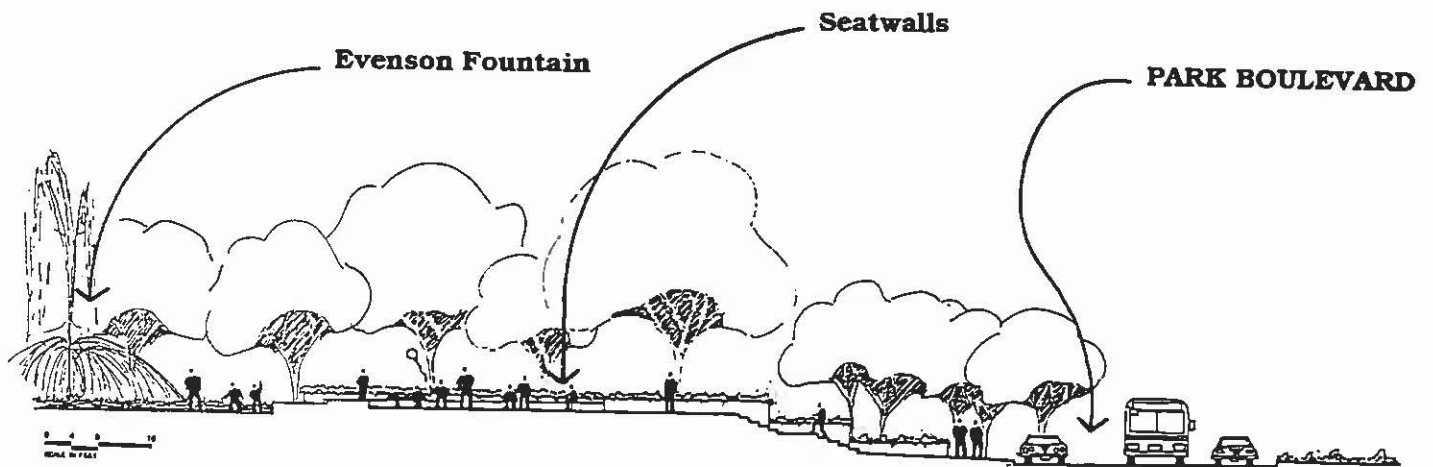

SECTION A-A'



9. Rose and Desert Gardens

Design Objective:

Construct the final phases of the rose garden, screen unsightly views and provide lighting and restroom facilities.

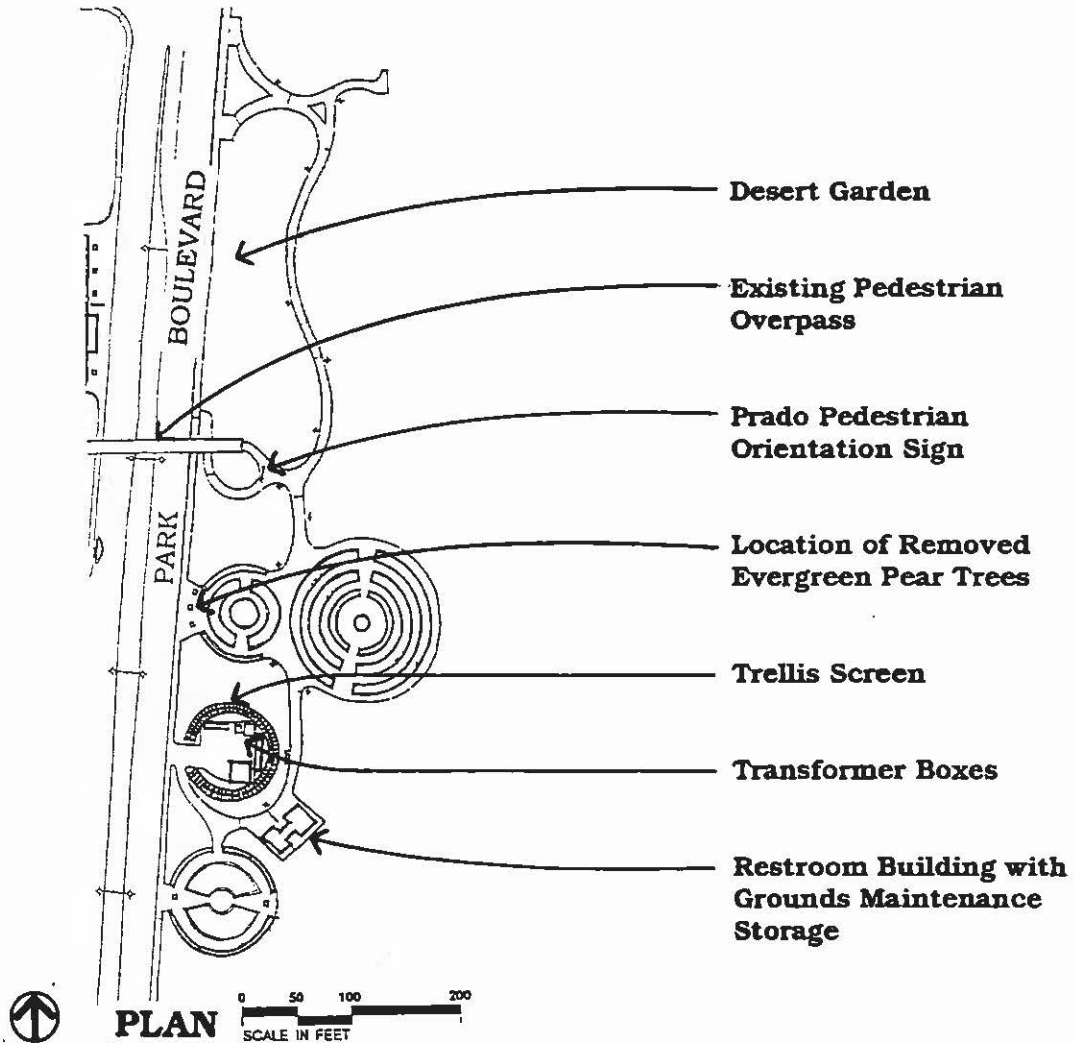

Recommendations:

- Complete construction of the existing phase 2 plan for the rose garden.
- Add Prado lighting as shown.
- Screen unsightly views of electrical transformer boxes with wooden screens and trellises in cooperation with SDG&E.
- Provide a freestanding restroom building that contains a maintenance storage room.
- Remove the existing Evergreen Pear trees that block distant views from Plaza de Balboa.
- Refurbish planting and interpretive signage in desert garden where needed.



10. Japanese Friendship Garden South Entry

Design Objective:

Provide a cul-de-sac at the entrance to the Gold Gulch parking lot.

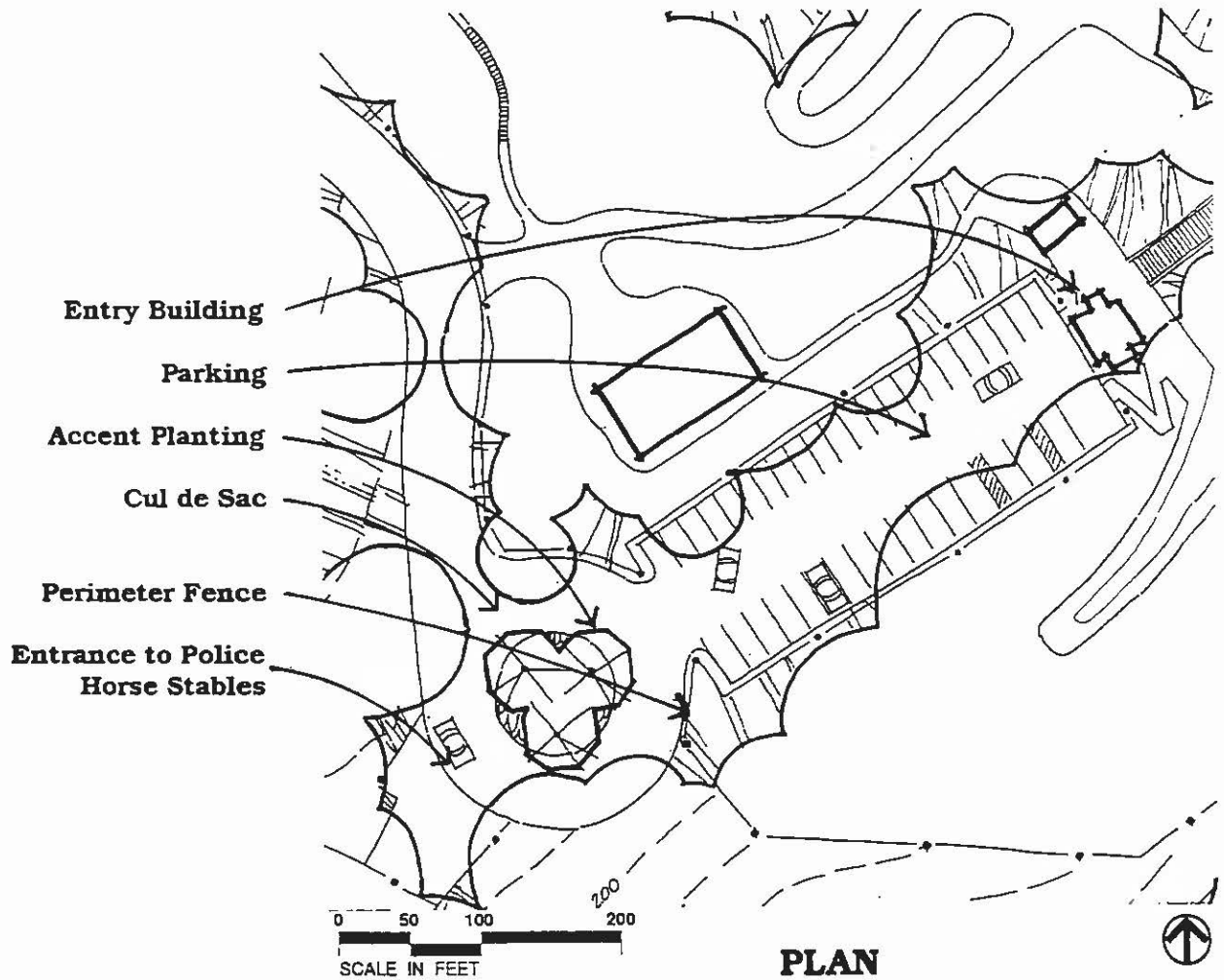

Recommendations:

- Design the cul-de-sac to accommodate semi trailer trucks for deliveries to the Japanese Friendship Garden and Police horse stables.
- Provide accent plantings in the center island that harmonize with the surrounding landscape.
- Design perimeter fencing that harmonizes with its surroundings and provides views into the Friendship Garden from surrounding pedestrian circulation areas. Standard galvanized chain link fences should not be used.



North Prado

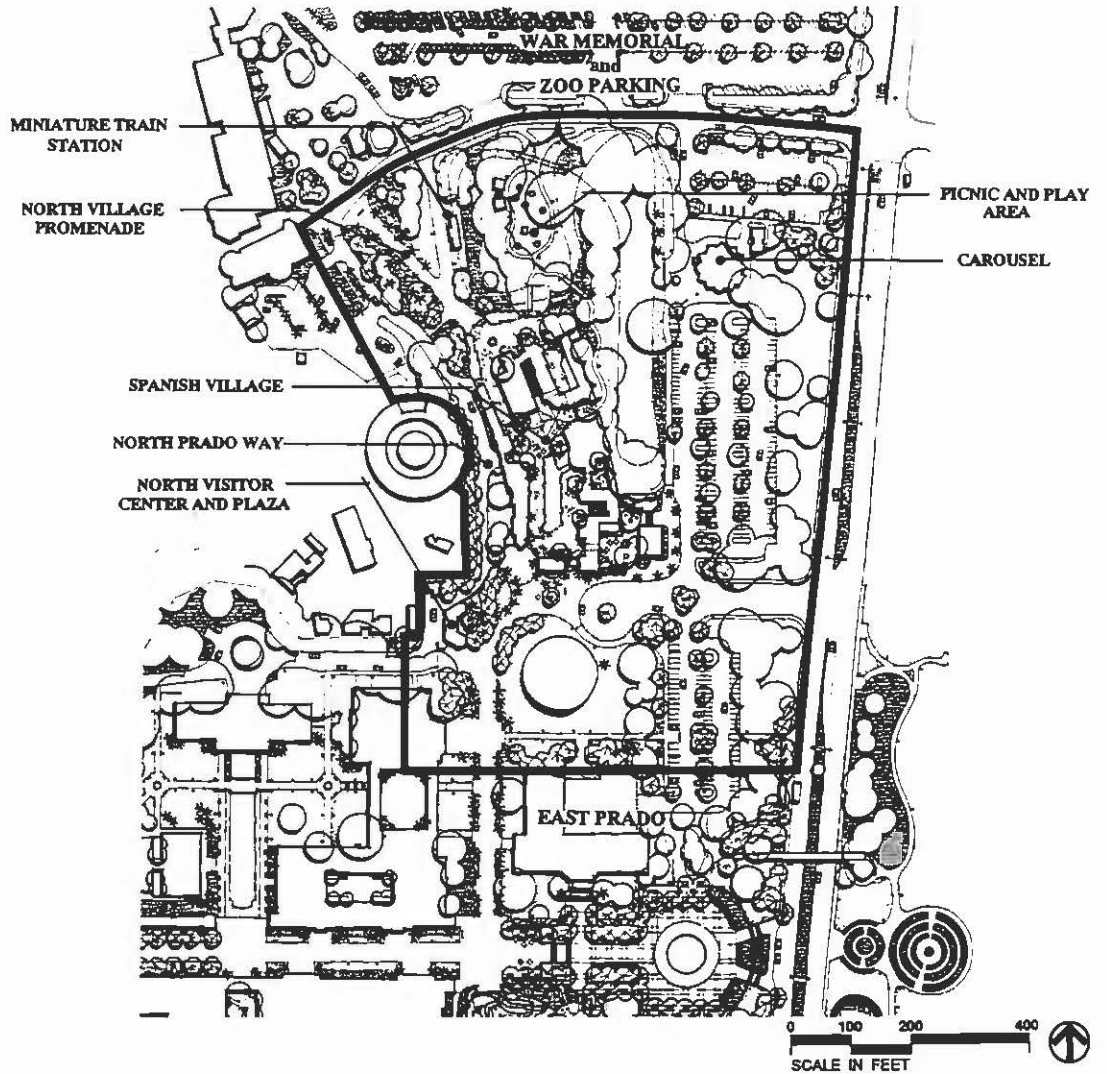

Site Amenities:

- Prado Light Standard: Western Lighting Standards Capistrano Series CA10 (or equal). Custom fixture as shown in Appendix. Color shall be Frazee Shutter Green 6125N gloss enamel.
- Prado Drinking Fountain: Western Lighting Standards Capistrano series mini base as shown in Appendix (or equal). Color to match light standards.



- Prado Cast Iron/Wood Bench: TimberForm Site Complements model numbers 2118-x and 2119-x (or equal) with cast iron supports and patterned wood slats. Bench depth is 2' - 2.5" and height is 2' - 9.5". Seat height is 1' - 5" with surface mounting and wood size 1.5" x 2.5". Length to be determined. Finish to be powder coating color RAL 6009. See Appendix.
- Plaza Chair: Wesnic Food Court Furniture, Bentwood III side chairs, with mesh seat and Fan Back, model #302 (or equal). See Appendix.
- Prado Plaza Table: Falcon Table Base model #2704-UH (or equal) with cast iron base, 18 ga. 4" steel tubing, rubber cushion glides, 15" cast iron spider, 24" diameter base spread, 27.5" overall height. 36" round marble table top available through distributor. California Umbrella with 1-1/4" diameter pole available through Sunstar Bistro. See Appendix.
- Prado Metal Trash Receptacles: Victor Stanley Ironsites Concourse Series, model #RS-12 (or equal). Color to match light standards. See Appendix.
- Spanish Village Trash Receptacle: SueMar Designs trash can containers. Round, hexagonal, and octagonal shapes, design and colors at discretion of artist, 18" chain with eye bolt and concrete anchor. See Appendix.
- Plant Container: Dura Art Stone cast stone 3' & 4' wide, design N Aquarian round planters, 30" & 36" height, nordic cream color with light sand blast finish and 2" centered drain holes. See Appendix. Order numbers:
 - S-4-N-36-S-13-LSB-2" centered (or equal)
 - S-4-N-30-S-13-LSB-2" centered (or equal)
 - S-3-N-30-S-13-LSB-2" centered (or equal)
- Prado Tree Grates: Urban Accessories, cast iron tree grate model "O.T." series (or equal). Round or square shape and size to be determined. See Appendix.

Signage:

- Prado Pedestrian Orientation Sign Standards: Western Lighting Standards Mini Capistrano series as shown in Appendix (or equal). Color shall be Frazee Shutter Green 6125N gloss enamel or equal.



1. Village Promenade / Park Boulevard Pedestrian Link

Design Objective:

Emphasize the entry experience to the North Prado for the pedestrian arriving on public transportation from Park Boulevard.

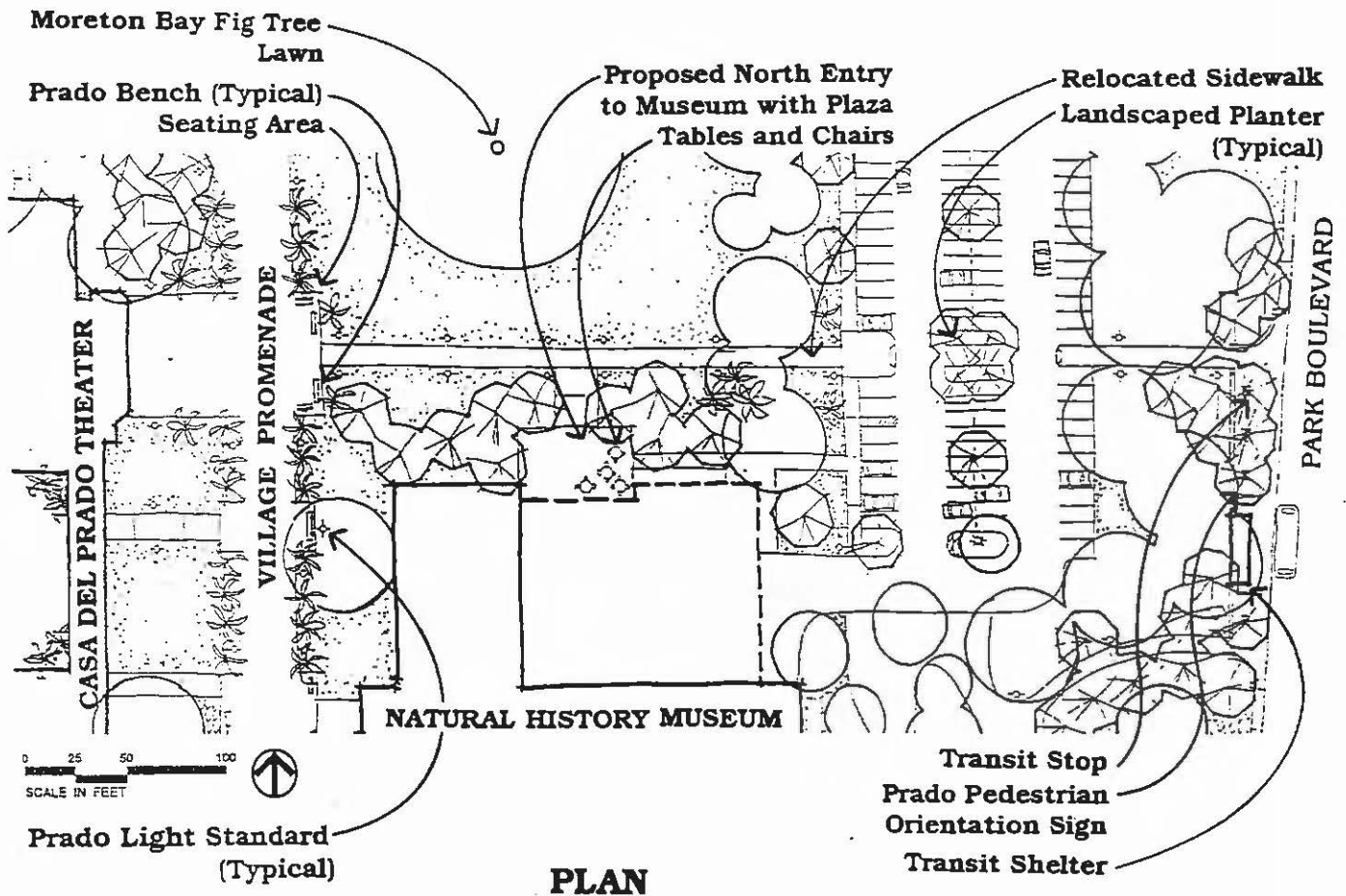

PLAN

Recommendations:

- Replace the existing sidewalk from the Natural History Museum parking lot to the Casa de Balboa Theater with a new walkway on axis with the entry to the Theater. This walkway will connect the Theater entry plaza with the transit stop on Park Boulevard.
- Construct the walk of type C concrete. The color should complement surrounding architecture.
- Extend the concrete paving through the Natural History Museum parking lot and flank the walkway with landscaped planters when it intersects parking rows.
- Include a seating area across from the Casa del Prado Theater as shown on plan.



2. Natural History Museum Parking Lot

Design Objective:

Add disabled parking, a pedestrian walkway and trees to the parking lot.

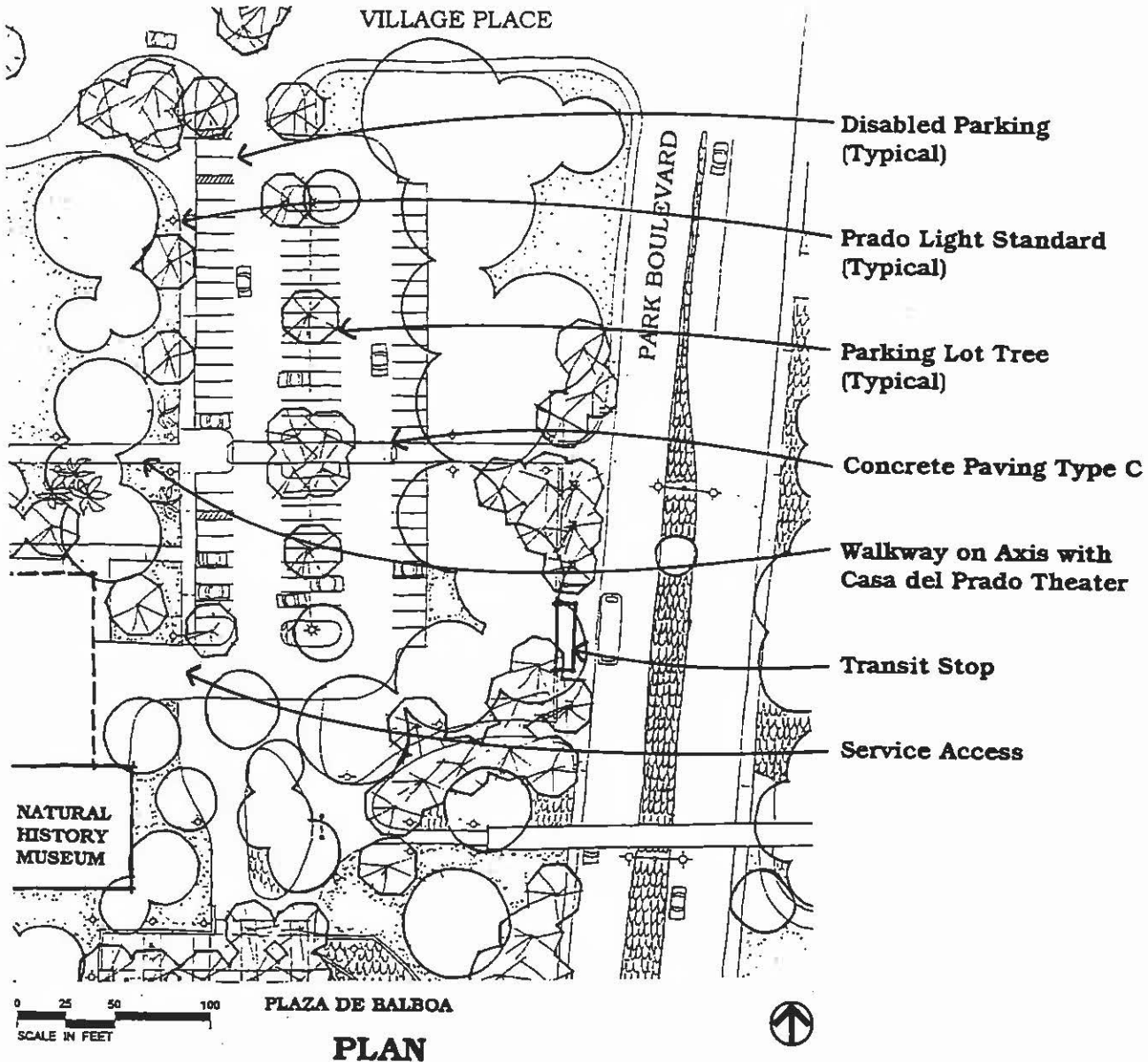

Recommendations:

- Add planting that harmonizes with surrounding existing vegetation.
- Incorporate trees in this area such as the following:
Parking lot tree: Podocarpus gracilior - Fern Pine



3. Spanish Village South Entry Plaza*

Design Objective:

Because of its significant location, this plaza presents an opportunity to create a festive gathering place at a major crossroads area of the Park. It will include a major visitor service center and provide a vital link between Spanish Village and the Prado. It will be a visual focal point from the Prado and the Village Place cul-de-sac.

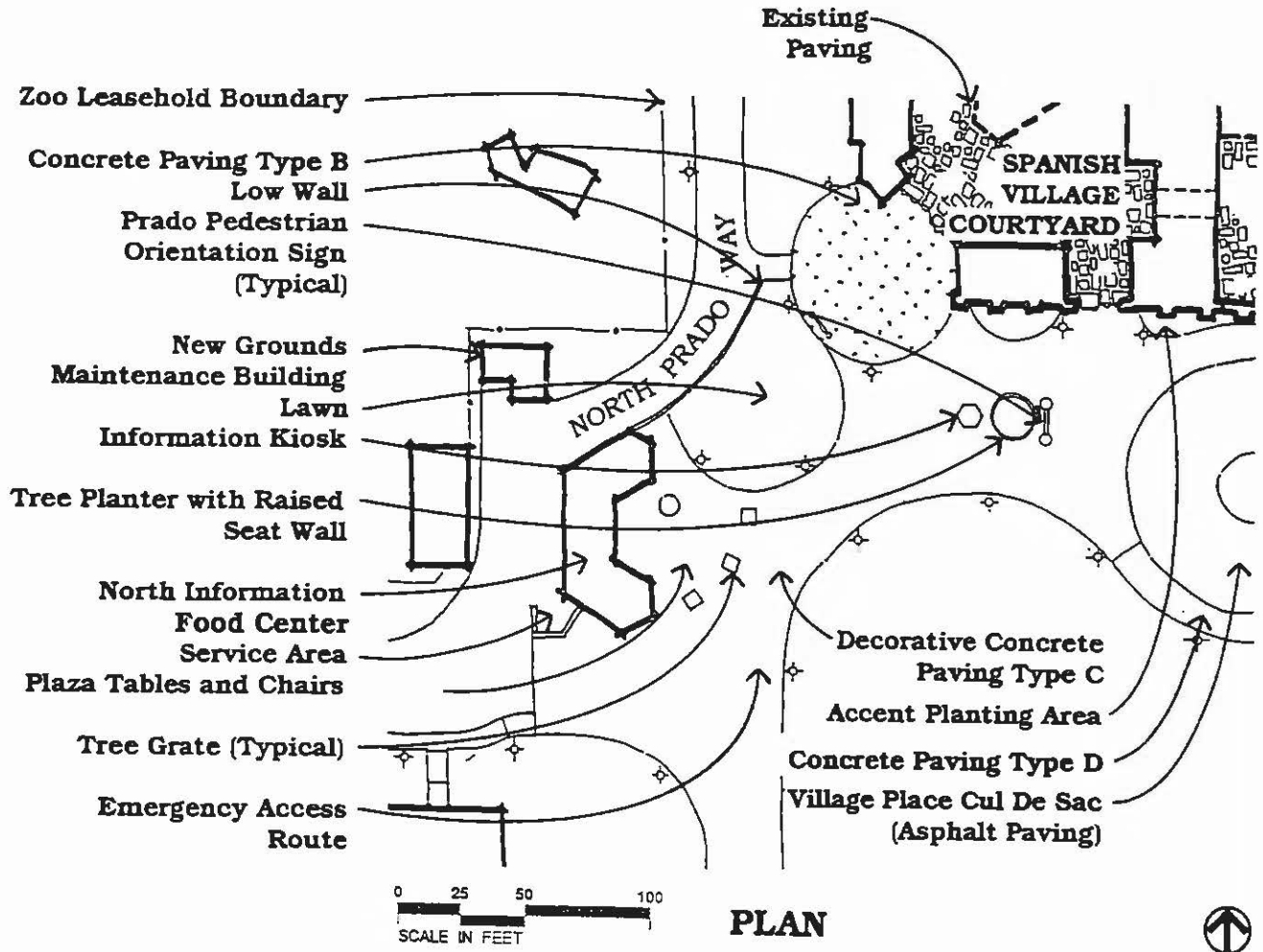

Recommendations:

- Provide an outdoor dining area with plaza tables and chairs. Include accent trees in grates.
- Increase the lawn area on the northwest side of the Moreton Bay Fig.
- Replace the existing chain link fence with one of decorative wrought iron.
- Create an additional lawn area near the visitor center. Include a three foot high wall to serve as a visual barrier between the plaza and North Prado Way. Provide palms and theme trees.

* proposed name for a new feature



BALBOA PARK · CENTRAL MESA PRECISE PLAN

Precise Plan - Specific Recommendations

- Create new accent planting areas adjacent to the south wall of Spanish Village.
- Incorporate a circular shaped paving treatment near the southwest entry to Spanish Village that subtly contrasts with the rest of the plaza paving as shown on the plan.
- Allow room for vehicular service and emergency fire access from the Village Place cul-de-sac as a part of the plaza design.
- Provide a raised seatwall underneath a proposed shade tree adjacent to the cul-de-sac.

Accent Tree: Jacaranda mimosifolia - Jacaranda
 Theme Tree: Alectryon excelsum - N.C.N.
 Palm Tree: Washingtonia filifera - California Fan Palm
 Shade Tree: Erythrina 'Sykesii' - 'Sykes' Coral Tree

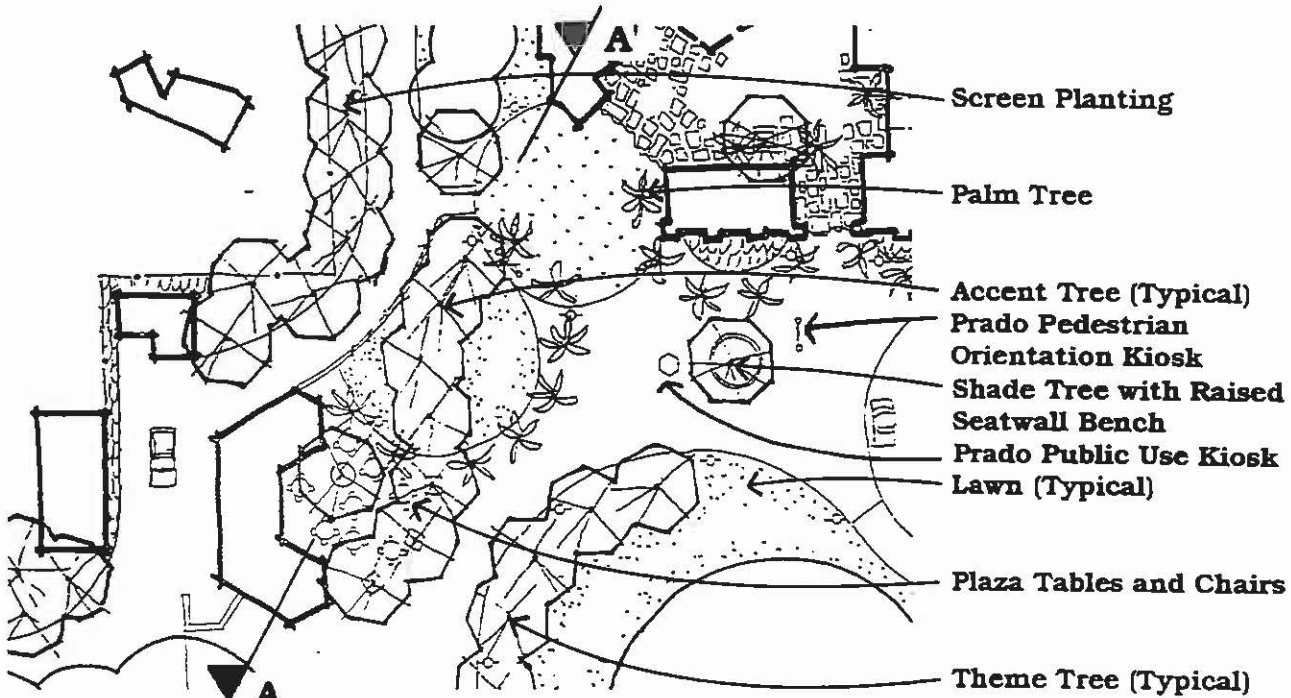

PLANTING CONCEPT PLAN



SPANISH VILLAGE

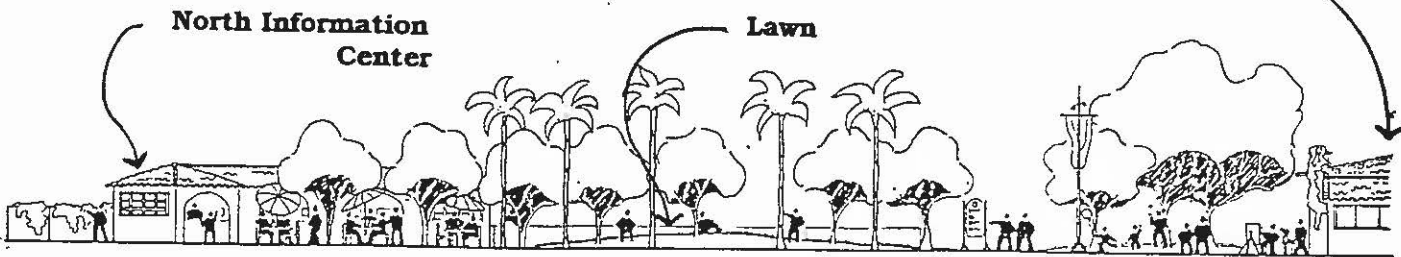

SECTION A-A'



4. Spanish Village

Design Objective:

Renovate the central courtyard of Spanish Village as an integral part of its rehabilitation and expansion.

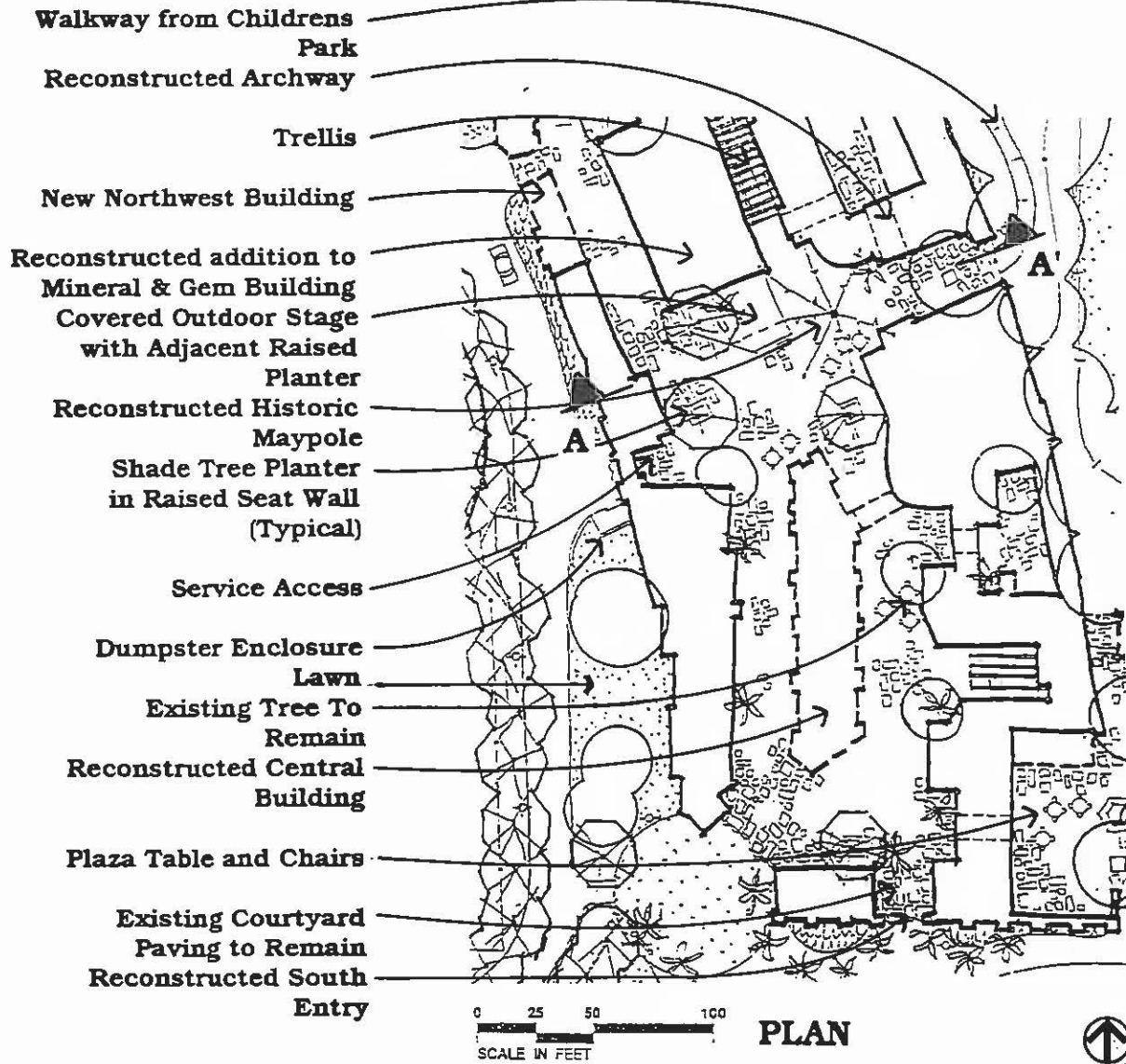

Recommendations:

- Reconstruct the central building that was built for the 1935 Exposition. (See Building Recommendations Section.)
- Reconstruct the north west building that was built for the 1935 Exposition.
- Provide a large open courtyard north of the reconstructed central building incorporating the lighted "maypole" that existed during Exposition.



- Construct a covered outdoor stage on the south elevation of the Mineral and Gem Building. The stage cover will be an extension of the building roofline. Modify the non-historic building addition. (See Building Recommendations Section).
- Reconstruct arches as shown on plan as in 1935.
- Reconstruct south entry as in 1935.
- Retain the existing broken concrete courtyard paving material. Encourage village artists to individualize their areas of the courtyard by continuing to paint the paving surface outside their studio doors.
- Design generous seating for pedestrians. Incorporate seating in courtyard planter walls. Most seating will consist of movable chairs with tables and umbrellas.
- Utilize planting to provide shade and soften architectural surfaces. Vines can be trained on walls and trellises. Trees can be located in courtyard planters.

Shade Tree: Jacaranda mimosifolia - Jacaranda

Accent Tree: Strelitzia nicolai - Giant Bird of Paradise

Palm Tree: Archontophoenix cunninghamiana - King Palm

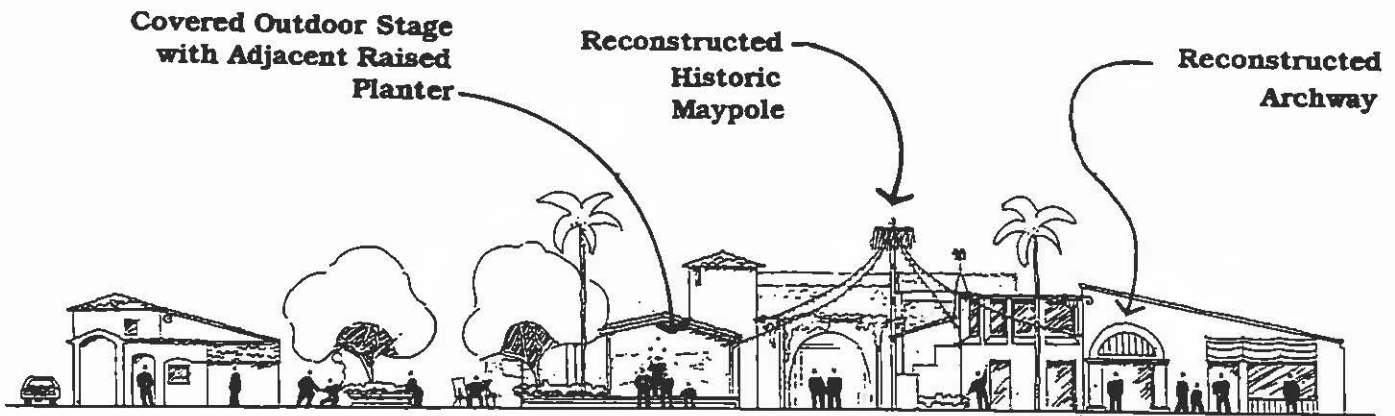

SECTION A-A'



5. Spanish Village East Entry*

Design Objective:

Create a southeast entry to Spanish Village to increase visibility and pedestrian circulation through the Village.

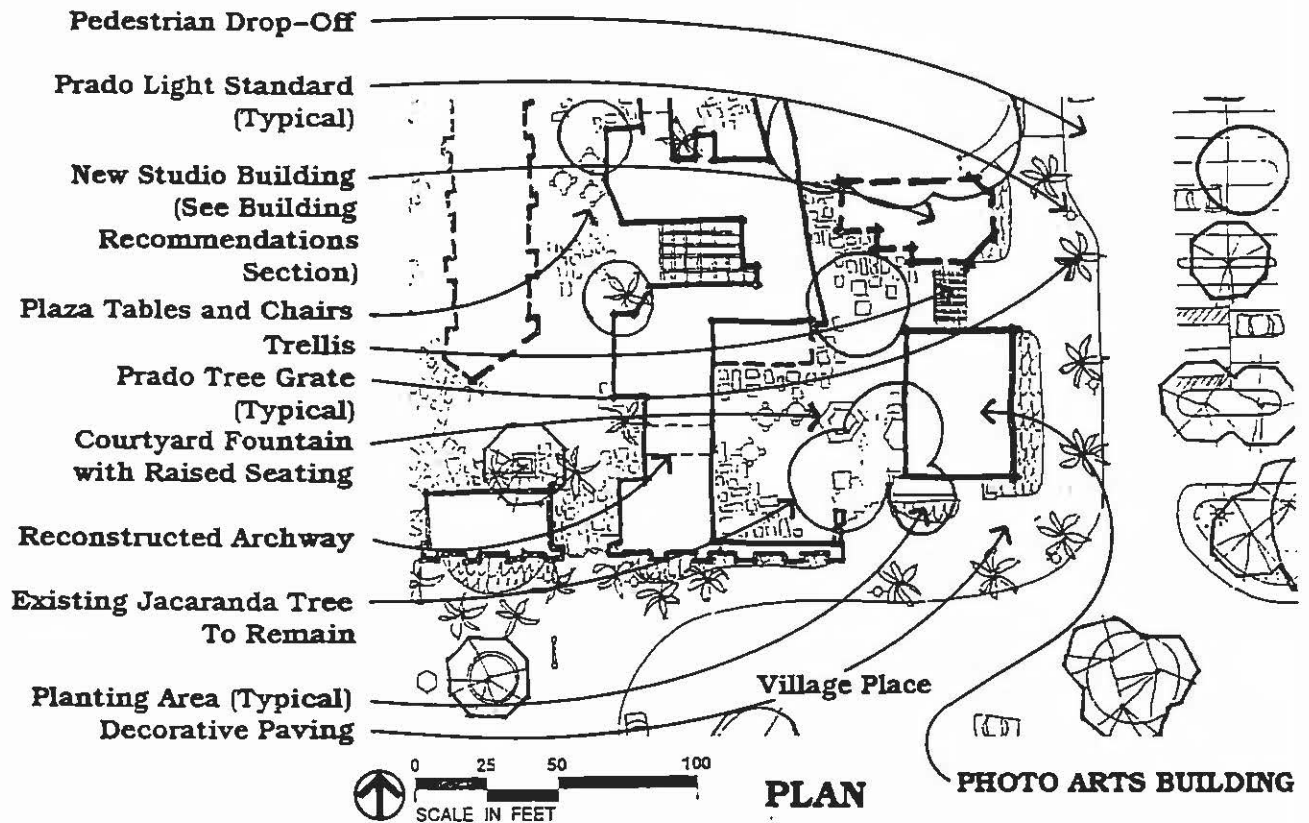

Recommendations:

- Expand the Spanish Village studios to define the plaza space as shown on the plan. (See Building Recommendations Section).
- Integrate the entry courtyard with the photo arts building with complementary paving, low seat walls, and planting.
- Include a small fountain that is compatible with village architecture.
- Incorporate accent paving and planting adjacent to Village Place to make an entry statement for pedestrians and those arriving in autos from Park Boulevard as shown on the plan.
- Retain the existing Jacaranda tree adjacent to the Photo Arts Building.
- Provide vine covered trellises to shade hot east facing walls.

Palm Tree in sidewalk grates:

Washingtonia filifera - California

* proposed name for a new feature



6. Spanish Village North Entry*

Design Objective:

Create a northern entry plaza at Spanish Village that will be visible to pedestrians from the Zoo exit area.

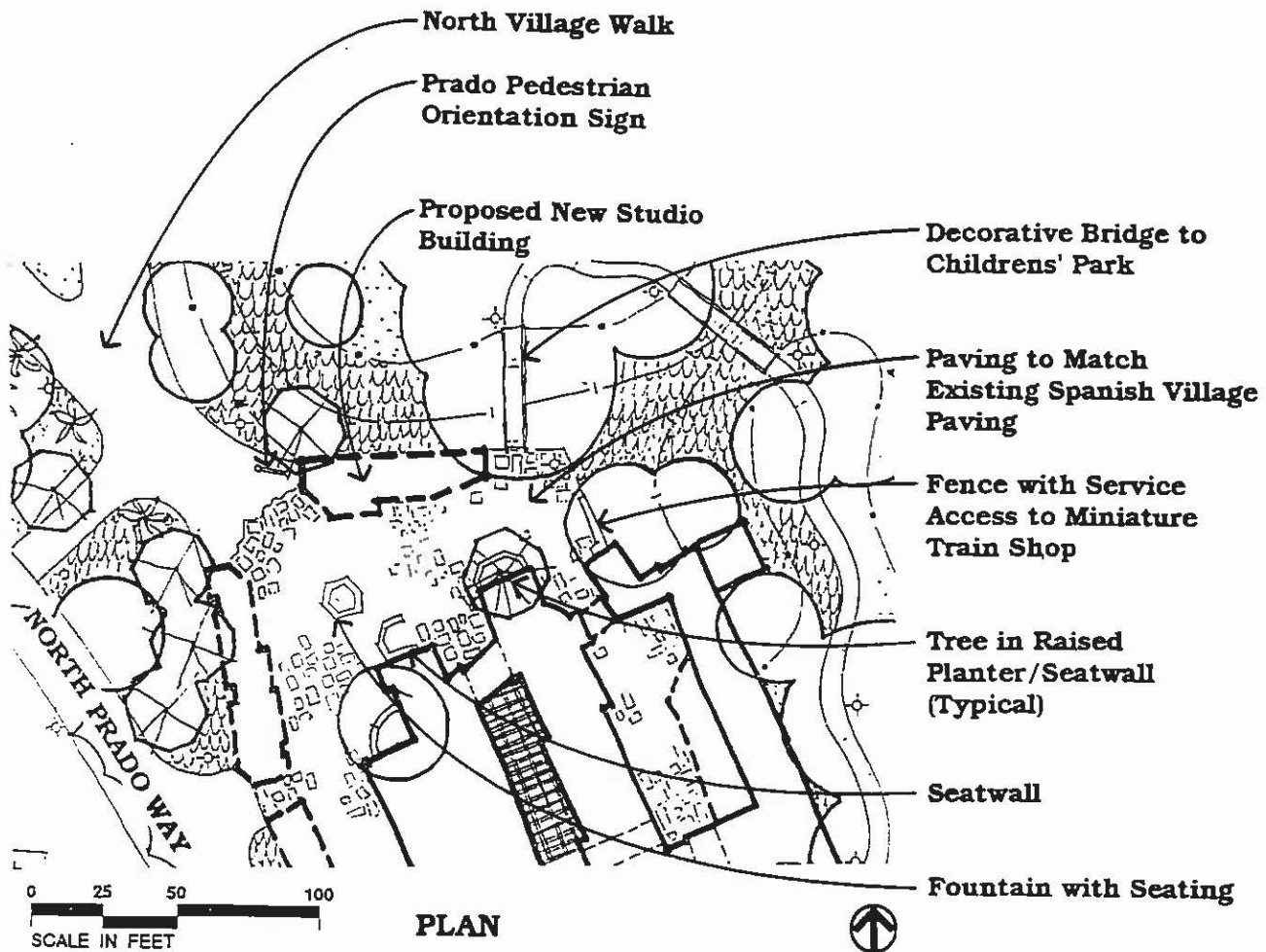

Recommendations:

- Incorporate a central water fountain that is compatible with Village architecture to serve as a visual focal point.
- Integrate pedestrian seating into planter walls.
- Continue the existing Spanish Village courtyard paving into the entire plaza.
- Provide trees, vines and accent plants to provide shade and harmonize with adjacent planting themes in Spanish Village.
- Construct two new studio buildings. (See Building Recommendations Section).

* proposed name for a new feature



7. North Village Promenade*

Design Objective:

Provide a direct circulation route and sightline from the Zoo exit to Spanish Village.

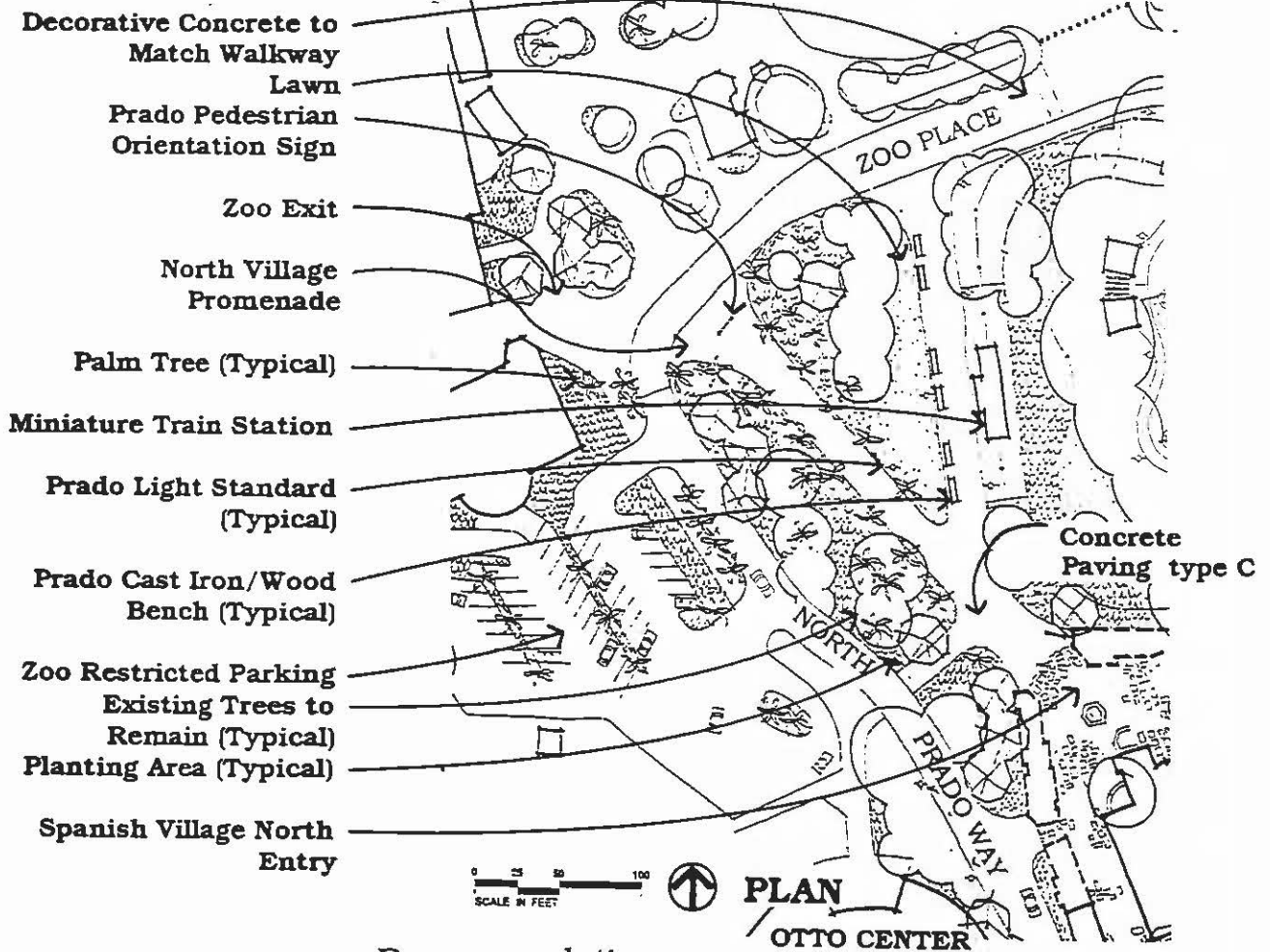

Recommendations:

- Reconfigure the existing walkway system and landscape as shown in the plan.
 - Utilize type C decorative concrete as a paving material.
 - Remove the asphalt paving on Zoo Place at the pedestrian crossing points shown on the plan and replace it with decorative concrete to match the new walkway.
 - Remove a portion of the axial walkway to the Otto Center to reinforce the Spanish Village circulation axis.
 - Remove the existing sidewalk west of Spanish Village.
- Theme Tree: *Bischofia javanica* - Toog tree
 Accent Tree: *Erythrina 'Sykesii'* - Sykes' Coral Tree
 Palm Tree: *Livistona decipiens* - Ribbon Fan Palm

* proposed name for a new feature



8. North Prado Way*

Design Objective:

Provide service and fire access to Old Globe Way and a drop-off area to Casa del Prado.

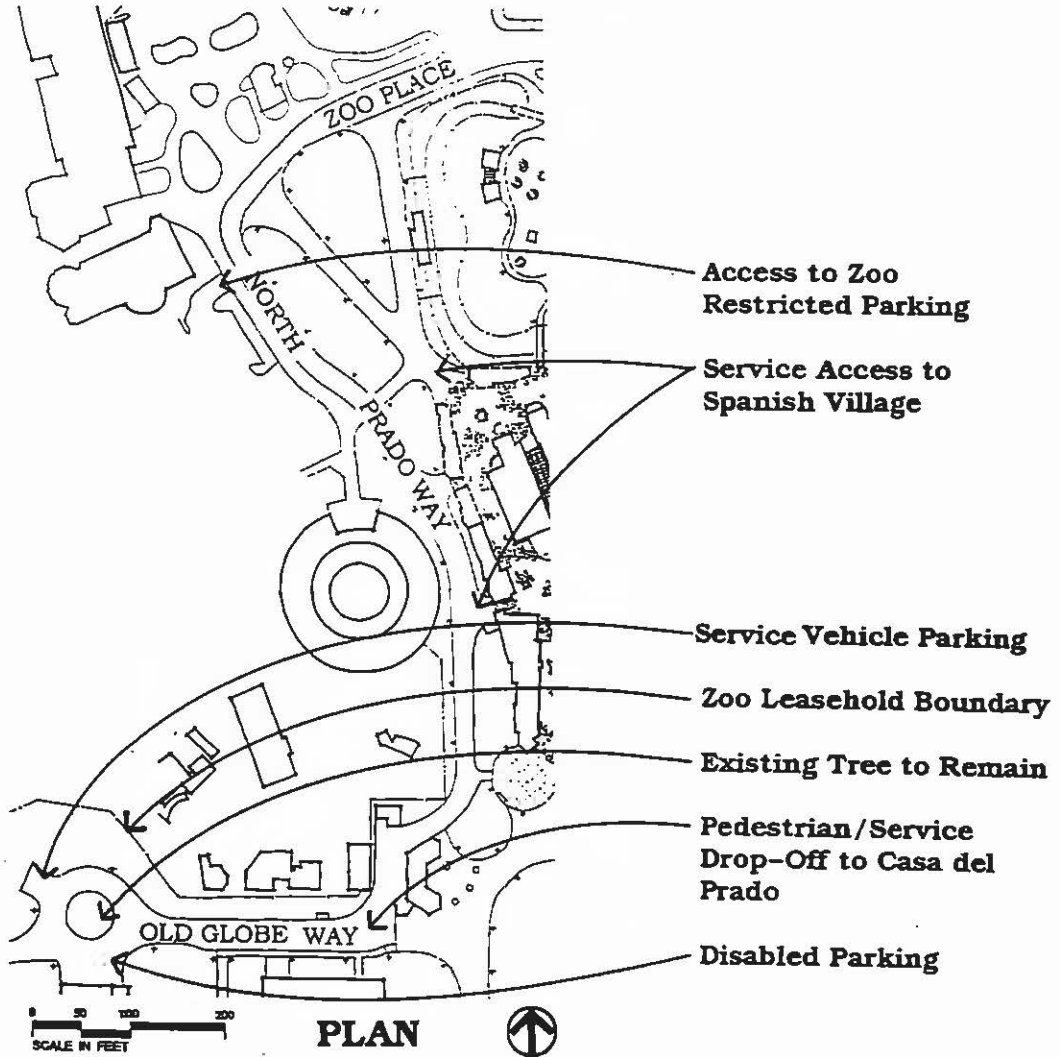

Recommendations:

- Connect Zoo Place with Old Globe Way by a 26' wide roadway.
- Incorporate a cul-de-sac with adjacent service parking behind the Botanical Building as shown on plan. Preserve the existing Ficus sycamorus tree in the center planting area of the cul-de-sac.
- Maintain disabled parking behind the Botanical Building.
- Provide a drop-off lane on the north side of the Casa del Prado Theater.
- Provide a drop-off lane at the Spanish Village west entry.

* proposed name for a new feature



9. Miniature Train/Children's Park*

Design Objective:

Improve public access and amenities around and within the miniature train and to create the Children's Park playground area.

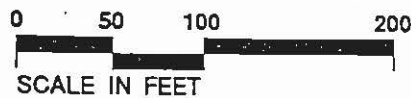
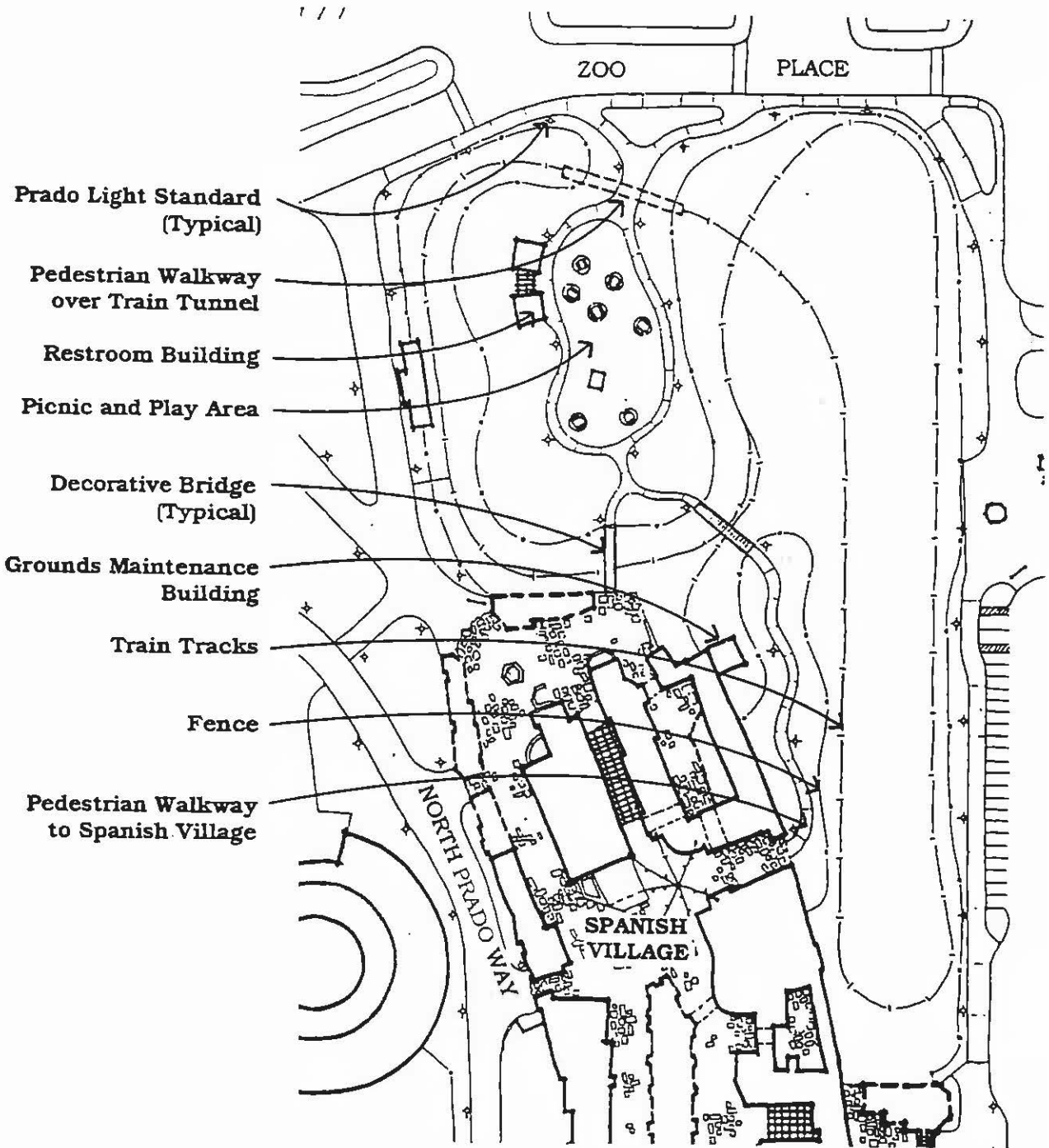

PLAN





Recommendations:

- Create public access to a new picnic and play area (Children's Park) within the miniature train area by means of a new pedestrian walkway covering the miniature train tunnel. Include children's play equipment in the landscape.
- Relocate the existing electrical transformer box to a non-public portion of the miniature train area.
- Provide additional access by means of decorative arched bridges spanning the train tracks and linking the picnic area to the carousel and Spanish Village as shown on the plan.
- Replace the existing chain link fence around the miniature train area with decorative fencing and realign it to allow for public access according to the plan.
- Relocate the existing underground gas storage tank for the miniature train to a location near Zoo Place that can be readily accessed by a large delivery truck.
- Construct a grounds maintenance building in the vicinity of the train storage building.

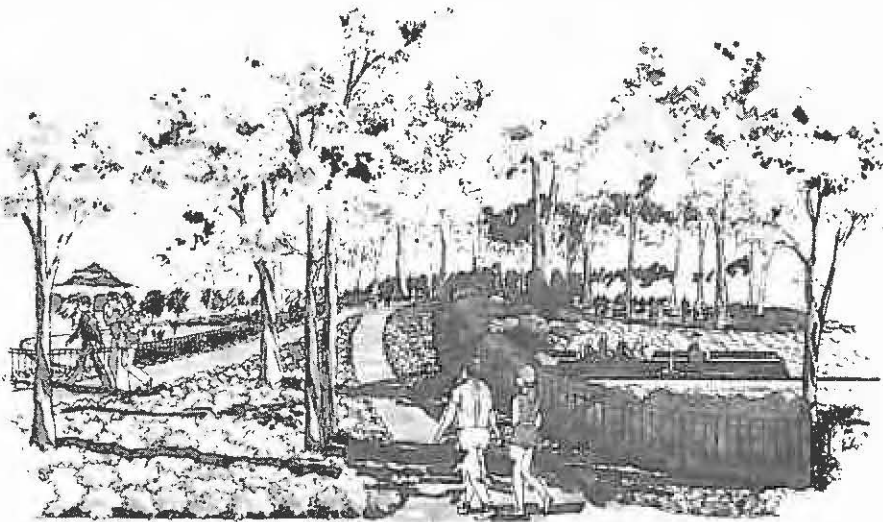

Entry to Children's Park from Zoo Place.



10. Carousel and South Carousel Parking Lot

Design Objective:

Reconfigure the parking lot to improve circulation and provide a pedestrian drop-off lane near the East Entry to Spanish Village.

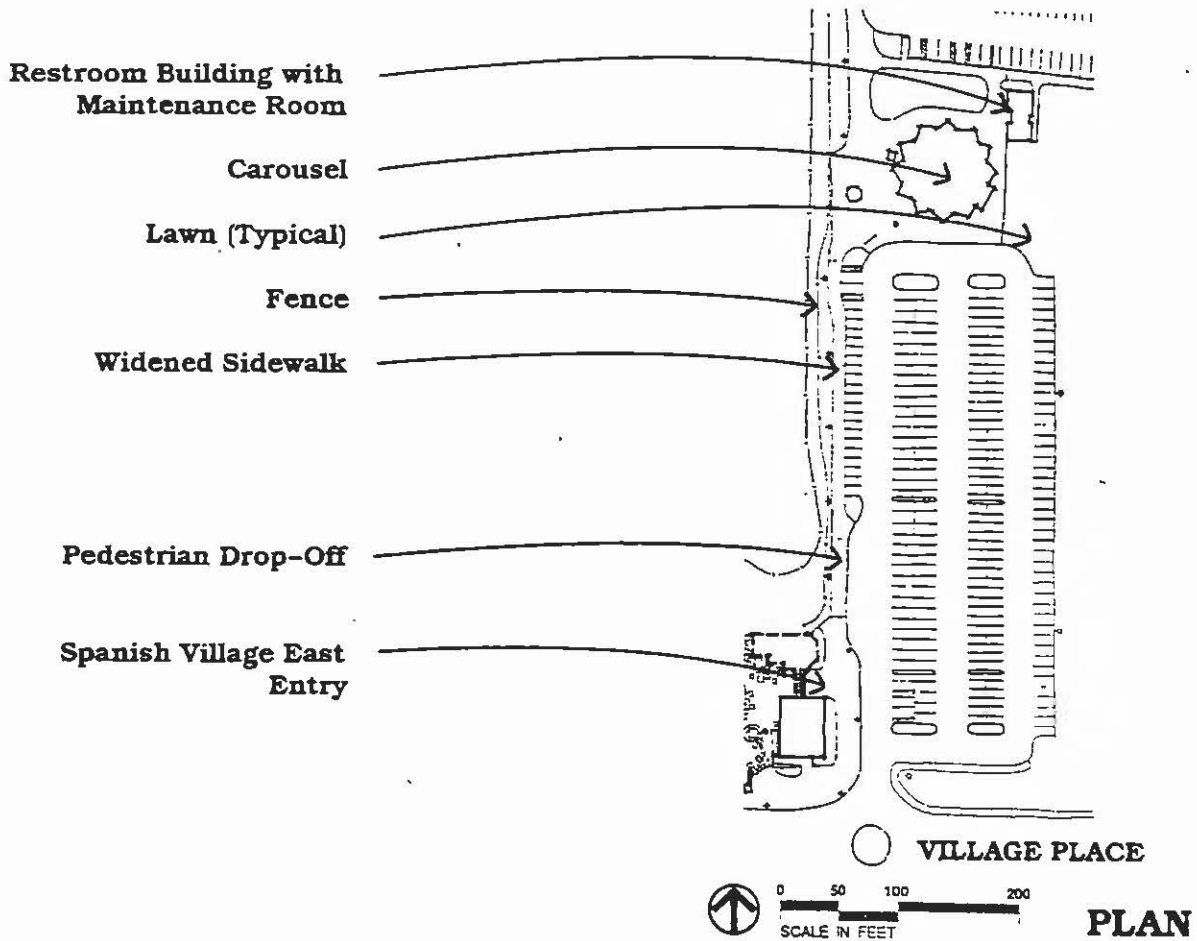

Recommendations:

- Widen the sidewalk that connects the east entry to Spanish Village and the Carousel as shown in the plan.
- Construct a new freestanding restroom facility near the carousel. Include a maintenance storage room.
- Alter the existing parking configuration to the pattern shown on the plan.
- Provide a drop-off lane as shown on the plan.
- Plant additional trees to conform to the City landscape ordinance.
Parking Lot Trees: *Brachychiton acerfolius* - Australian Flame Tree